



Stockwell Close | Billericay | £425,000



Stockwell Close

Billericay | Essex | CM11 2QA

Located in a sought after cul-de-sac location is this deceptively spacious three bedroom semi-detached family home that must be viewed internally to fully appreciate the size and space on offer.

On entering the property you are greeted by a light and bright hallway opening up to extensive accommodation to the ground floor, which provides good sized living space and makes it a great house for entertaining. The fitted kitchen has a range of fitted units, complimentary work tops and matching tiled splash. In addition the kitchen has the added advantage of dual aspect windows providing lots of natural light throughout.

On the first floor there are three good size bedrooms, two of which are doubles and a re-fitted modern bathroom suite with remote control shower. Outside the property there is off road parking to the front for two vehicles which is in addition to the shared driveway to the side leading to a detached garage.

Viewing is strictly through The Property Specialists on 0 1 2 7 7 6 5 4 4 4





- Semi Detached House
- Entrance Hall With Wood Style Flooring
- Living Room 4.53m x 3.40m (14' 10" x 11' 2")
- Sitting Room / Play Room 2.76m x 2.76m (9' 1" x 9' 1")
- Dining Room 2.75m x 2.76m (9' x 9' 1")
- Fitted Kitchen 2.56m x 2.70m (8' 5" x 8' 10")
- Three Bedrooms In Total
- Bedroom One 3.55m x 3.16m (11' 8" x 10' 4")
- Bedroom Two 3.64m x 2.97m (11' 11" x 9' 9")
- Bedroom Three 2.21m x 1.87m (7' 3" x 6' 2")
- Driveway And Garage
- Family Bathroom With Three Piece Suite
- West facing Garden
- Gas Central Heating
- Double Glazed Windows



Ground Floor

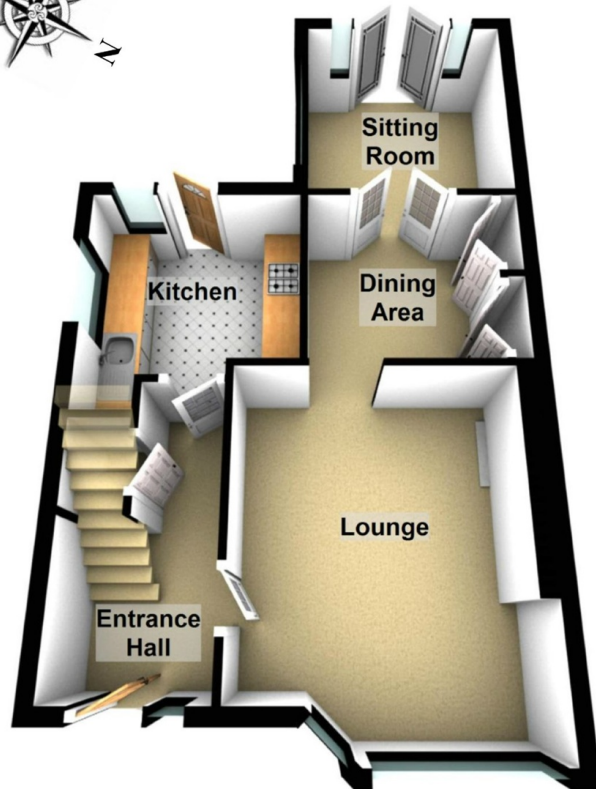

First Floor



APPROX INTERNAL FLOOR AREA
78 SQ M 840 SQ FT

This plan is for layout guidance only and is
NOT TO SCALE
Whilst every care is taken in the preparation
of this plan, please check all dimensions,
shapes & compass bearings before making
any decisions reliant upon them.
Copyright The Property Specialists

Created by
efficient
EPCS & PROPERTY PRESENTATION

Viewing strictly by appointment with The Property Specialists



Making Moving Home
Less Stressful

135 High Street, Billericay,
Essex, CM12 9AB
Tel: 01277 654446
sales@thepropertyspecialists.co.uk