



Elmside Walk

Elmside Walk | Hitchin | Hertfordshire | SG5 1HB

www.stonegate-estates.co.uk



ELMSIDE WALK

Property Description

A rare opportunity to acquire this well-presented assisted living ground floor one bedroom retirement apartment situated within the sought after Archers Court development close to the centre of Hitchin.

Surrounded by attractive, well maintained gardens and offering a reassuring combination of retirement living together with a dedicated care team available round the clock, the apartment offers a fully fitted kitchen with a washing machine, a wet room, a good sized bedroom and direct access to the communal gardens. Set within walking distance of the town centre, a church, health centre and a supermarket.

Hitchin town provides a broad range of shops and a regular traditional market, together with a good selection of restaurants, bars and pubs within its historic centre. The town also provides a swimming centre, theatres and a library, whilst the commuter is served by the main line railway station (Kings Cross - 30 minutes) and direct links to the A1(M).

£295,000 Leasehold





Floor Plan

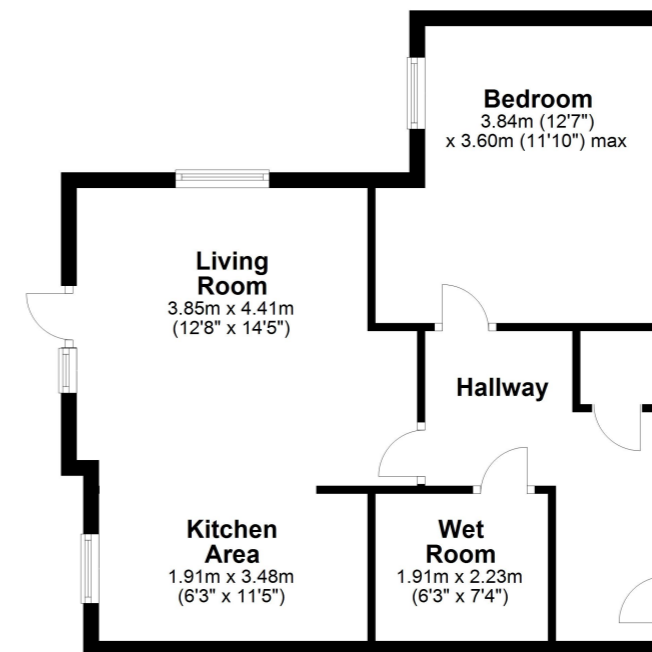

All measurements shown are approximate and for guidance only. Garages and workshops are not included in any gross floor areas unless integral to the main building where they will be included.
Plan produced using PlanUp.



- Assisted Living
- One Bedroom Apartment
- Ground Floor
- Town Centre Location
- Dual Aspect Living Room
- Well Appointed
- Walk in Wet Room
- Communal Gardens and Parking

EPC Rating:

Stonegate Estate Agents

01462 438979

sales@stonegate-estates.co.uk | www.stonegate-estates.co.uk

