



The Walled Garden Cottage, Bleadon, BS24 0NY

£500,000 Freehold

COOPER
AND
TANNER

The Walled Garden Cottage

Lake Farm, Bleadon BS24 0NY

🛏️ 2 🛋️ 1 🚿 2 EPC C

£500,000 Freehold

Description

An outstanding barn conversion set within the walled remains of a 13th century monastery grounds giving the barn an attractive boundary to two sides with open southerly countryside views to Brent Knoll to the rear.

Converted about eight years ago the barn has been tastefully transformed into a stylish and light single-story home with exposed wooden beams in the main living area and large glazed elevations making the very best of the open countryside views.

Approached via a shared driveway into a gated parking area within the walled gardens, a pathway leads to the front door and into the entrance hall. A living room with sitting, dining and kitchen is vaulted and there are fully glazed seamless doors onto the terrace and rear gardens. There is a wood burner cleverly built into the wall which provides an ambient glow and a cosy feel in the winter. The kitchen area is fitted with a range of polished grey cabinets with an electric oven and plumbing for a washing machine and tumble drier. There are two double bedrooms both with well-appointed shower rooms. The barn is heated with underfloor heating via an air source heat pump.

Outside

The gardens are bounded by two sides by the beautiful historic stone walls that are fringed by flower and shrub beds. A wooden fence with climbing plants makes up the boundary with the neighbouring Lake Farm House.

A terrace and decking area, partially covered, is well situated and has convenient access from the living room. There are superb countryside views over open farmland to Brent Knoll to the south. A shed provides useful storage.

Location

Nestled at the western edge of the Mendip Hills, Bleadon is a picturesque village just four miles south of Weston-Super-Mare. Dating back to the Domesday Book, Bleadon offers a rich sense of history alongside modern convenience with a shop and post office, a café, hairdressers, two garages, and three traditional pubs. Families benefit from a play area near the village hall and a mixture of community activities to interest all.

A network of footpaths give access to the surrounding hills and along the river, perfect for walking, cycling, and exploring nature. The nearby Mendip Hills provide endless opportunities for outdoor adventure. Bleadon is ideal for those seeking a strong sense of community and excellent access to transport links, the countryside and the coast.

Agents Note

Set on the outside of the garden wall are some former stone stables and outbuildings and an open yard, these could be available by separate negotiation and can include a more independent access route. The hot tub shown in the photos is not included and has been removed.



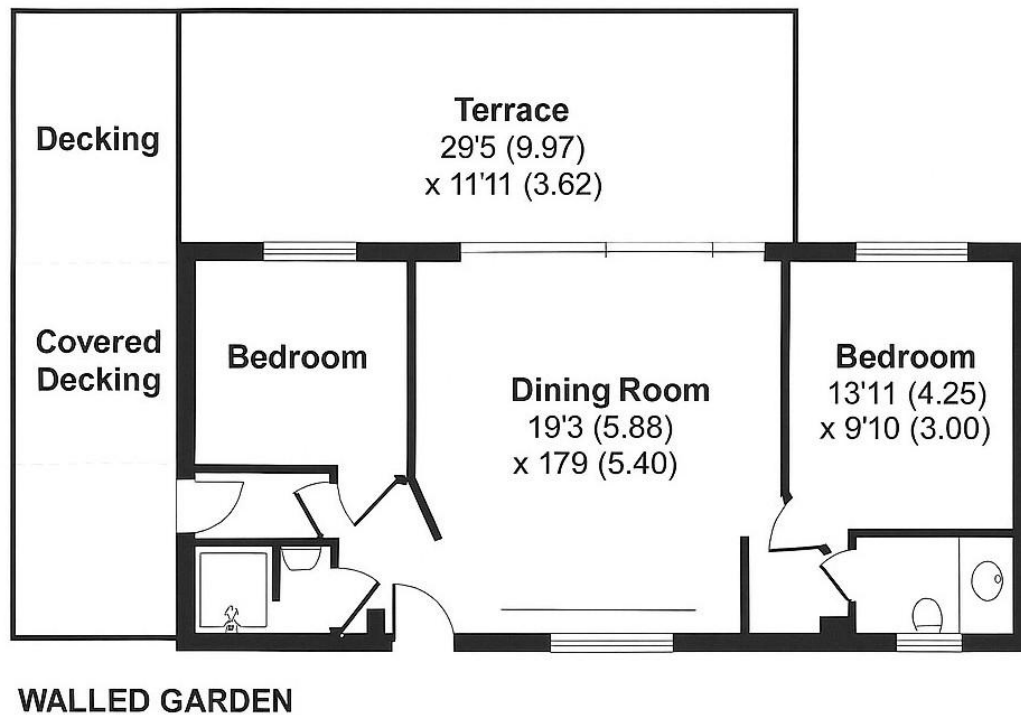

Local Council: North Somerset

Council Tax Band: TBC

Heating: Air source heat pump. Underfloor.

Services: Mains water & Electric. Private treatment plant.

Tenure: Freehold



Motorway Links

- M5



Train Links

- Weston super Mare
- Worle



Nearest Schools

- Hutton & Oldmixon Primary Schools
- Broadoak. Sidcot





FROME OFFICE
telephone 01373 455060
6 The Bridge, Frome, Somerset BA11 1AR
frome@cooperandtanner.co.uk

COOPER
AND
TANNER

Important Notice: These particulars are set out as a general outline only for the guidance of intended purchasers and do not constitute, nor constitute part of, an offer or contract. All descriptions, dimensions, reference to condition and necessary permissions for use and occupation, warranties and other details are given without responsibility and any intending purchasers should not rely on them as statements or representations of fact but must satisfy themselves by inspection or otherwise as to the correctness of each of them.

