

TO LET

£1,750 pcm

Woodville Court, Sylvan Road, SE19



A newly refurbished two double bedroom apartment with off street parking, offering easy access into the Crystal Palace Triangle where public transport is available. Offered unfurnished and available now.

This ground floor purpose built apartment is in fantastic condition throughout, having just been decorated throughout and a brand new kitchen being installed with fitted appliances. The apartment offers a large reception with plantation shutters, two double bedrooms and a modern bathroom with a separate walk-in shower and bath. Further benefits include ample storage within the property and off street parking.

Sylvan Road runs off Church Road and is very appointed for Crystal Palace shops, bars and restaurants. Crystal Palace Railway station is close at hand and offering a frequent service to London Bridge & London Victoria. Both South Norwood Lakes and Crystal Palace Sports Centre are within easy reach.

- Newly Decorated
- Two Double Bedrooms
- New Fitted Kitchen
- Spacious Reception
- Great Storage
- Off Street Parking
- Available Now
- EPC rating C





Sylvan Road, London, SE19

Approximate Area = 631 sq ft / 58.6 sq m

For identification only - Not to scale

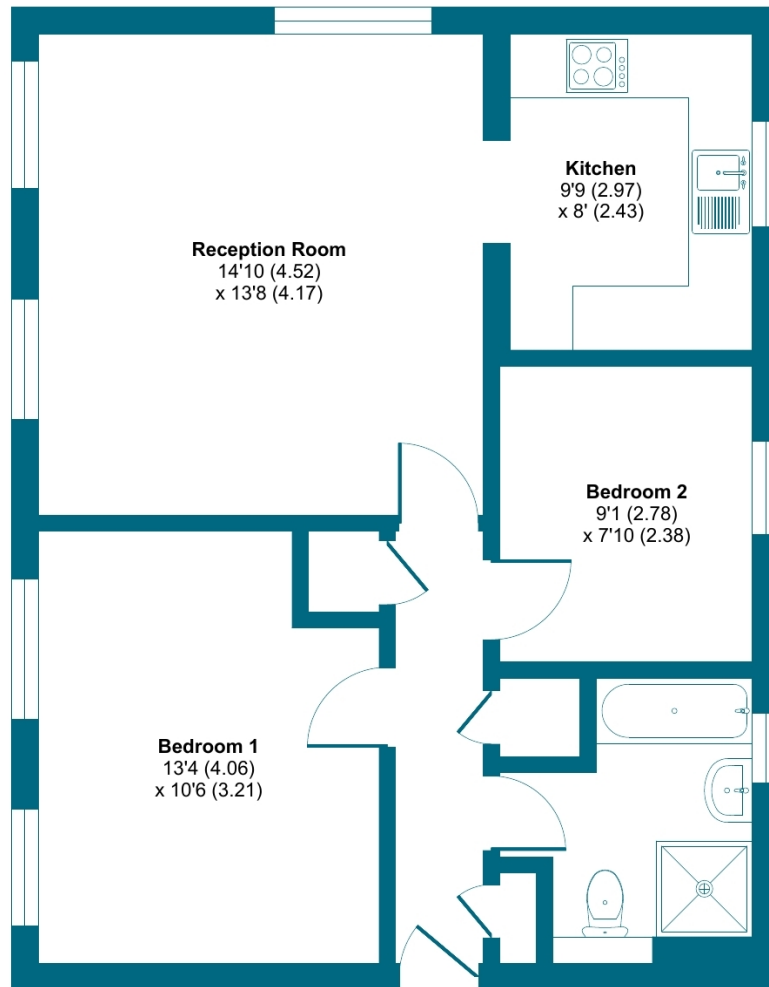

GROUND FLOOR



Floor plan produced in accordance with RICS Property Measurement 2nd Edition, Incorporating International Property Measurement Standards (IPMS2 Residential). © nitchecom 2025. Produced for Grafton Estate Agents. REF: 1252463



Energy Efficiency Rating		
	Current	Potential
Very energy efficient - lower running costs		
(92+) A		
(81-91) B		
(69-80) C	76	80
(55-68) D		
(39-54) E		
(21-38) F		
(1-20) G		
Not energy efficient - higher running costs		
England, Scotland & Wales		
	EU Directive 2002/91/EC	