

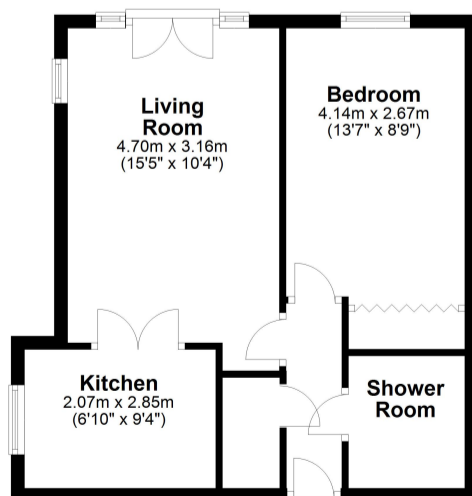

Floor Plan

Approx. 42.0 sq. metres (452.2 sq. feet)



Total area: approx. 42.0 sq. metres (452.2 sq. feet)

All measurements shown are approximate and for guidance only. Garages and workshops are not included in any gross floor areas unless integral to the main building where they will be included.
Plan produced using PlanUp.

Agents note: All measurements are approximate and whilst every attempt has been made to ensure accuracy they are for general guidance only and must not be relied on. The fixture and fittings referred to have not been tested and therefore no guarantee can be given that they are in working order. Internal photographs are reproduced for general information and it must not be inferred that any item shown is included with the property.



A well presented one double bedroom second floor retirement apartment forming part of this well regarded private development. Maples Court is centrally placed within half a mile of the town centre and adjacent to a large Waitrose store with café. In addition, the Butts Close open space is close by and the area is well served with bus services and other facilities; including library, churches and the swimming centre. There is a communal lounge and Development Manager together with a guest suite and communal laundry. This particular apartment has the benefit of a bright lounge with dual aspect windows, together with a window in the kitchen and a Juliet balcony.



- Dual Aspect Living Room
- Juliet Balcony
- Window to Kitchen
- Shower Room
- Views Over Playing Fields
- Town Centre Location
- Communal Gardens
- Development Manager
- No Upper Chain
- Lease - 95 years remaining