



Day & Co
ESTATE AGENTS

28 Cavendish Street
Keighley
BD21 3RG



50 Foster Park Road, Denholme,
Bradford, West Yorkshire, BD13
4BE

£240,000

T: 01535 664609

W: www.dayandcoestateagents.co.uk

E: keighley@dayandcoestateagents.co.uk

- CHALET STYLE SEMI-DETACHED
 - MODERN DINING KITCHEN
 - INTERNAL VIEWING ADVISED
- THREE BEDROOMS
 - GARDENS, DRIVE & GARAGE
 - EPC RATING D

SUMMARY

** CHALET STYLE SEMI-DETACHED HOUSE, THREE BEDROOMS, STYLISH MODERN DINING KITCHEN, MODERN BATHROOM, GARDENS, DRIVEWAY, GARAGE, POPULAR LOCATION, VIEWING ADVISED, EPC RATING D **

FULL DESCRIPTION

Day & Co are pleased to be marketing for sale this three bedroom chalet style semi-detached house situated in the popular village location of Denholme handily placed for access to local primary school. This property has accommodation arranged over two floors briefly comprising -

Ground Floor - Entrance Hallway, Living Room with windows to the front elevation, folding doors opening through to the Dining Kitchen. This room has a stylish modern range of wall and base units, worktops, sink, integrated appliances, side entrance door and double doors to the rear giving access to the garden.

First Floor - Landing, Three Bedrooms, Family Bathroom with a modern suite.

Gas central heating and double glazing.

Externally, there is a front garden, driveway, garage, low maintenance rear garden with artificial grass and paved patio area.

EPC Rating D

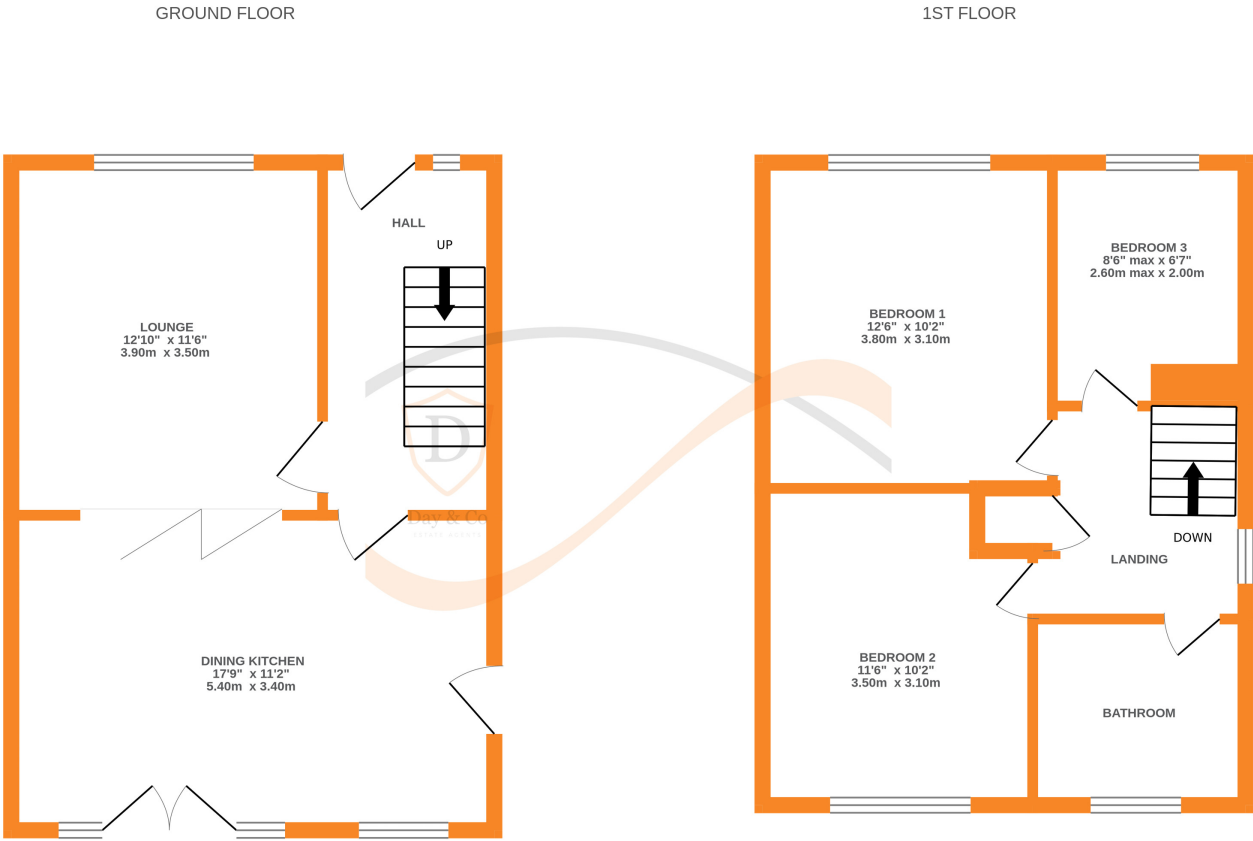

Whilst every attempt has been made to ensure the accuracy of the floorplan contained here, measurements of doors, windows, rooms and any other items are approximate and no responsibility is taken for any error, omission or mis-statement. This plan is for illustrative purposes only and should be used as such by any prospective purchaser. The services, systems and appliances shown have not been tested and no guarantee as to their operability or efficiency can be given.
Made with Metropix 62025