



# *174 Reeve Court Village, Stratton Drive, St Helens, Merseyside. WA9 5BP.* *£141,750*



Popular Reeve Court Village Location | 1 Bed First Floor Apartment | Juliet Balconies To Lounge  
Overlooking Gardens | Wet Room | Council Tax - A | Over 55's Retirement Apartment | Popular  
Development |





FIRST FLOOR  
521 sq.ft. (48.4 sq.m.) approx.

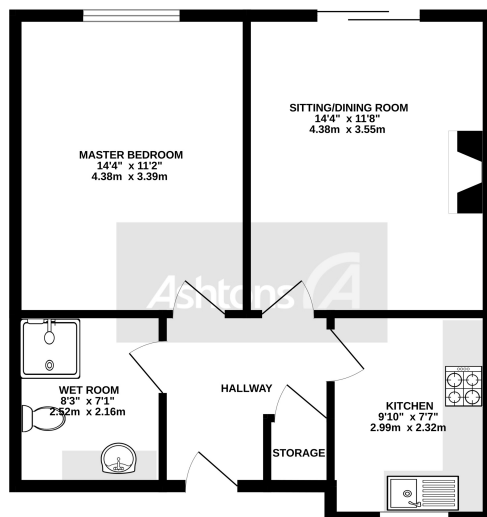

TOTAL FLOOR AREA: 521 sq.ft. (48.4 sq.m.) approx.  
Whilst every attempt has been made to ensure the accuracy of the floorplans contained here, measurements of areas, wall/floor levels and any other details are approximate and no responsibility is taken for any error, omission or misstatement. This plan is for illustrative purposes only and should be used as such by any prospective purchaser. The layout, fixtures and appliances shown here are not intended to be guaranteed as to their quality or efficiency (see the guide).  
Made with Metropix 03/23

\*\*\*OVER 55's RETIREMENT COMPLEX\*\*\*

SERVICE CHARGES TO BE CONFIRMED

Ashtons are delighted to bring to the market this 1st Floor apartment situated on the ever popular Reeve Court Village. Reeve Court is available for clients that are 55 years of age or older. There are a range of amenities in the communal area including a restaurant, salon, shop and plenty of events for residents, and there is on site security and front desk house manager. Two lifts are installed for easy accessibility.



Contact your local office  
to arrange a viewing:

Padgate: 01925 479334  
Great Sankey: 01925 454300  
Winwick: 01925 232146  
Stockton Heath: 01925 453400  
St.Helens: 01744 754120  
Wigan: 01942 498862  
Culcheth: 01925 764744  
Ashton-In-Makerfield: 01942 364446  
Newton-Le-Willows: 01925 907770  
Commercial Office: 01925 907709  
Lettings Head Office: 01925 873533  
Financial Services: 01925 221234

#### Viewing Arrangements

Viewing is strictly by appointment only through  
Ashtons Estate Agency.

#### Disclaimer Property Details

These particulars, whilst being believed to be accurate are set out as a general outline only for guidance and do not constitute any part of an offer or contract. Intending purchasers should not rely on them as statements of representation of fact, but must satisfy themselves by inspection or otherwise as to their accuracy. We have not carried out a detailed survey nor tested the services, appliances and specific furnishings. The measurements given are approximate.

No person in this firm's employment has the authority to make or give any representation or warranty in respect of the property.

All details, photographs and floorplans are the copyright of Ashtons Estate Agency.



How much you can borrow?  
Speak to a mortgage expert in your local office.

**Ashtons** Financial Services

Ashtons.net rightmove

PrimeLocation.com Zoopla.co.uk

**Ashtons**