

TO LET  
£1,200 pcm

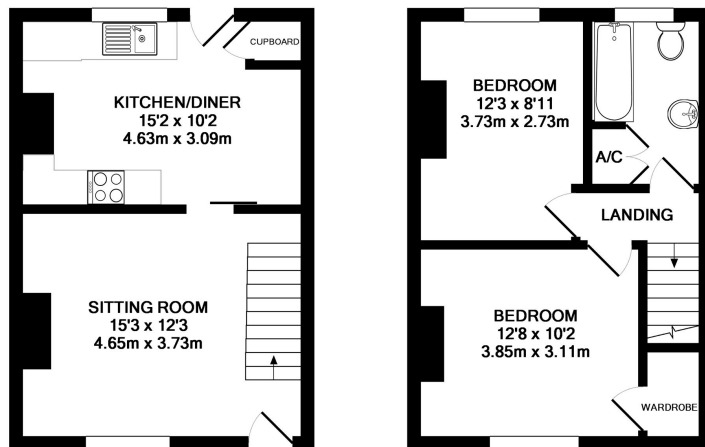

**DESCRIPTION**

A spacious two bedroom end terrace house situated just a stone's throw from Newbury Town Centre. The property boasts a living room, kitchen/ breakfast room, two double bedrooms, bathroom and rear garden.

**FLOOR PLAN**

GROUND FLOOR  
APPROX. FLOOR  
AREA 328 SQ.FT.  
(30.5 SQ.M.)

1ST FLOOR  
APPROX. FLOOR  
AREA 329 SQ.FT.  
(30.5 SQ.M.)

TOTAL APPROX. FLOOR AREA 657 SQ.FT. (61.0 SQ.M.)

Whilst every attempt has been made to ensure the accuracy of the floor plan contained here, measurements of doors, windows, rooms and any other items are approximate and no responsibility is taken for any error, omission, or mis-statement. This plan is for illustrative purposes only and should be used as such by any prospective purchaser. The services, systems and appliances shown have not been tested and no guarantee as to their operability or efficiency can be given.  
Made with Metropix ©2017

- End terrace house
- Town centre location
- Garden
- 12 month rent
- Spacious kitchen
- Lounge
- St Bartholomew school catchment
- Two bedrooms
- Bathroom

