



26 Field Lane, Letchworth Garden City, Hertfordshire, SG6 3LE

Guide price £725,000

Lane & Bennett's are delighted to introduce to the market this 1926 detached, extended & double fronted bungalow in the truly sought after location of Field Lane. Available chain free the property comprises an entrance porch, leading to the entrance hall, a bright bay fronted main bedroom, with two further double bedrooms, two bathrooms, and separate WC. There is a dining room, fitted kitchen, open plan study area, and a sizable 7.5m living space.

The delightful, private and mature rear garden leads to an inviting spinney, with allotments beyond. Side access to the front of the bungalow leads to a lovely lawned area with planting beds, screened by hedging, and off road parking.

Lane &
BENNETTS

26 Field lane Letchworth

Approximate Gross Internal Area
1388 sq ft - 129 sq m

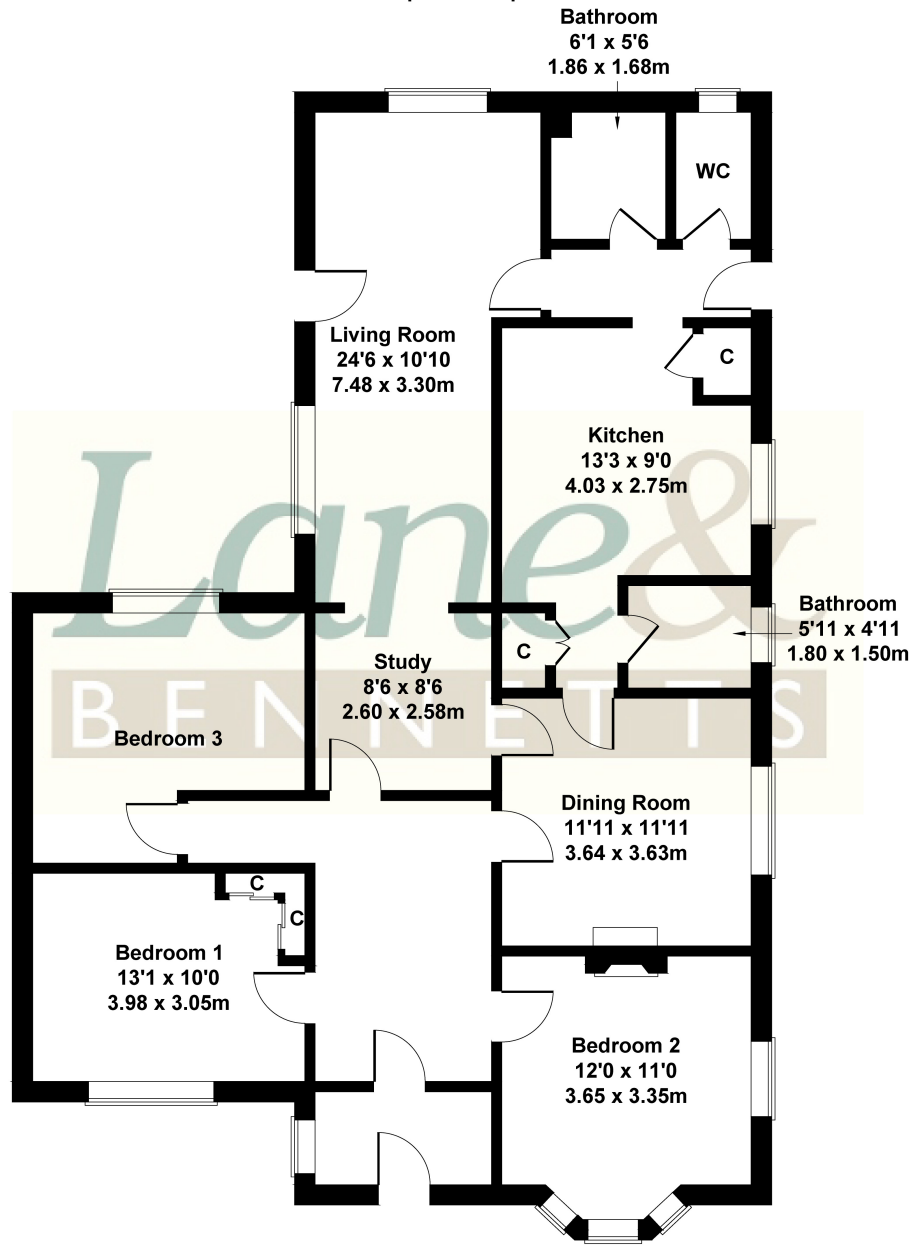

Not to Scale. Produced by The Plan Portal 2023
For Illustrative Purposes Only.

- DETACHED & EXTENDED EARLY GARDEN CITY BUNGALOW
- TRULY SOUGHT AFTER LOCATION MINUTES FROM TOWN, STATION & HIGHLY REGARDED SCHOOLS
- THREE DOUBLE BEDROOMS
- LARGE LIVING ROOM | DINING ROOM | STUDY
- TWO BATHROOMS & CLOAKROOM
- PRIVATE REAR GARDEN AND SPINNEY
- FITTED KITCHEN
- CHAIN FREE - AVAILABLE TO VIEW NOW
- SCOPE FOR LOFT CONVERSION AND FURTHER EXTENSION STP
- ALLOCATED OFF ROAD PARKING FOR TWO CARS

