



Lindfield Gardens, Hampstead, NW3

£3,500
pcm



Lindfield Gardens, Hampstead, NW3

A prestigious two bedroom apartment situated on the first of a gorgeous period building benefiting from an impressive open plan kitchen/reception room and contemporary bathroom. Key features include high ceiling, wood flooring and luxury appliances,

Lindfield Gardens is perfectly positioned just 0.5 miles from Hampstead Underground station (Northern Line) and 0.7 miles from West Hampstead's Underground (Jubilee Line), Overground and Thameslink station. Local amenities, restaurants and further transport links can be found on the Finchley Road which is located just 0.2 miles from the apartment.

Features

- Two Bedroom
- Offered Unfurnished
- First Floor Flat
- Within Gorgeous Period Building
- Contemporary Bathroom
- Impressive Open Plan Kitchen/Reception
- Available From Mid-January 2025



Lindfield Gardens, Hampstead, NW3

Lindfield Gardens, NW3

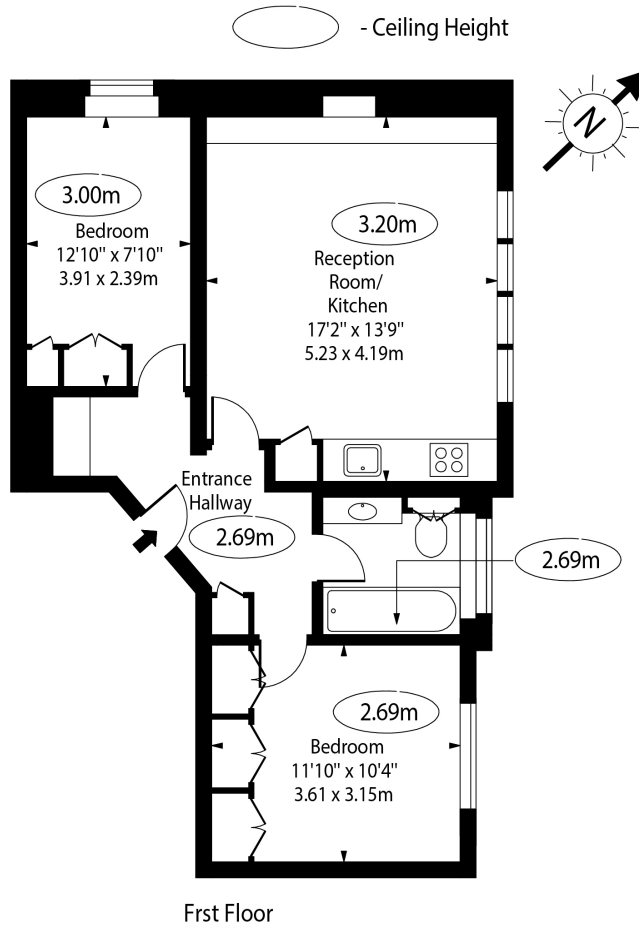

Approx Gross Internal Area 600 Sq Ft - 55.74 Sq M

For Illustration Purposes Only - Not To Scale Floor Plan by www.nogaphotostudio.com Ref: No.46225

This floor plan should be used as a general outline for guidance only. Any intending purchaser or lessee should satisfy themselves by inspection, searches, enquiries and full survey as to the correctness of each statement. Any areas, measurements or distances quoted are approximate and should not be used to value a property or be the basis of any sale or let.