

FOR SALE

Ealing Village,
Ealing , W5

Flat
Ealing

£600,000 lh

4  1  1 



**horton
andgarton**

SALES / LETTINGS / PROPERTY MANAGEMENT

hortonandgarton.co.uk | Sales 020 3989 6464 | Lettings 020 3989 5454
161 Chiswick High Road, London, W4 2DT



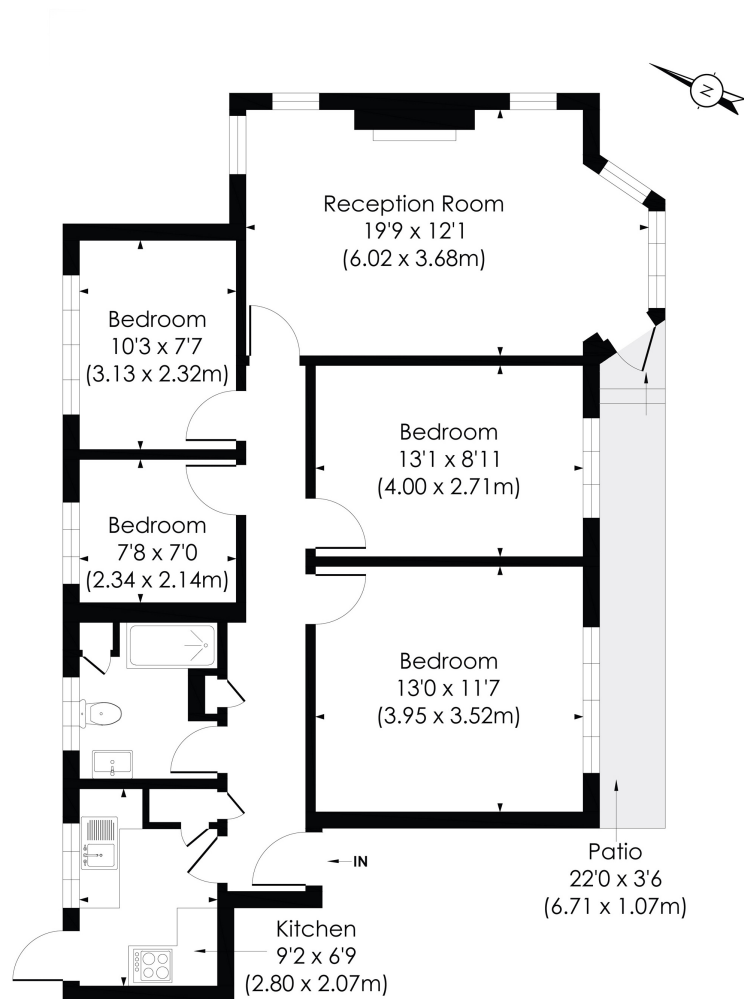

GROUND FLOOR

EALING VILLAGE, W5

Approx. Gross Internal Floor Area

873 Sq. ft/81.09 Sq. m

**horton
and garton**

© Pixangle Property Marketing Ltd. info@pixangle.com Tel: 0208 870 2118

This floor plan has been prepared for the purpose of illustration only in accordance with the latest RICS code of measuring practice and is not to scale. All measurements and areas are approximate and whilst every effort has been made to ensure the accuracy of the plan contained here, no responsibility is taken for any error, omission or misstatement.



Purpose built Art Deco apartment | Four bedrooms -
One bathroom | 873 Sq' - 81.09 SqM | Full length heated
swimming pool | EPC rating D | Ealing



hortonandgarton.co.uk

Sales 020 3989 6464

Lettings 020 3989 5454

161 Chiswick High Road, London, W4 2DT