



HILTON KING & LOCKE

SPECIALISTS IN PROPERTY



Cherry Avenue, Langley, Berkshire. SL3 7BT.

£599,950 Freehold

**\*EXTENDED DOUBLE STOREY AT THE REAR TO PROVIDE 5 BEDROOMS, TWO BATHROOMS\***

**\*OVER 1500 SQUARE FT OF ACCOMMODATION\***

**\*LOCATED IN POPULAR CHERRY AVENUE - A NO THROUGH ROAD\***

**\*GREAT SIZED GARDEN PLUS A DETACHED GARAGE\***

A great property if you are looking for good all round family accommodation.

Having been extended double storey to the rear and still retaining an excellent sized garden, this impressive five bedroom, two reception, two bathroom semi is excellent value for money.

Situated in Cherry Avenue, which is a popular no through road, this property is a must see, plus there is also a block paved driveway providing parking for numerous cars and a 21'5 x 10'4 detached garage.

On the ground floor is a bay fronted 24'8 x 12'8 living room, 10'11 x 9'3 dining room, 18'6 x 11'8 kitchen and also a shower room.

Upstairs, is a front aspect master bedroom with two sets of fitted wardrobes, two more double



bedrooms plus two additional single bedrooms. Completing the accommodation is a fully tiled modern bathroom with a corner panel bath.

Outside, the rear garden has a large patio and is mainly laid to lawn.

## LOCATION

This property is walking distance to Langley Road with its array amenities and offers quick and easy access to both Langley and Slough Town Centres.

Langley & Slough Stations, which will shortly join the Crossrail route in 2022, are both under two miles away and the M4, M25 and M40 plus Heathrow are also easily accessible.

A host of renowned schools including Langley Hall and Marish Primary are within a short distance, as are Langley Grammar, Upton Court Grammar, St Bernard Grammar and Langley Academy.



### Important Notice

Particulars: These particulars are not an offer or contract, nor part of one. You should not rely on statements by Hilton King & Locke Ltd in the particulars or by word of mouth or in writing as being factually accurate about the property, its condition or its value. Hilton King & Locke Ltd does not have any authority to make any representations about the property, and accordingly any information given is entirely without responsibility on the part of the agents, seller(s) or lessor(s).

Photographs etc: The photographs show only certain parts of the property as they appeared at the time they were taken. Areas, measurements and distances given are approximate only.



23 High Street  
Iver Buckinghamshire SL0 9ND

Tel: 01753 650033  
iver@hklhome.co.uk

## Ground Floor

Approx. 83.4 sq. metres (898.1 sq. feet)



## First Floor

Approx. 62.4 sq. metres (672.2 sq. feet)

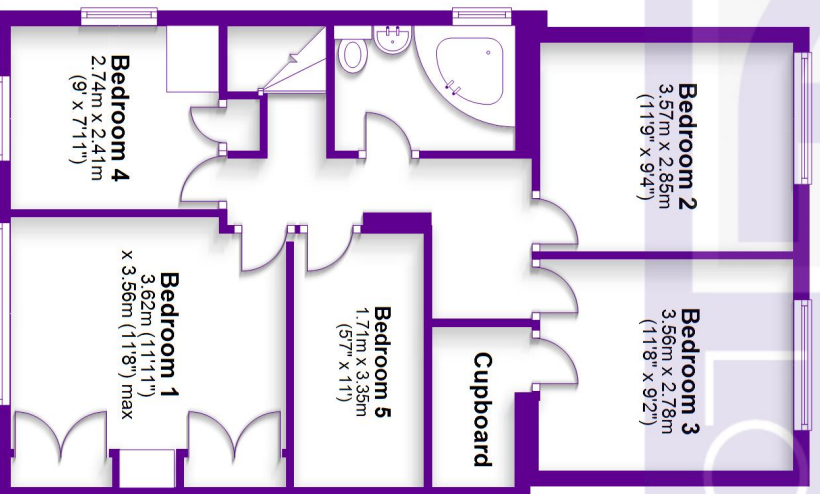

Total area: approx. 145.9 sq. metres (1570.3 sq. feet)

FOR ILLUSTRATIVE PURPOSES ONLY - NOT TO SCALE  
The position and size of doors, windows, appliances and other features are approximate only. Total areas inc garages & outbuildings  
© My Home Property Marketing - Unauthorised reproduction prohibited.  
Plan produced using PlanUp.