



91 Derwen Fawr Road, Sketty, Swansea, SA2 8DR

Asking Price: £429,950

- Extended Three Bedroom Detached Bungalow
- Larger Than Average Enclosed Rear Garden
- Within A Good School Catchment Area
- Single Detached Garage
- Two Reception Rooms
- Popular And Highly Sought After Residential Area
- Driveway Parking
- Freehold Title



Entrance Hallway

Entered via double glazed side door giving access to an L shaped hallway, solid oak wood flooring and doors to:-

Lounge

5.833m x 3.901m (19' 2" x 12' 10")

With stripped pine floor boards, open fire place with inset electric fire, oak mantle and sandstone hearth, picture rail and double glazed bay window to front aspect.

Dining Room

5.231m x 3.782m (17' 2" x 12' 5")

A good size light and airy family room with picture rail and double bay window looking onto front aspect.

Kitchen

5.399m x 1.429m (17' 9" x 4' 8")

A fully fitted kitchen with a good selection of matching base and wall units, shaker style in cream with solid wood work surface space and preparation area incorporating sink unit with hot and cold taps over, built in fan assisted electric cooker, 5 ring gas burner and extractor canopy over, part tiled walls, space for fridge freezer, spot lights, double glazed window to side aspect and door giving access to lean to.

Lean To

Accessed off kitchen with polycarbonate roof, slatted window to front aspect, plumbing for automatic washing machine and tumble drier and access to:-

Garden Room

4.275m x 1.940m (14' 0" x 6' 4")

With double glazed window and double glazed door giving access to the rear garden.

Master Bedroom

5.196m x 4.473m (17' 1" x 14' 8")

With double glazed bay window looking onto rear garden.

Bedroom Two

4.956m x 3.239m (16' 3" x 10' 8")

With picture rail and double glazed bay window looking onto rear garden.



Approx Gross Internal Area
111 sq m / 1200 sq ft

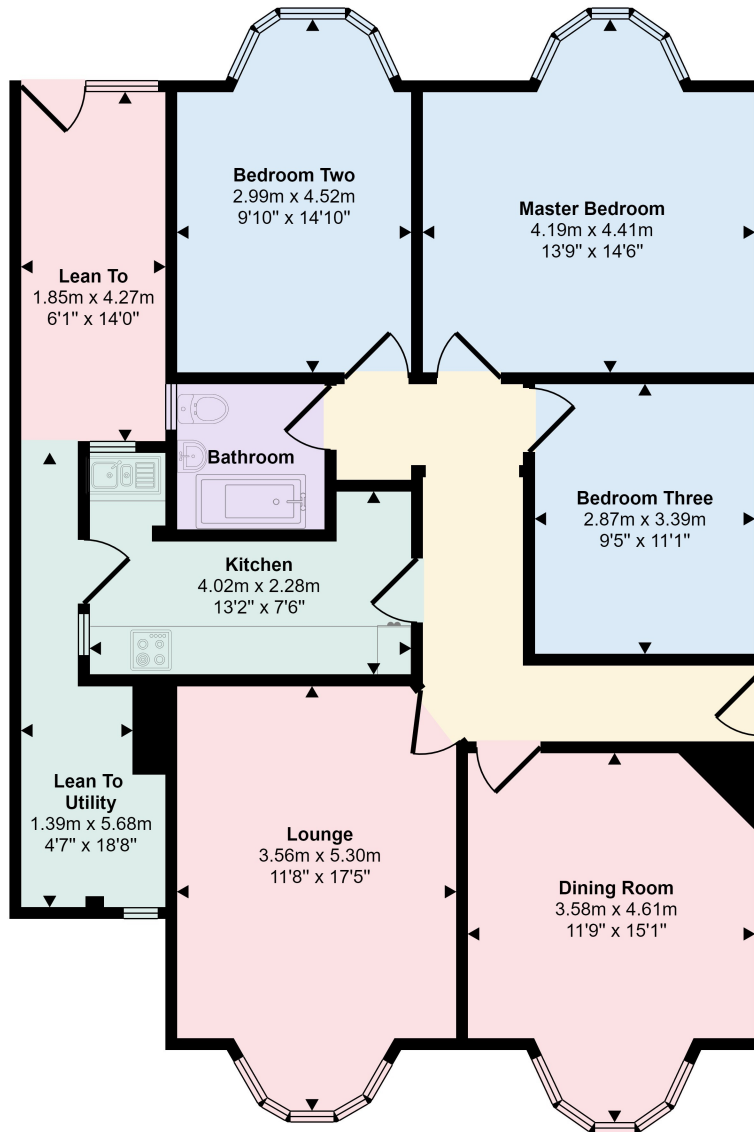

Floorplan

