

Truuli



Mitcham Road, Croydon, Surrey, CR0

£425,000 Freehold

- Off street parking
- Located close to Ampere Way trams stop
- Excellent transport links
- Close to Mitcham Common
- Well maintained family home
- Guide price £425,000 - £450,000

2, Lansdowne Road, Croydon, Surrey, CR9 2ER

Tel: 0330 043 0002

Email: save@truuli.co.uk Web: www.truuli.co.uk

Mitcham Road, Croydon, Surrey, CR0

£425,000 Freehold

*** Guide price £425,000 - £450,000 *** A delightful three-bedroom house with off-street parking situated on the popular Mitcham Road, Croydon, close to a plethora of excellent transport links.

Ground Floor
448 sq.ft. (41.6 sq.m.) approx.

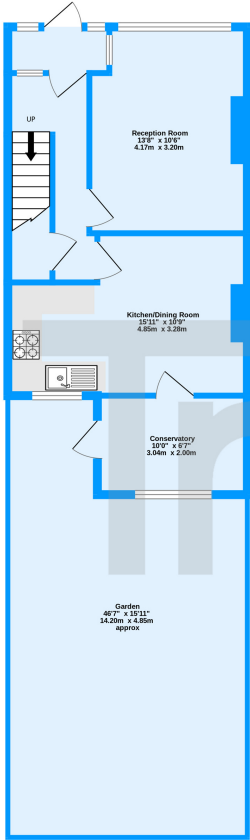

1st Floor
395 sq.ft. (36.7 sq.m.) approx.

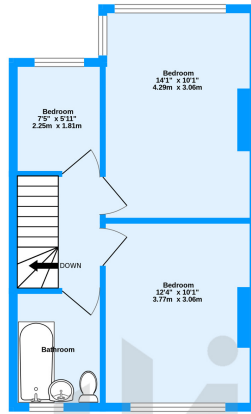

Mitcham Road, Croydon, CR0

TOTAL FLOOR AREA: 843 sq.ft. (78.3 sq.m.) approx.
Measurements are approximate. Not to scale. Illustrative purposes only
Made with MetroPix ©2023

