



**Tewkesbury**

**01684 293246**

**Engall  
Castle  
.com**



# First Cottage, Fryzers Court, Tewkesbury, GL20 5PP

Hidden away in the heart of the town centre, with the look and feel of a Cornish fisherman's cottage, this property is quite delightful!

Beautifully presented throughout with characterful beams on the ground floor the accommodation comprises of a lounge with door to the kitchen which is fitted with a range of wall and base units with integrated gas hob and electric oven.

On the first floor there is a bathroom and two bedrooms both benefitting from fitted wardrobes. The bathroom is fitted with a contemporary white suite comprising of a panel bath, vanity unit with hand basin and low level wc.

Throughout the property benefits from upvc double glazed windows and doors and gas fired central heating.

Outside the cottage has the benefit of a pretty courtyard garden just perfect for that lazy Sunday breakfast or that evening glass of wine!



Located within a private gated alleyway, convenient for the wealth of amenities within Tewkesbury including leisure, health, and education facilities including hospital, theatre, swimming pool and sports centre all within easy walking distance of the property.

Centrally situated between Cheltenham, Worcester, Gloucester and Evesham it is an excellent commuting base, with Birmingham and other major cities made easy with the motorway and rail networks readily accessible.

Tewkesbury itself is located on Junction 9 of the M5 motorway making it an excellent commuter base.

Approximate Distances:

Cheltenham 13 miles;  
Gloucester 15 miles  
Worcester 17 miles

Birmingham 42 miles  
London 128 miles

## Ground Floor

Lounge 13'1"x9'5"  
Kitchen 12'8"x6'5"

## First Floor

Bedroom 1 10'x9'  
Bedroom 2 9'x7'7"  
Bathroom 5'11x5'10"

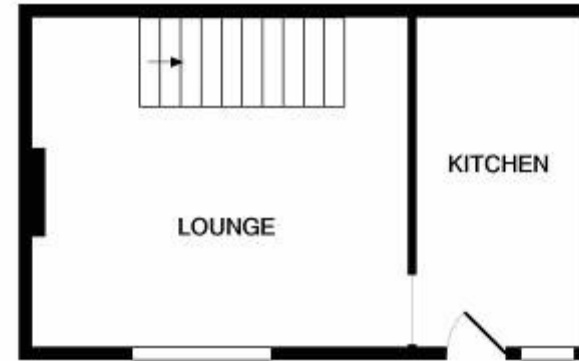

GROUND FLOOR

## Outside

Courtyard Garden

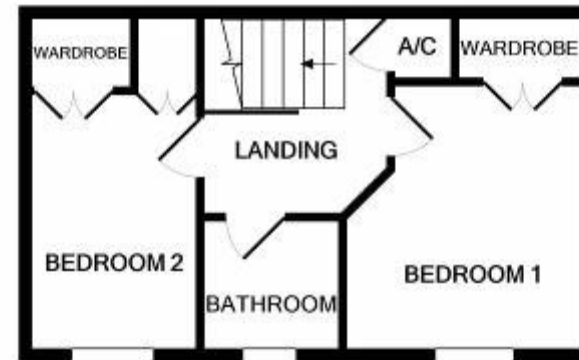
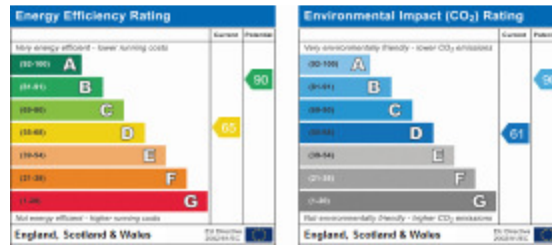

1ST FLOOR

This floorplan is provided for guidance only as an approximate layout of the property and should not be relied upon as a statement of fact.

**Guide Price £160,000**

Viewing strictly by arrangement with Engall Castle Ltd  
155 High Street Tewkesbury Gloucestershire GL20 5JP  
Office hours: Mon – Fri 9am to 6pm, Sat 9am to 4pm  
email: [sales@engallcastle.com](mailto:sales@engallcastle.com)

**01684 293 246**  
[www.engallcastle.com](http://www.engallcastle.com)



### Agents Note

These property details are set out as a general outline only and do not constitute any part of an Offer or Contract. Any services equipment, fittings or central heating systems have not been tested and no warranty is given or implied by Engall Castle Ltd that these are in working order. Buyers are advised to obtain verification from their solicitor or surveyor. Fixtures and fittings or other items are not included unless specifically described. All measurements, distances and areas are approximate and for guidance only and should not be relied upon for the purposes of fitting carpets or furniture etc. These property details and all statements within this document are provided without responsibility on behalf of Engall Castle Ltd or its employees or representatives and should not be relied on as statements of fact. Prospective purchasers must satisfy themselves as to the accuracy of all details pertaining to the property.

