



Conveniently situated within a short distance to Langley Station and local schools including Langley Heritage Primary, this two bedroom cluster house is presented to the market in good condition throughout and has the advantage of no onward chain, inviting a quick sale. The property offers a fantastic opportunity for first time buyers.

The ground floor features a spacious 14ft reception room complete with bay windows and, a fitted kitchen equipped with a gas cooker/oven, ample storage and whites goods including a washing machine.

On the first floor you will find, two good sized bedroom in which the master benefits from integrated storage as well the three piece family bathroom. Externally, there is on street parking for residents and visitors.

The property will also benefit from a new lease of 125 years upon completion.



Property Information

- 

TWO BEDROOM END OF TERRACE PROPERTY
- 

GREAT OPPORTUNITY FOR FIRST TIME BUYERS
- 

GOOD CONDITION THROUGHOUT
- 

THREE PIECE FAMILY BATHROOM
- 

NO ONWARD CHAIN
- 

SPACIOUS SITTING ROOM WITH BAY WINDOW
- 

SHORT DISTANCE TO LANGLEY STATION AND LOCAL SCHOOLS
- 

EXTENDED LEASE UPON COMPLETION



x2

Bedrooms



x1

Reception Rooms



x1

Bathrooms



0

Parking Spaces



N

Garden



N

Garage

Lease Information:

Lease years - 125 years (upon completion)
Service charge- TBC
Ground rent- TBC

Transport Links

NEAREST STATIONS:

Langley - 660 yards
Iver - 1.2 miles
Slough - 2.5 miles

Local Schools

PRIMARY SCHOOLS:

The Langley Heritage Primary
350 yards

Langley Hall Primary Academy
0.5 miles

Marish Primary School
0.6 miles

Foxborough Primary School
0.9 miles

The Langley Academy Primary
0.9 miles

SECONDARY SCHOOLS:

Langley Hall Arts Academy
0.7 miles

The Langley Academy
0.9 miles

Langley Grammar School
1 mile

St Bernard's Catholic Grammar School
1.7 miles

Ditton Park Academy
1.8 miles

Upton Court Grammar School
2 miles

Council Tax
Band C

Floor Plan



Maplin Park
Approximate Floor Area = 47.06 Square meters / 506.55 Square feet

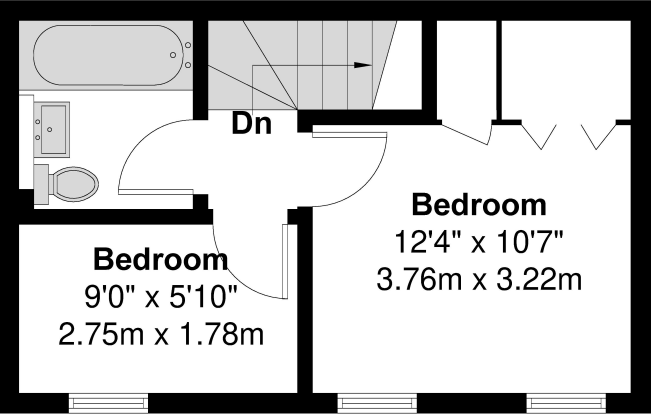
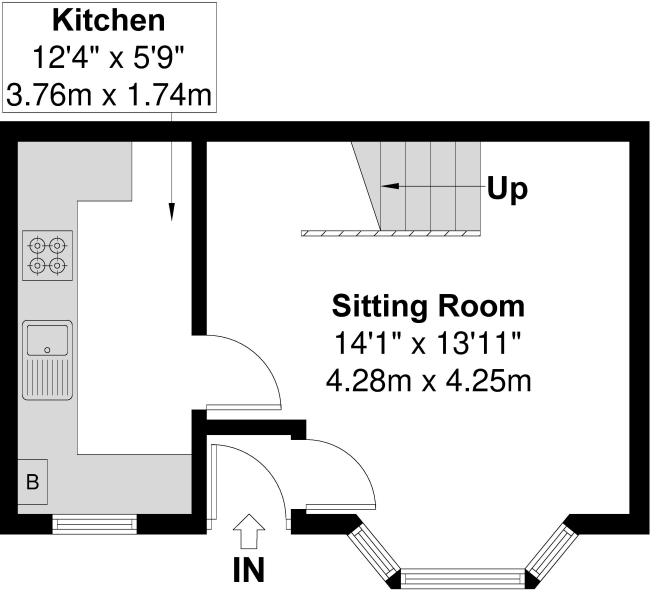

Ground Floor

First Floor

Illustration for identification purposes only,
measurements are approximate, not to scale.

Prospective purchasers should be aware that these sales particulars are intended as a general guide only and room sizes should not be relied upon for carpets or furnishing. We have not carried out any form of survey nor have we tested any appliance or services, mechanical or electrical. All maps are supplied by Goview.co.uk from Ordnance Survey mapping. Care has been taken in the preparation of these sales particulars, which are thought to be materially correct, although their accuracy is not guaranteed and they do not form part of any contract.

