



Queen Street

Saxon Court | Queen Street | Hitchin | Hertfordshire | SG4 9TB

www.stonegate-estates.co.uk



QUEEN STREET

Property Description

We are delighted to offer for sale this one bedroom lower ground floor retirement home overlooking Hitchin Market Place and St Mary's church.

Located within the heart of Hitchin, this one bedroom apartment has access from the lounge to a small outside area. The apartment is served by a 24 hour careline system offering piece of mind to all who live there and benefits from a house manager on site for a period Monday to Friday.

The property is well presented and has a light and airy feel with the lounge door opening on to the outside area, a separate kitchen leads off the lounge. The double bedroom benefits from a built-in wardrobe and the bathroom is adjacent.

There are communal living areas along with laundry facilities on site as well as a house manager, a visitors suite and various events to include coffee mornings.

Hitchin Market Place and the High Street are easily accessed via the secure adjacent pedestrian gate directly onto Queen Street and Hitchin railway station offers direct connections to London Kings Cross, Cambridge, and more.

Viewing is highly recommended to avoid disappointment.

£150,000 Leasehold





Approximate Gross Internal Area = 45.9 sq m / 494 sq ft

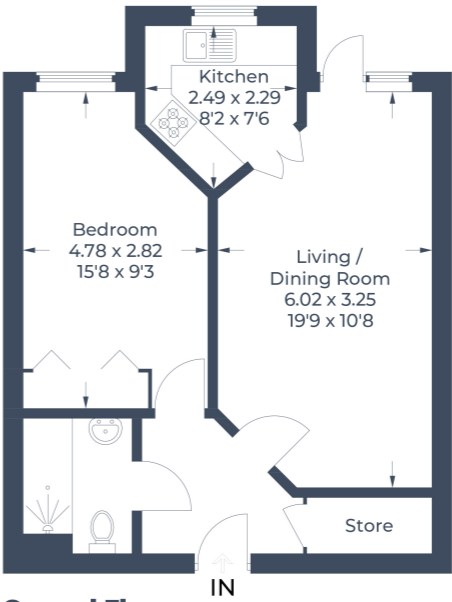

Ground Floor

Illustration for identification purposes only, measurements are approximate, not to scale.
© C3 Property Marketing Produced for Stonegates



- Ground Floor Apartment
- One Bedroom
- Well Presented
- Town Centre Location
- Careline 24hr System
- Communal Lounge & Garden
- House Manager on Site
- Chain Free Purchase

EPC Rating:

Stonegate Estate Agents

01462 438979

sales@stonegate-estates.co.uk | www.stonegate-estates.co.uk

