

FOR SALE

£209,995 Freehold



117 Shutewater Orchard, Bishops Hull, TA1 5FA

£209,995
Freehold

- Spacious Two Bedroom Coach House
- Ideal First Time Buy Or Investment
- Large Living Room (23'9" x 10'2")
- Landscaped Rear Garden
- Integral Garage and Parking
- Modern Fitted Kitchen and Bathroom
- Double Glazing and Central Heating
- NO ONWARD CHAIN



PROPERTY DESCRIPTION

Newton King are delighted to offer to the market with NO ONWARD CHAIN, this spacious two bedroom coach house situated in a peaceful position within a popular development in the Bishops Hull area of Taunton. The property would make an ideal first time buy or investment and benefits from a low maintenance garden, garage & allocated parking.

The property offers convenient and comfortable living throughout & comprises; Entrance hall providing access to the garage, large living room (23'9" x 10'2"), modern fitted kitchen with gas hob & electric oven, white suite bathroom, two good sized bedrooms & a low maintenance rear garden.

The property is centrally heated via gas & benefits from a boiler which is less than a year old. EPC Rating B, Council Tax Band B.

Investors could expect a monthly rent of £995 PCM making this a fantastic investment opportunity.

The property is to be offered with NO ONWARD CHAIN, please contact Newton King between the hours of 9am-6pm to arrange a fully accompanied viewing.





FLOORPLAN

Newton King

TOTAL APPROX. FLOOR AREA 775 SQ.FT. (72.0 SQ.M.)

Whilst every attempt has been made to ensure the accuracy of the floor plan contained here, measurements of doors, windows, rooms and any other items are approximate and no responsibility is taken for any error, omission, or mis-statement. This plan is for illustrative purposes only and should be used as such by any prospective purchaser. The services, systems and appliances shown have not been tested and no guarantee as to their operability or efficiency can be given
Made with Metropix ©2016

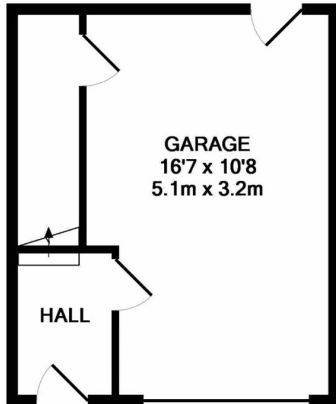

GROUND FLOOR
APPROX. FLOOR
AREA 226 SQ.FT.
(21.0 SQ.M.)

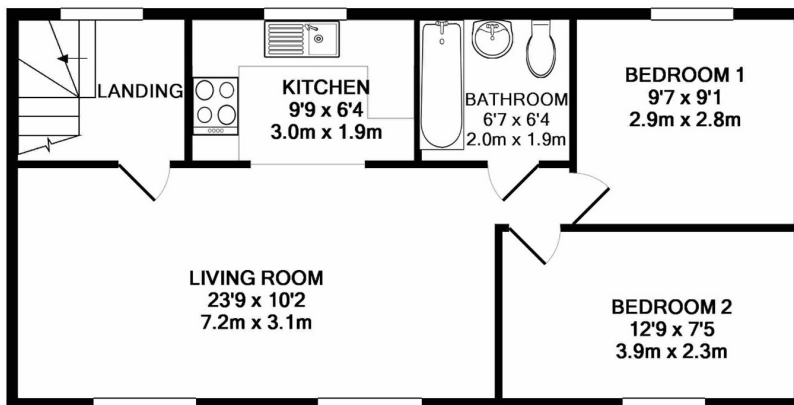

1ST FLOOR
APPROX. FLOOR
AREA 550 SQ.FT.
(51.1 SQ.M.)

Taunton
53, East Street, Taunton, TA1 3NA
01823 259753
taunton@newtonking.co.uk