

Westleigh

Warminster, BA12 8NJ

COOPER
AND
TANNER



£210,000 Freehold

2 1 1 EPC D

Description

This two bedroom mid terrace house is beautifully presented and offers good sized accommodation throughout. It offers parking and an enclosed rear garden. It would be a ideal for a first time buyer or an investment purchase. The accommodation an entrance hall, a light and airy sitting room with a fireplace, a fully fitted kitchen which leads into a rear utility area which has access to the rear garden. Leading upstairs there are two double bedrooms and a fully fitted shower room. The rear garden is privately enclosed by fencing and has paving and AstroTurf. At the front there is a parking space for one car.



Westleigh, Warminster, BA12

Approximate Area = 624 sq ft / 57.9 sq m

For identification only - Not to scale

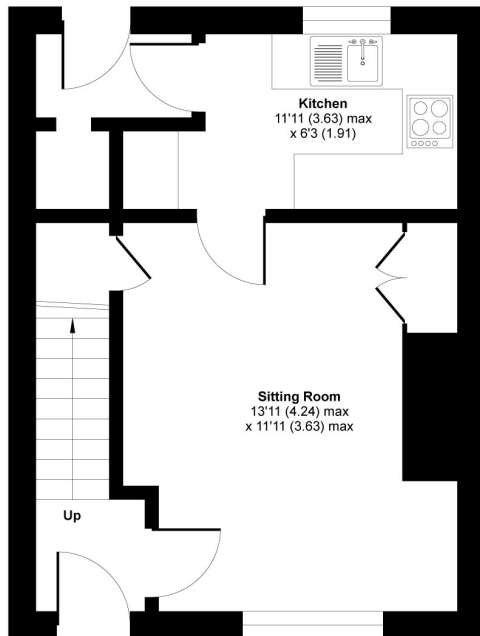

GROUND FLOOR

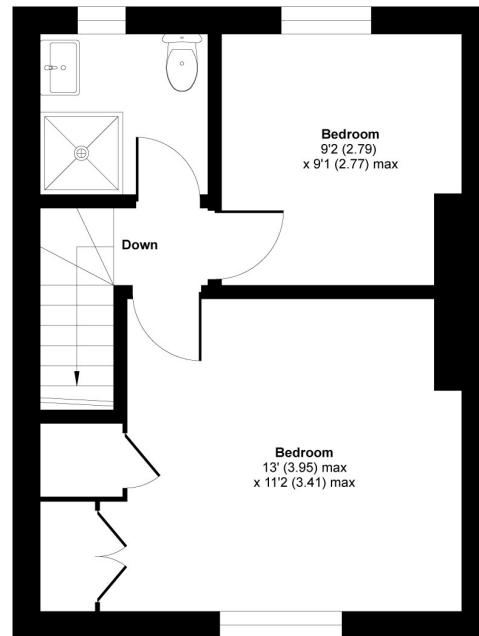

FIRST FLOOR

Floor plan produced in accordance with RICS Property Measurement 2nd Edition, Incorporating International Property Measurement Standards (IPMS2 Residential). © nichcom 2026. Produced for Cooper and Tanner. REF: 1407947



Features

- Well presented mid terrace home
- Sitting room
- Kitchen
- Two bedrooms
- Utility area
- Shower Room
- Enclosed garden to the rear
- Driveway Parking
- Ideal first time buy or investment property
- Internal viewing recommended

Local Information

- Council Tax Band A
- Tenure Freehold
- EPC Rating D

WARMINSTER OFFICE

Telephone 01985 215579

48-50, Market Place, Warminster, Wiltshire BA12 9AN

warminster@cooperandtanner.co.uk

**COOPER
AND
TANNER**

Important Notice: These particulars are set out as a general outline only for the guidance of intended purchasers and do not constitute, nor constitute part of, an offer or contract. All descriptions, dimensions, reference to condition and necessary permissions for use and occupation, warranties and other details are given without responsibility and any intending purchasers should not rely on the same as statements or representations of fact but must satisfy themselves by inspection or otherwise as to the correctness of each of them.

