

Disclaimer: For clarification we wish to inform prospective purchasers that we have prepared these sales particulars as a general guide. We have not carried out a detailed survey or tested the services, appliances and specific fittings.

House area: approx. 40.0 sq. metres (430.6 sq. feet)  
Outbuilding area: approx. 6.5 sq. metres (70.0 sq. feet)  
Total area: approx. 46.5 sq. metres (500.5 sq. feet)  
This plan is for layout guidance only.  
Measurements are for general guidance  
only and must not be relied upon

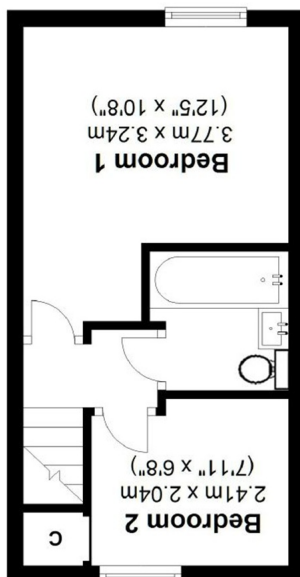

**First Floor**  
Approx. 18.6 sq. metres (200.6 sq. feet) Approx. 21.3 sq. metres (229.5 sq. feet)

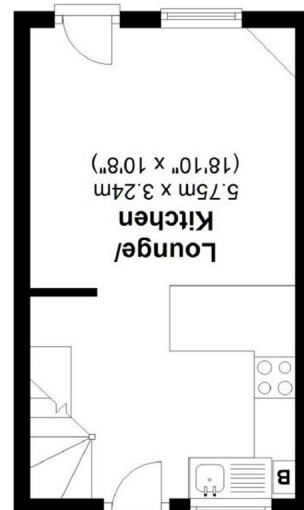

**Ground Floor**  
Approx. 18.6 sq. metres (200.6 sq. feet)

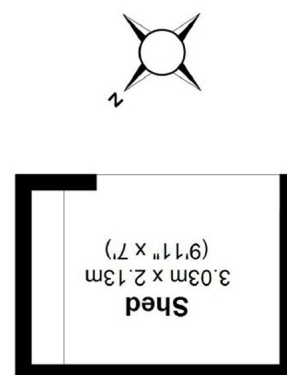

(Not in position)

## 24 Mead Lane, Farnham, GU9 7DY

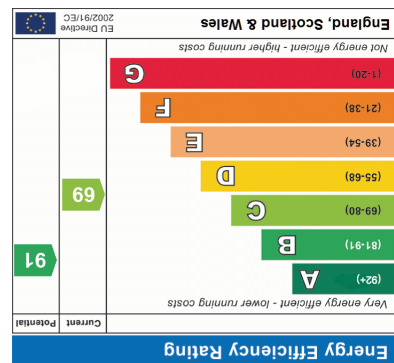





### Description

**\*\* VIEWINGS COMMENCE Saturday 29th June \*\*** This rental presents a rare opportunity to rent an attractive period mews house of considerable character on the edge of Farnham's elegant Georgian centre, within a short walk of the station. The well-proportioned accommodation benefits from a host of features including UPVC double glazing, modern bathroom with shower over the bath, open plan kitchen through lounge and gas fired central heating. To the front of the property there is a small forecourt area, whilst to the rear there is an enclosed courtyard with a private, secure covered storage area. Resident parking permits are available from the council. Subject to availability, permits can also be bought from the football club for their car park. Tenant's Notes - Proof of a professional clean on exit will be required including the appliances.



### Directions

Proceed out of the town centre along West Street, and turn left into Mead Lane, before Farnham Tandoori. Proceed down the lane and turn right just before the football club, where the property will be found on the top right hand of terraces.

### Local Authority

Waverley  
Band B

