

TO
LET



Curtis Road, Ewell KT19 0LQ

£1,500 pcm



252, Chessington Road, Ewell, Epsom, KT19 9XF 0208 394 2555 sales@jacksonnoon.com

PROPERTY SUMMARY

Available Easter 2024. We are pleased to offer this 2 double bedroom split-level maisonette with large kitchen and modern bathroom and located close to local amenities, Zone 5 Mainline BR station. Council Tax Band C

POINTS OF INTEREST

- *Split Level*
- *Maisonette*
- *2 Double Bedrooms*
- *Large Kitchen*
- *Modern Bathroom*
- *Close to Zone 5 Station*
- *Available Easter 2024*



ROOM DESCRIPTIONS

Summary

Summary

This split level maisonette over 1st and 2nd floors includes 2 well proportioned double bedrooms, a modern bathroom, large kitchen and lounge.

Located in a residential area of similar properties close to the Hogsmill open space, local shops and within approx. 15 mins walking distance of Tolworth BR Station (Zone 5).

Sorry - no pets..

Council Tax band C

The prospective tenant will need to qualify, after full references, as acceptable for Rent Guarantee Indemnity Insurance purposes.

Deposits

Holding Deposit equal to 1 week's rent

Damage deposit equal to 5 week's rent, Zero deposit may also be available.

Jackson Noon Estate Agents Ltd are Members of The Property Ombudsman and CMP (Client Money Protect).

Front Door to

Entrance Hall

Understairs cupboard

Lounge

5.40m x 3.58m (17' 9" x 11' 9") Double glazed window

Kitchen

11' 5" x 11' 4" (3.48m x 3.45m) Single drainer stainless steel sink unit inset in roll top work surface, range of cupboards and units, fridge freezer, washing machine, cooker with gas hob, double glazed window

Stairs to First Floor

Landing

2 storage cupboards

Bedroom 1

11' 9" x 10' (3.58m x 3.05m) Double glazed window

Bedroom 2

13' x 8' 6" (3.96m x 2.59m) Double glazed window

Bathroom

Comprising panel enclosed bath, fitted shower, low level WC, vanity wash hand basin, radiator, heated towel rail, part tiled walls, 2 double glazed windows

Outside

Surrounding Communal Gardens

Mainly laid to lawn

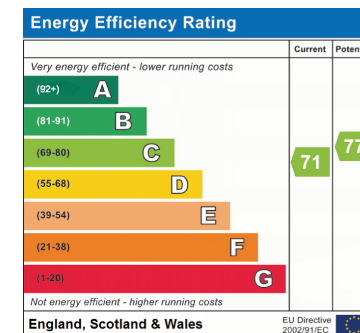

First Floor

Approx. 37.1 sq. metres (398.9 sq. feet)

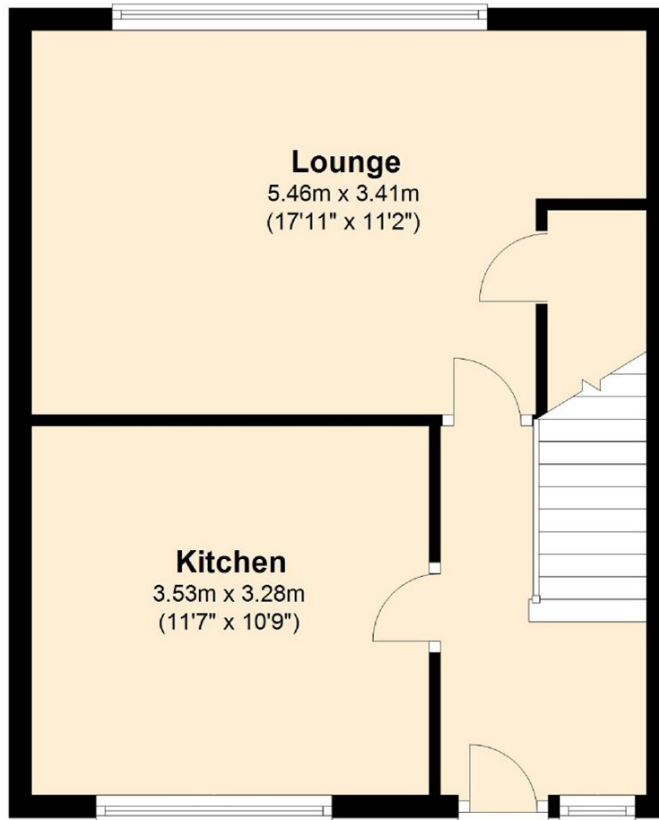

Second Floor

Approx. 37.6 sq. metres (405.2 sq. feet)

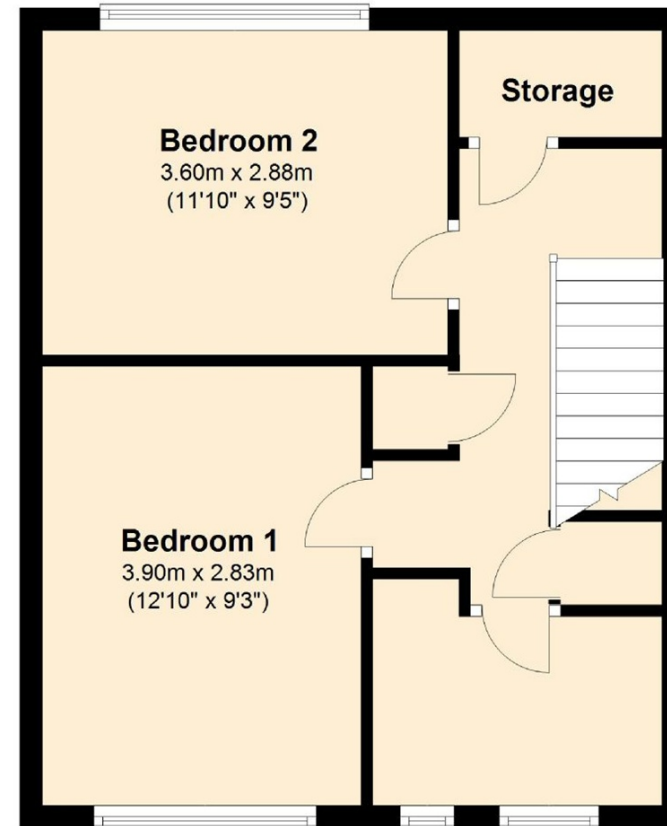

Total area: approx. 74.7 sq. metres (804.2 sq. feet)

This floorplan is for illustration purposes only and whilst Jackson Noon Estate Agents have endeavoured to ensure it is an accurate representation of the property it should not be relied upon for furnishings etc.

Plan produced using PlanUp.