



Two Bedroom Semi-Detached House  
Flamingo Close, Walderslade, Chatham, Kent, ME5 7RF

£270,000  
Freehold



# Flamingo Close, Walderslade, Chatham, Kent, ME5 7RF

£270,000

Freehold

## Description

This is an opportunity for the first time buyer to purchase this lovely two bedroom semi detached home. The current owners have well maintained and presented throughout with a new contemporary style kitchen with a range of wall and base units. Also with integrated oven and hob with extractor over and a replaced boiler. Continuing through to a good size lounge/diner which is a lovely space to unwind and chill. There is also the added benefit of the conservatory which opens onto the secluded rear garden.

Moving upstairs you have two bedrooms and a bathroom. Externally you have an enclosed rear garden with patio and lawn area. Shed to remain with side access. The allocated parking space is in the close proximity to the house. Please call the sales team for further information.

## Key Features

- Two Bedroom Semi
- Immaculate Condition Throughout
- Modern Fitted Kitchen
- Conservatory
- First Time Buyer Opportunity
- Allocated Parking
- Cul-De-Sac Position
- Close to Local Amenities

## Local Area

Walderslade is within reach of local primary and secondary schools, shopping parades, doctors surgery and dentist. Being close to Chatham and Maidstone town centres, Capstone Valley Ski and Snowboard Centre, Historic Rochester and Dockside centre plus Bluewater Shopping Centre being approximately 20 minutes away by car. The area offers good transport links to the A2/M2, M20 and M25 plus Ebbsfleet International and Ashford.

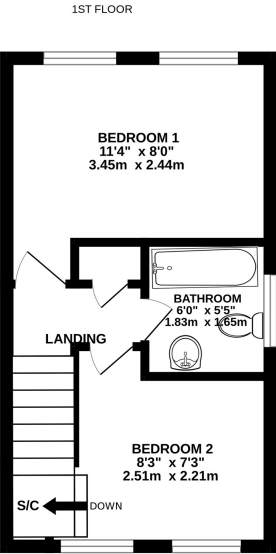
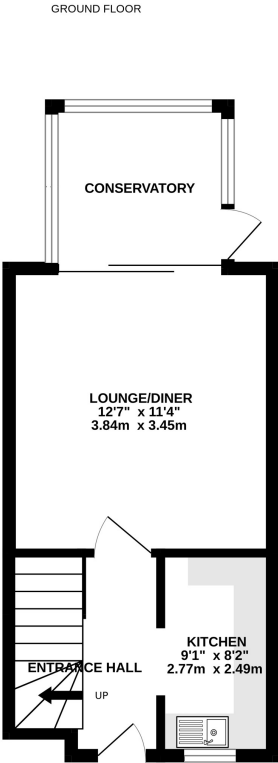





### Property Location

Flamingo Close, Walderslade, Chatham, Kent, ME5 7RF

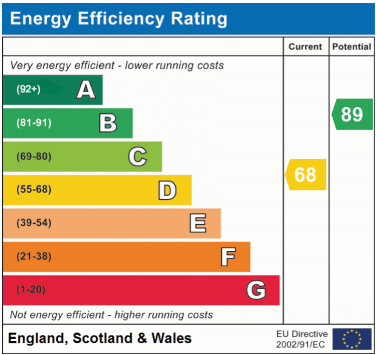

Tenure	Freehold
Lease Term	N/A
Ground Rent	N/A
Service Charge	N/A
Local Authority	Medway
Council Tax	Band B

**Greyfox Walderslade**  
Unit 2, Thetford House  
Walderslade Village Centre  
Walderslade Road  
Chatham  
Kent  
ME5 9LR  
Tel: 01634 672227 Email:  
walderslade@greyfox.co.uk

**Greyfox Rainham**  
67C High Street  
Rainham  
Kent  
ME8 7HS  
Tel: 01634 377737 Email:  
rainham@greyfox.co.uk

**Agent Notes**  
These particulars are prepared as a general guide to a broad description of the property and should not be relied upon as a statement or representation of fact and do not constitute part of an offer or contract. The seller does not make or give nor do our employees or Greyfox have authority to make or give any representation or warranty to the property. We have not carried out a structural survey and the services, appliances and specific fittings have not been tested. All photographs, measurements, floorplans and distances referred to are given as a guide only and should not be relied upon for the purchase of carpets or any other fixtures or fittings. Lease details, service charges and ground rent (where applicable) and council tax are given as a guide only and should be checked and confirmed by you on inspection and your solicitor prior to exchange of contracts. If there are any points of particular importance to you we will be pleased to check the information for you and to confirm that the property remains available. This is particularly important should you be travelling some distance to view and where statements have been made by us to the effect that the information has not been verified. The copyright of all details, photographs and floorplans remain exclusive to Greyfox. For details of our privacy policy and referral fee arrangements with any of our selected partner companies please visit <https://www.greyfox.co.uk/legal/privacy> and <https://www.greyfox.co.uk/referral-fees>.