

FOR SALE

£160,000

Cherry Tree Road, Moreton, Wirral. CH46 9RE



Perfect Starter Home! Coming to the market with no onward chain is this very well-presented three bedroom mid terrace property on the popular Cherry Tree Avenue in Moreton. Situated nearby to Leasowe Train Station, local shops and excellent schools, this is the ideal place for a young family.

To the ground floor there is an entrance porch which welcomes you into the hallway where you can then enter into the bright and airy lounge/dining room giving you an open-plan arrangement that is a nice place to entertain.





Ground Floor

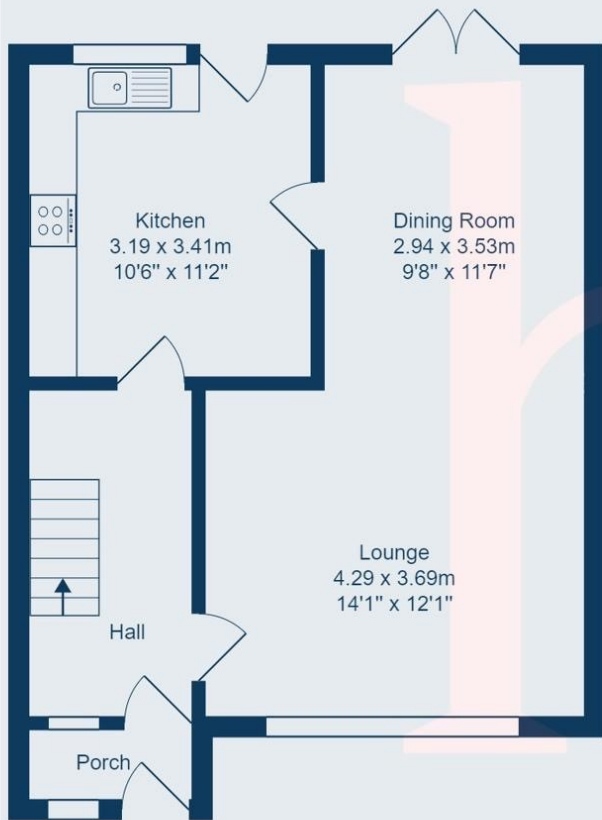

1st Floor

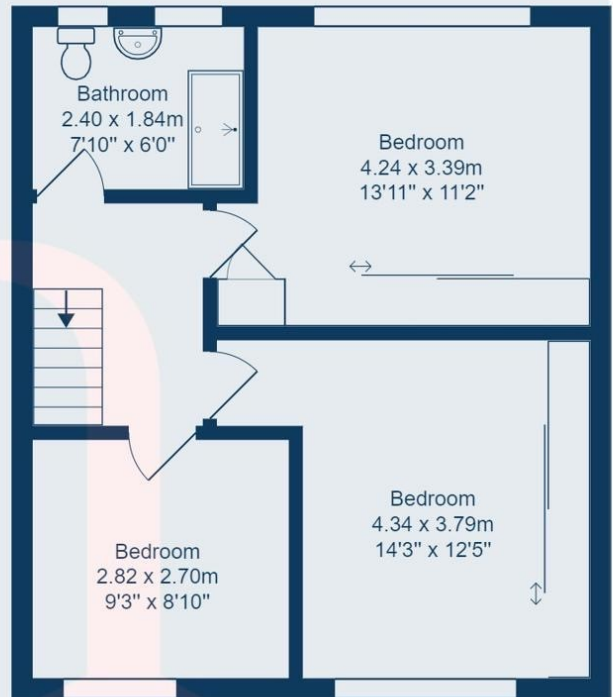

Total Area: 94.9 m² ... 1021 ft²

All measurements are approximate and for display purposes only.