

**FOR SALE**

**£350,000 Freehold**



## **5 Endeavour Road, Cheshunt, Hertfordshire. EN8 0LL**



## ABOUT THE PROPERTY

Woodhouse are pleased to offer 3-bedroom house ripe for a modernisation opportunity, and offered CHAIN-FREE.

This family home comprises of the following:- to the ground floor there is a Reception Room, Dining Room & Kitchen. To the first floor there are the 3 x Bedrooms. Externally to the rear there is a huge Garden over 100ft deep, and not overlooked from the rear. To the front you have Off-Street Parking.

Endeavour Road is just over a mile' (approx 25-30 mins walk) to Cheshunt Station which takes you straight into Liverpool St in about 20 minutes. You are in walking distance not only to the shops & eateries of the High Street but also Brookfield Centre with all of its amenities there. For road links, the A10 / M25 are minutes away. There are a number of highly-regarded schools in the vicinity too.

If you're looking for a project to update to your own tastes, contact us today to come and see the potential of this house for you!

## FEATURES

- CHAIN-FREE
- Modernisation Opportunity
- 3 Bedrooms
- 2 x Reception Rooms
- Huge Garden
- Off-street Parking
- High Street & Brookfield amenities nearby
- Popular schools at hand
- Approx 25-30 min walk to the station



## ROOM DESCRIPTIONS

### SALES DISCLAIMER

Services, fixtures and fittings haven't been tested.

All measurements are approximate.

Your solicitor will confirm tenure and any other legal information.

As required by Money Laundering Regulations, should your offer be accepted, we will require proof of identity & funds.



# FLOORPLAN

GROUND FLOOR  
437 sq.ft. (40.6 sq.m.) approx.

1ST FLOOR  
284 sq.ft. (26.4 sq.m.) approx.

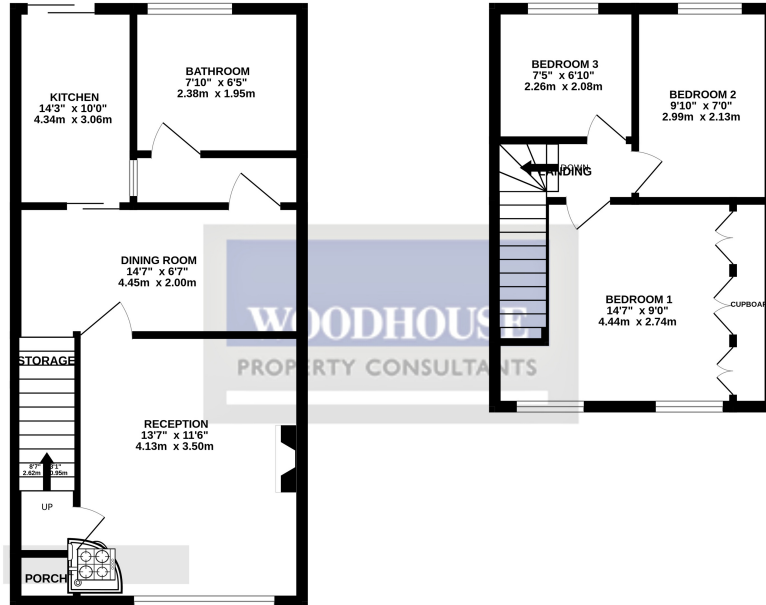

TOTAL FLOOR AREA: 721 sq.ft. (67.0 sq.m.) approx.

Whilst every attempt has been made to ensure the accuracy of the floorplan contained here, measurements of doors, windows, rooms and any other items are approximate and no responsibility is taken for any error, omission or mis-statement. This plan is for illustrative purposes only and should be used as such by any prospective purchaser. The services, systems and appliances shown have not been tested and no guarantee as to their operability or efficiency can be given.  
Made with Netoplan 12025