

FOR
SALE



Little Oast, 2 Pantalls Farm Sutton St Nicholas, Hereford HR1 3BB

£225,000 - Freehold

22, Broad Street, Hereford, HR4 9AP 01432 355455 hereford@flintandcook.co.uk

PROPERTY SUMMARY

Peacefully situated in this popular village location, a charming Grade II Listed 2-bedroom character property. The property has the added benefit of gas central heating, 2 good-size bedrooms, an enclosed garden, wealth of character and we recommend an internal inspection.

POINTS OF INTEREST

- *Popular village location*
- *Charming 3-storey house*
- *2 good-size bedrooms*
- *Wealth of character*
- *Ideal first-time buyer or retirement*
- *Must be viewed*



ROOM DESCRIPTIONS

Kitchen

Approached through entrance door with glazed side windows, with 1 1/2 bowl sink unit, range of wall and base cupboards, solid wood worksurfaces, tiled floor, radiator, wall mounted gas central heating boiler, double-glazed window to rear, space for cooker with splashback and cooker hood over, space for upright fridge/freezer, space with plumbing for washing machine, built-in dishwasher, central lighting, carpeted staircase to first floor, pantry-style cupboard with pull-out shelving, door with carpeted steps, leading to the

Living room

A light and airy room with fitted carpet, radiator with display shelf over, double-glazed window to front, range of lighting, TV aerial point, glazed panelled double doors to rear.

First floor landing

Fitted carpet, radiator with display shelf over, Velux rooflight, built-in store/airing cupboard with shelving, door to

Bathroom

Suite comprising panelled bath with tiled surround, shower unit over with glazed folding doors, low flush WC, pedestal wash hand basin with utensil shelf and mirror-fronted medicine cabinet over, radiator, tiled wall surrounds for easy maintenance, Velux rooflight.

Bedroom 1

Fitted carpet, radiator, double-glazed window to front enjoying a pleasant outlook, large built-in double wardrobe with mirrored sliding doors.

Study/dressing room

Fitted carpet, radiator, double-glazed window to rear, built-in double wardrobe with mirror-sliding doors, spiral staircase to

Second floor bedroom 2

Fitted carpet, exposed timbers, radiator, rooflight to front with blind, range of lighting, vanity wash hand basin with storage below, splashback

and mirror over, and an en-suite Shower Room/WC.

Outside

There is a small paved patio to the rear.

To the front of the property there is an attractive, enclosed, garden perfect for table and chairs, and entertaining.

Services

Mains electricity, gas and water are connected. Gas-fired central heating.

Outgoings

Council tax band C, payable 2024/25 £2074.79. Water and drainage rates are payable.

Directions

Proceed north out of Hereford along Commercial Road, crossing over Aylestone Hill and at the bottom take the 2nd exit on the roundabout to Sutton St Nicholas. On entering the village, turn right at the crossroads and then 2nd right by the Church. After approximately 250 yards, Pantalls Farm is on the left-hand side.

Viewing

Strictly by appointment through the Agent, Flint & Cook, 01432 355455.

Money laundering regulations

Prospective purchasers are required to provide address verification, identification and proof of funds at the time of making an offer.

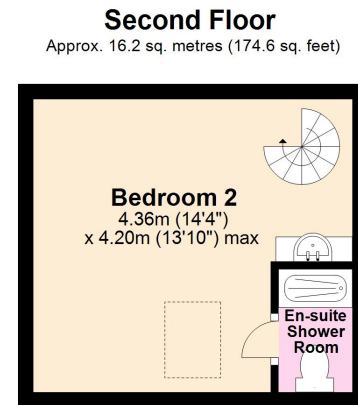
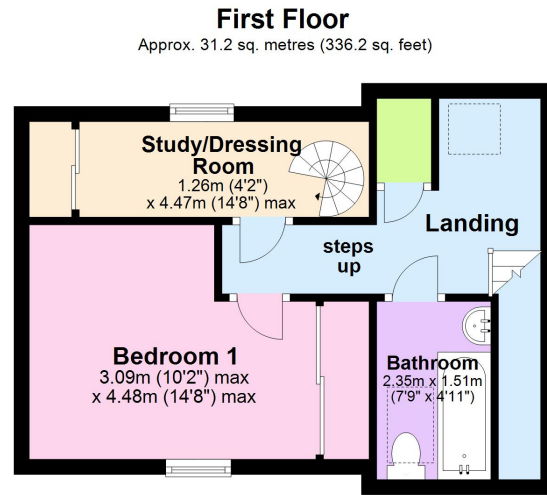
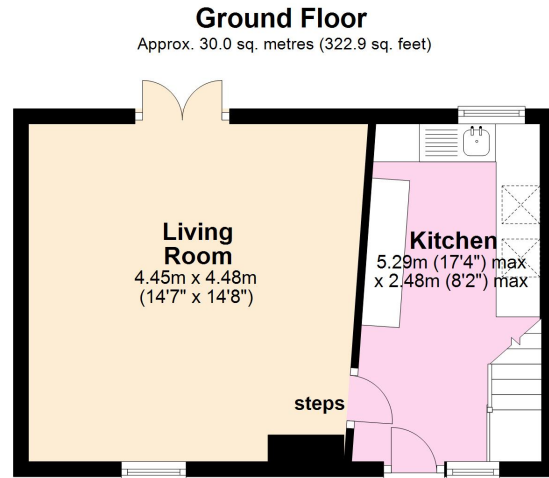

Total area: approx. 77.5 sq. metres (833.8 sq. feet)

These plans are for identification and reference only.
Plan produced using PlanUp.

Little Oast, 2 Pantalls Farm, Sutton St Nicholas, Hereford

These particulars are prepared for the guidance only of prospective purchasers. They are intended to give a fair and overall description of the property and do not constitute the whole or any part of an offer or contract. Any information contained herein (whether in text, plans or photographs) is given in good faith but should not be relied upon as being a statement or representation of fact. Any plans provided by the agents and/or with the sales particulars are intended for guidance purposes only; we cannot guarantee the accuracy and scale of any plans, and they do not form any part of the sales contract. Nothing in these particulars shall be deemed to be a statement that the property is in good condition or otherwise nor that any services or facilities are in good working order. Any movable contents, fixtures and fittings, (whether wired or not) referred to in these property particulars (including any shown in the photographs) are, unless the particulars say otherwise, excluded from the sale. In the event that the buyer proposes to purchase any movable contents or include them in any offer for the property, the buyer cannot in any respect imply any such inclusion from the property particulars. Any areas, measurements or distances referred to herein are approximate only and may be subject to amendment. It should not be assumed that the property has all necessary planning, building regulation or other consents and these matters must be verified by an intending purchaser. The information in these particulars is given without responsibility on the part of the agents or their clients and neither the agents nor their employees have any authority to make or give any representations or warranties whatever in relation to this property.

Flint & Cook Privacy Statement: We take your privacy very seriously. Your data will not be shared with any other parties without your express permission. Our Data protection Policy can be read in full on the Flint & Cook website, www.flintandcook.co.uk