



67 Buttermere Drive, CAMBERLEY, Surrey GU15 1RB

OFFERS IN EXCESS OF £550,000

**** NO ONWARD CHAIN ****

Jigsaw Estates are proud to offer this detached family home, situated towards the end of a cul-de-sac on the ever popular Heatherside development. First floor accommodation comprises four bedrooms (three of which have built in wardrobes), en-suite shower room to the main bedroom and a family bathroom. Downstairs there are three reception rooms including a living room, dining room and a family room (which is the garage conversion). There is also the kitchen which has access to the garden and through to the family room. The cloakroom has also been re-fitted.

To the outside the garden is of a westerly orientation and has a patio area leading onto the lawned area. The driveway also provides parking for two cars.

COUNCIL TAX BAND - F



- NO ONWARD CHAIN
- FOUR BEDROOMS
- FAMILY BATHROOM
- LOUNGE & DINING ROOM
- WESTERLY FACING GARDEN

- END OF QUIET CUL-DE-SAC ON POPULAR HEATHERSIDE DEVELOPMENT
- EN-SUITE SHOWER ROOM
- REFITTED CLOAKROOM
- GARAGE CONVERSION PROVIDING A FAMILY ROOM
- DRIVEWAY FOR 2 CARS

Ground Floor

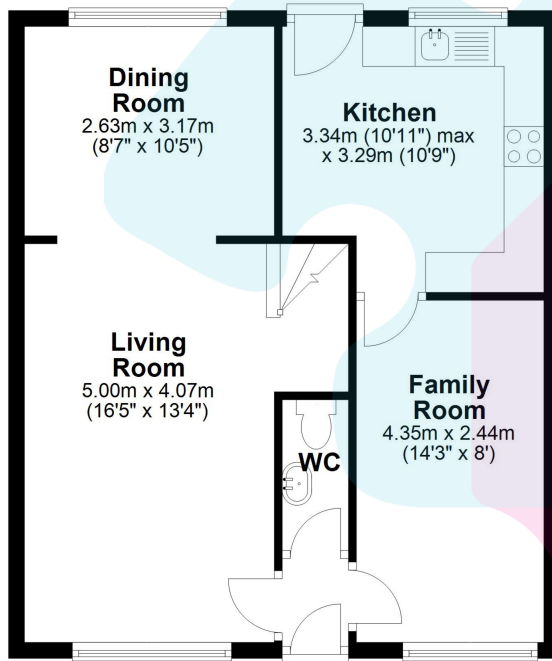

First Floor

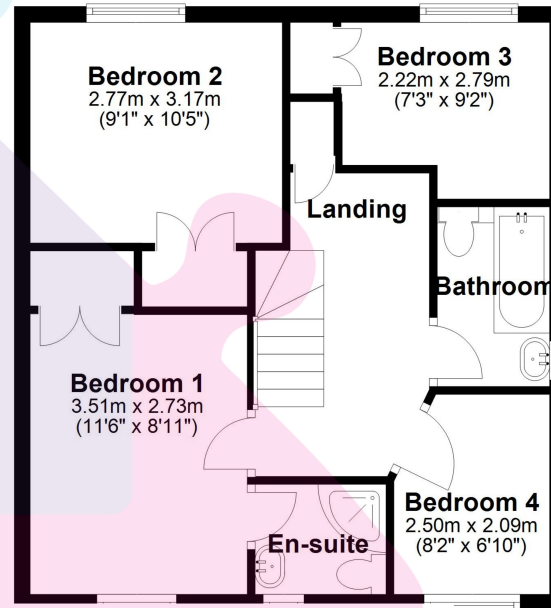

Floorplan is for illustration purposes only. All measurements are approximate and should be verified. Total Floor Area includes any garages, outhouses or ancillary buildings shown on the floorplan.
EPC and Floorplan produced by WWW.G-Whis.net
Plan produced using PlanUp.

Energy Efficiency Rating		
	Current	Potential
Very energy efficient - lower running costs		
(92+) A		83
(81-91) B		
(69-80) C		
(55-68) D	65	
(39-54) E		
(21-38) F		
(1-20) G		
Not energy efficient - higher running costs		
England, Scotland & Wales		EU Directive 2002/91/EC

