

Truuli



Queen Street, Croydon, Surrey, CR0

£375,000 Freehold

- Two double bedrooms
- Built-in storage in various rooms
- Period features
- South facing garden
- Hive heating system installed
- Double glazed windows throughout
- Close to Croydon Town Centre

2, Lansdowne Road, Croydon, Surrey, CR9 2ER

Tel: 0330 043 0002

Email: save@truuli.co.uk Web: www.truuli.co.uk

Queen Street, Croydon, Surrey, CR0

£375,000 Freehold

Vendor's comments: "Queen Street was the first house we bought together and has provided five years of happy memories. We moved here as a newly married couple but now, having grown our family, it's time to make some new memories elsewhere."

Ground Floor
347 sq.ft. (32.3 sq.m.) approx.

1st Floor
237 sq.ft. (22.0 sq.m.) approx.

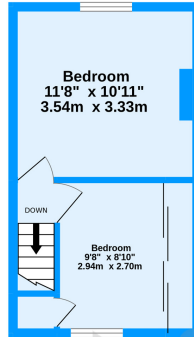
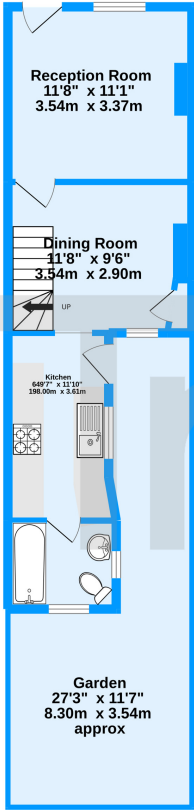

Queen Street, Croydon, CR0

TOTAL FLOOR AREA: 584 sq.ft. (54.3 sq.m.) approx.

Whilst every attempt has been made to ensure the accuracy of the floorplan contained here, measurements of doors, windows, rooms and any other items are approximate and no responsibility is taken for any error, omission or mis-statement. This plan is for illustrative purposes only and should be used as such by any prospective purchaser. The services, systems and appliances shown have not been tested and no guarantee as to their operability or efficiency can be given.
Made with Metropix ©2022

Energy Efficiency Rating		Current	Potential
Very energy efficient - lower running costs			
(92-100) A			
(81-91) B			84
(69-80) C			
(55-68) D		62	
(39-54) E			
(21-38) F			
(1-20) G			
Not energy efficient - higher running costs			
England, Scotland & Wales		EU Directive 2002/91/EC	

