



THE ESTATE AGENTS  
1977





**Lower Hester Street, Northampton NN2 6BL**  
**Offers Over £200,000 - Freehold**



## PROPERTY DESCRIPTION

The Estate Agents are pleased to present this well presented 4 bedroom licenced House of multiple occupation in a popular area close to Northampton Train Station and Town centre. The accommodation briefly comprises; entrance hall, communal living room, bedroom, kitchen, bathroom and cellar, on the first floor are three further bedrooms. Outside the property benefits from a low maintenance rear garden.

Semilong has been a hot spot for some time in Northampton given its proximity to local amenities, town centre and Northampton train station which has a regular service to London Euston taking under an hour.

## POINTS OF INTEREST

- Four Bedroom HMO
- Well Presented
- Licenced
- Communal Living Room
- Cellar
- Rear Garden
- Vacant Possession
- Superb Investment

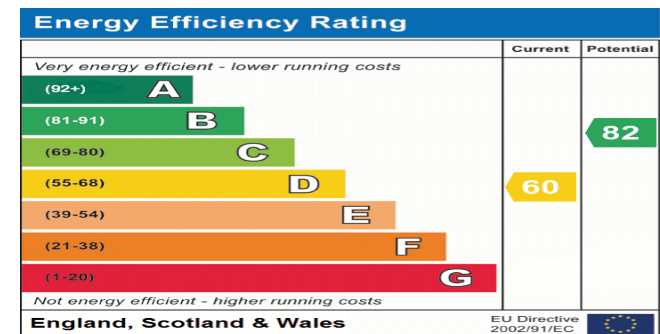

BASEMENT  
158 sq.ft. (14.7 sq.m.) approx.

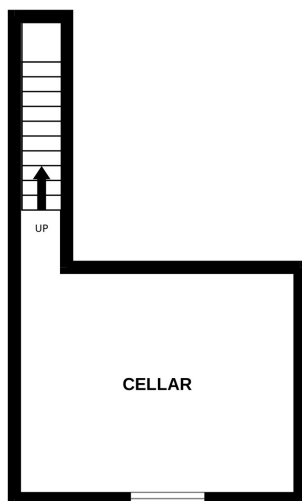

GROUND FLOOR  
390 sq.ft. (36.2 sq.m.) approx.

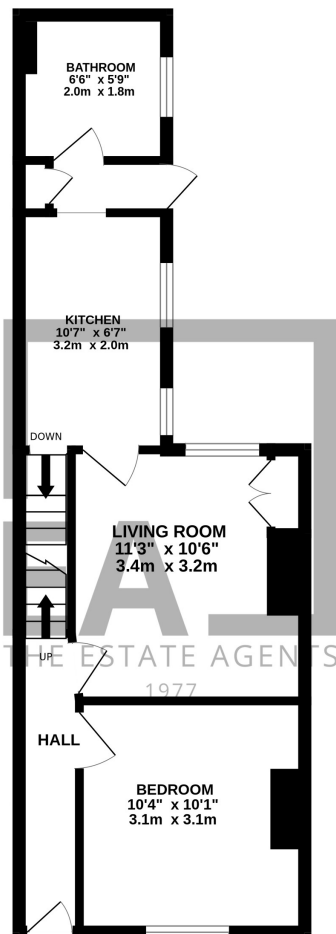

1ST FLOOR  
350 sq.ft. (32.5 sq.m.) approx.

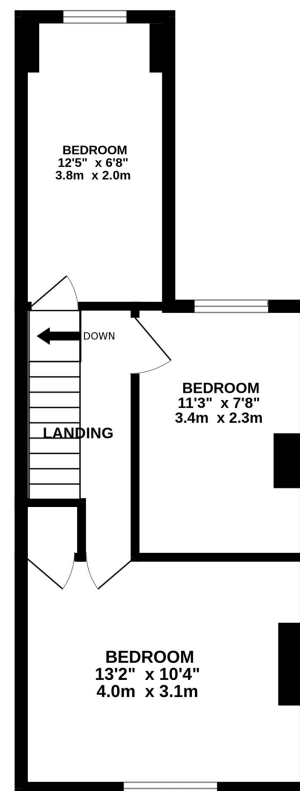

TOTAL FLOOR AREA : 898 sq.ft. (83.4 sq.m.) approx.

Whilst every attempt has been made to ensure the accuracy of the floorplan contained here, measurements of doors, windows, rooms and any other items are approximate and no responsibility is taken for any error, omission or mis-statement. This plan is for illustrative purposes only and should be used as such by any prospective purchaser. The services, systems and appliances shown have not been tested and no guarantee as to their operability or efficiency can be given.  
Made with Metropix ©2025