

Becquerel Court, West Parkside, London, SE10 0QA

£1,550 PCM

Superbly located two bedroom apartment situated in the heart of Greenwich Millennium Village. The property briefly comprises two double bedrooms, spacious open plan living room/kitchen, bathroom and secure allocated parking space. The apartment is located moments from the O2 Arena, excellent transport links and benefits from a 24 hour concierge service. Offered furnished

Viewing by appointment with 1st avenue.

Call: 020 8293 8600

1st avenue, 128 Metcalfe Court, West Parkside, London SE10 0EL
email: info@1stavenue.co.uk

Becquerel Court, West Parkside, London, SE10 0QA

£1,550 PCM

1stavenue
Real Estate Services

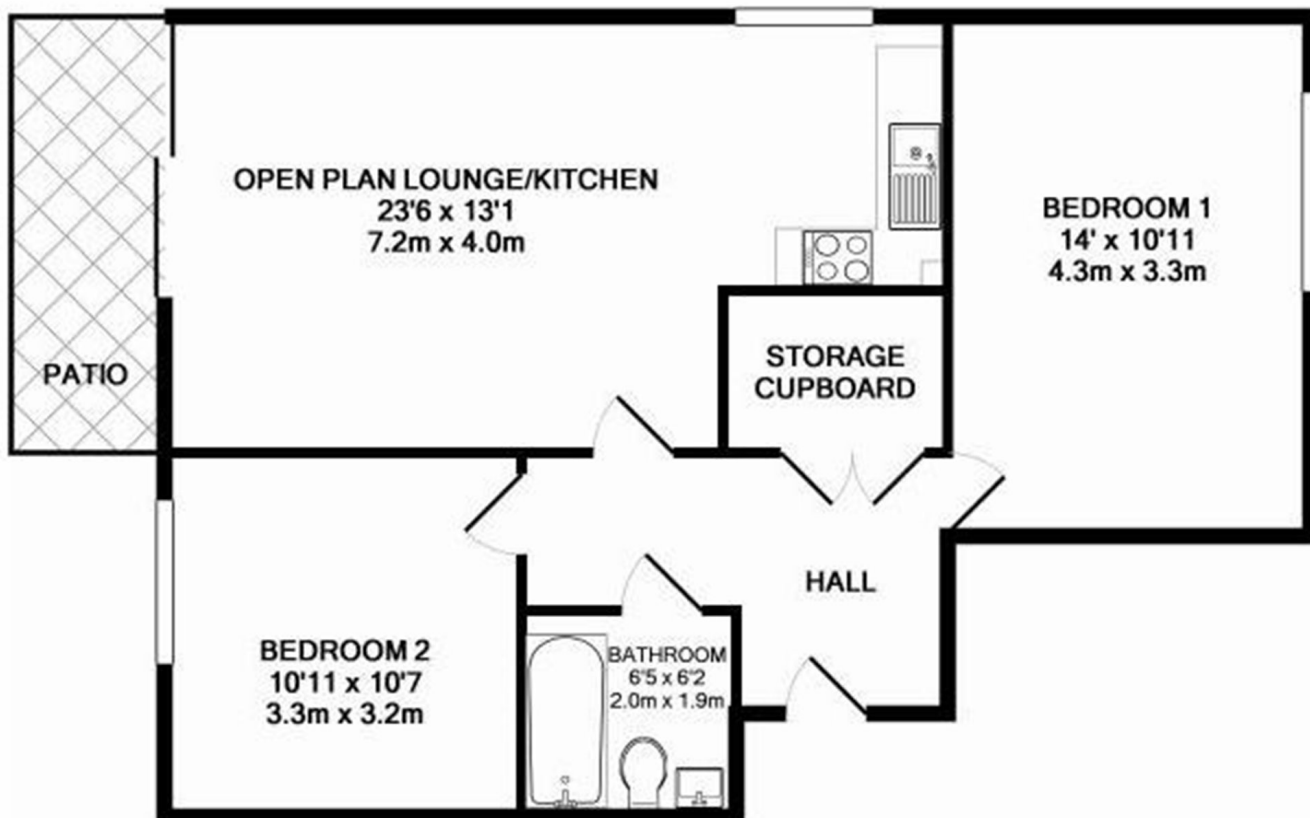

TOTAL APPROX. FLOOR AREA 711 SQ.FT. (66.1 SQ.M.)

THIS FLOOR PLAN SHOULD BE USED AS A GENERAL OUTLINE FOR GUIDANCE ONLY AND DOES NOT CONSTITUTE IN WHOLE OR IN PART AN OFFER OR CONTRACT. ANY INTENDING PURCHASER OR LESSEE SHOULD SATISFY THEMSELVES BY INSPECTION, SEARCHES, ENQUIRES AND FULL SURVEY AS TO THE CORRECTNESS OF EACH STATEMENT. ANY AREAS, DISTANCES OR MEASUREMENTS QUOTED ARE APPROXIMATE AND SHOULD NOT BE USED TO VALUE A PROPERTY OR BE THE BASIS OF ANY SALE OR LET.

Made with Metropix ©2018

Viewing by appointment with 1st avenue.

Call: 020 8293 8600

1st avenue, 128 Metcalfe Court, West Parkside, London SE10 0EL
email: info@1stavenue.co.uk

1stavenue
Real Estate Services