



5 Old Vicarage Gardens, Henlow, Bedfordshire, SG16 6AD

£595,000

Four bedroom detached property situated in this small select walled courtyard setting in the heart of Henlow within walking distance of all local amenities, good schooling, the park and the train station. This well presented family home offers bright spacious accommodation with an open plan kitchen/dining room, sitting room with log burner and adjoining conservatory and four bedrooms. Off road parking for numerous cars is provided by a driveway and detached double garage and the gardens enjoy a southerly aspect.



- FOUR BEDROOM DETACHED HOUSE
- PRIVATE WALLED COURTYARD SETTING
- IN THE HEART OF HENLOW CLOSE TO LOCAL AMENITIES
- BRIGHT & WELL PRESENTED ACCOMMODATION
- LOUNGE WITH LOG BURNER + CONSERVATORY
- OPEN PLAN QUALITY KITCHEN/DINING ROOM
- GRANITE WORK TOPS
- SOUTH FACING REAR GARDEN
- AMPLE OFF ROAD PARKING + DOUBLE GARAGE WITH ELECTRIC DOORS
- WALKING DISTANCE OF ARLESEY RAILWAY STATION
- COUNCIL TAX BAND F / EPC TBC

Approximate Gross Internal Area  
 Ground Floor = 79.9 sq m / 860 sq ft  
 First Floor = 59.0 sq m / 635 sq ft  
 Garage = 26.0 sq m / 280 sq ft  
 Total = 164.9 sq m / 1,775 sq ft

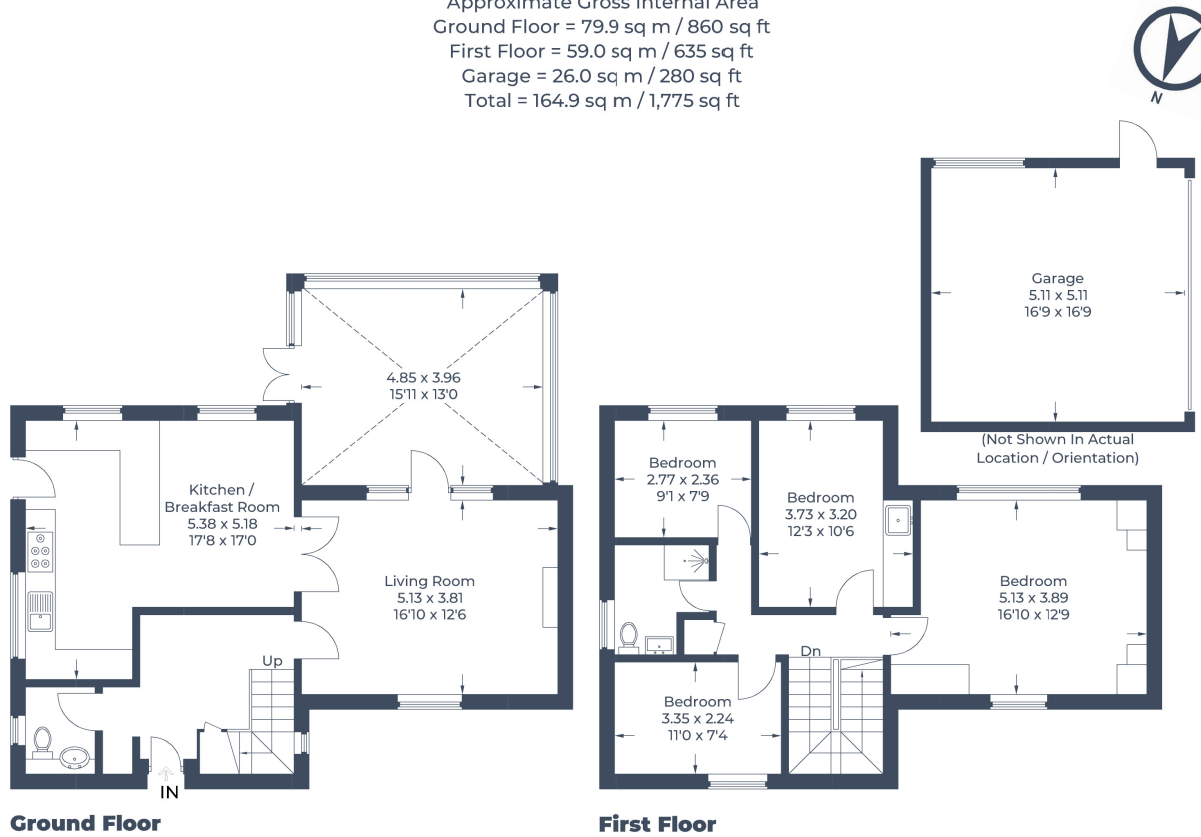

Illustration for identification purposes only,  
 measurements are approximate, not to scale.  
 © CJ Property Marketing Produced for Lane & Bennetts