

FOR
SALE



71 Medway Drive, Perivale, Greenford, Greater London UB6 8LW

£530,000 - Freehold

**Peter
Gamble & Co**
Estate agents since 1979

86, Bilton Road, Perivale, Greenford, UB6 7BN 020 8998 4000 sales@petergamble.com

PROPERTY SUMMARY

Peter Gamble & Co. proudly offer to the market for CHAIN FREE SALE this very well presented 3 BEDROOM, 1 BATHROOM terraced home.

Situated on one of the most popular streets within Perivales' Medway Village this lovely home boasts a very comfortable layout and excellent future potential.

To the ground floor the property comprises a bright dual aspect thru-lounge with bay window, wooden flooring and sliding door leading onto the long WEST FACING rear garden with benefits from full vehicular access to the rear.

The separate kitchen has been refreshed also with its own door onto the garden.

To the first floor are the 3 bedrooms and the family bathroom.

Central heating has been renewed to a modern combi system (Worcester Bosch) and the property is fully double glazed.

Local OUTSTANDING primary school Selborne Primary is just moments away along with bus routes, local convenience stores and Perivale Tube station less than 10 minutes walk from the front door!

Get in touch to book your viewing!



POINTS OF INTEREST

- MODERN CENTRAL HEATING
- LONG WEST FACING GARDEN
- BRIGHT THRU-LOUNGE
- CHAIN FREE SALE
- EXCELLENT FUTURE POTENTIAL TO EXTEND



ROOM DESCRIPTIONS

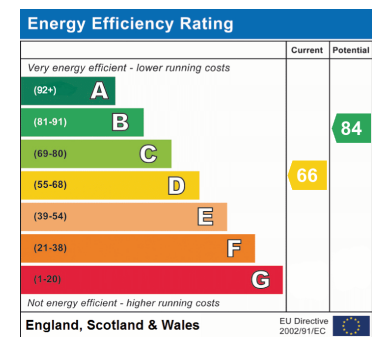

Approximate Gross Internal Area 797 sq ft - 74 sq m

Ground Floor Area 378 sq ft – 35 sq m

First Floor Area 373 sq ft – 35 sq m

Outbuilding Area 46 sq ft – 4 sq m

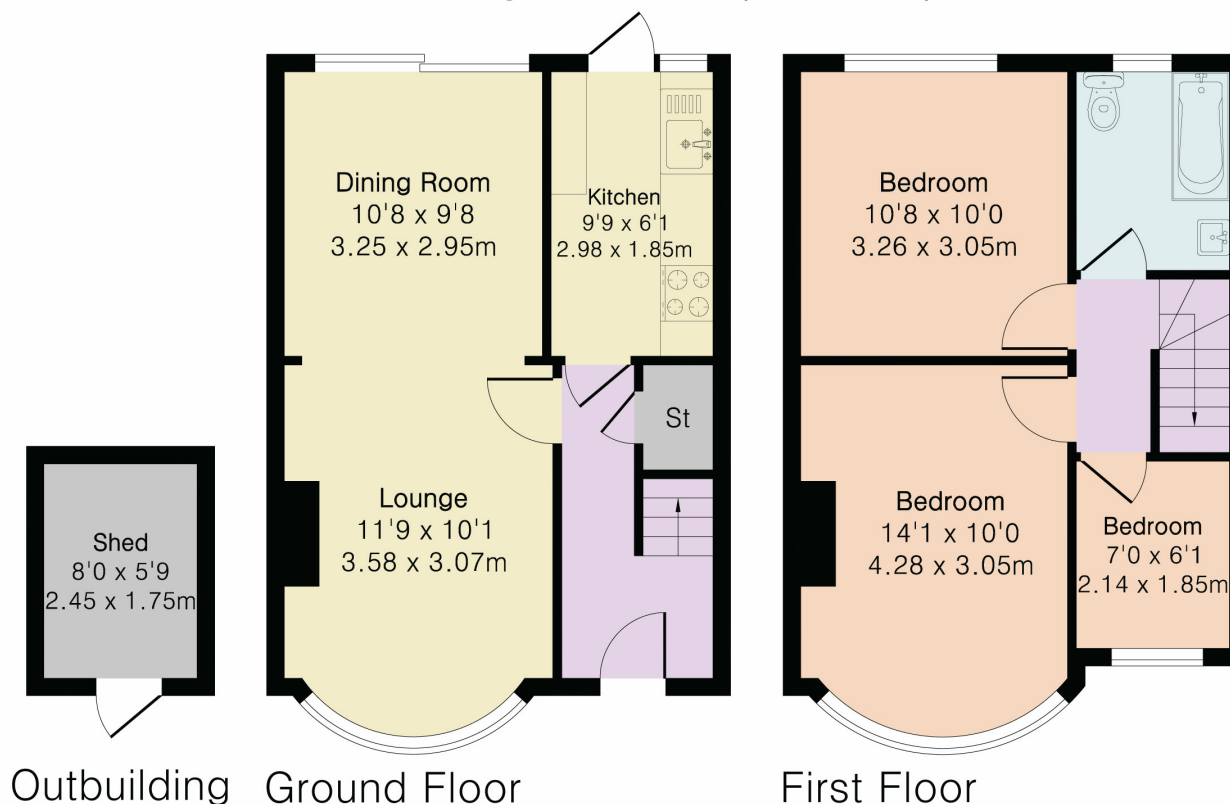

Although Pink Plan Ltd ensures the highest level of accuracy, measurements of doors, windows and rooms are approximate and no responsibility is taken for error, omission or misstatement. These plans are for representation purposes only as defined by RICS code of measuring practise. No guarantee is given on total square footage of the property within this plan. The figure icon is for initial guidance only and should not be relied on as a basis of valuation.

