

Walton Close

Glastonbury, BA6 9GL

COOPER
AND
TANNER



£325,000 Freehold

🚗 3 🛋️ 1 🚿 2 EPC C

Description

Overlooking a small coppice, this immaculately presented home benefits from three bedrooms, a beautifully presented garden with summerhouse, and off-road parking. The accommodation comprises an open plan kitchen/diner, dual aspect sitting room with French doors to the rear garden, entrance hallway with storage, and cloakroom WC. Three bedrooms, one with storage and an en-suite shower room, and the family bathroom are located on the first floor. Driveway parking is situated to side of the property, leading to a single garage with power, and pedestrian side access to the garden. The enclosed rear garden features a generous patio and an artificial lawn bordered by shingle and mature plants and shrubs.

GROUND FLOOR

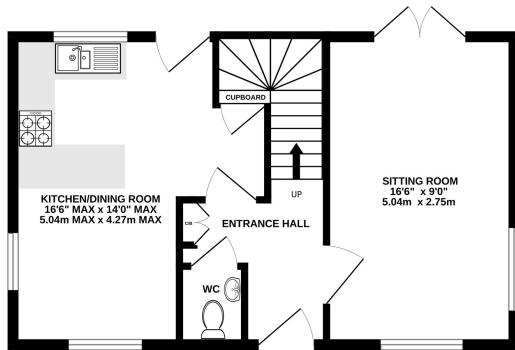

1ST FLOOR

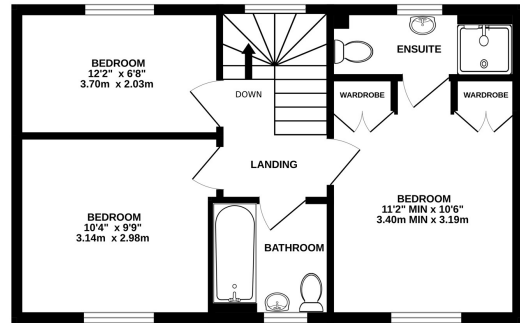

Whilst every attempt has been made to ensure the accuracy of the floorplan contained here, measurements of doors, windows, rooms and any other items are approximate and no responsibility is taken for any error, omission or mis-statement. This plan is for illustrative purposes only and should be used as such by any prospective purchaser. The services, systems and appliances shown have not been tested and no guarantee as to their operability or efficiency can be given.
Made with Metropix ©2024



Features

- Immaculately presented DETACHED home
- Approximately 1 year NHBC remaining
- Overlooking a small coppice
- Open plan kitchen/dining room
- En-suite shower room and cloakroom WC
- Attractive, walled rear garden, with Summerhouse
- OFF ROAD PARKING and a single garage
- Freehold - Council Tax Band D
- Management fees will apply for this development, to cover maintenance costs for communal gardens etc.

Local Information

- Council Tax Band D
- Tenure Freehold
- EPC Rating C

GLASTONBURY OFFICE

Telephone 01458 831077

41, High Street, Glastonbury, Somerset BA6 9DS

glastonbury@cooperandtanner.co.uk

**COOPER
AND
TANNER**

Important Notice: These particulars are set out as a general outline only for the guidance of intended purchasers and do not constitute, nor constitute part of, an offer or contract. All descriptions, dimensions, reference to condition and necessary permissions for use and occupation, warranties and other details are given without responsibility and any intending purchasers should not rely on the m as statements or representations of fact but must satisfy themselves by inspection or otherwise as to the correctness of each of them.

