



Bromyard Avenue, London, W3 7FG

Cow & Co
LONDON



Guide Price £300,000 to £350,000. A beautifully presented one bedroom apartment on the borders of Acton and Shepherds Bush. The property has stylish open-plan living with impressive ceiling heights and great natural light.

The property is located in the renowned Bromyard House building, a Berkeley Homes development. Situated within close proximity to two outstanding health and fitness clubs and several parks. East Acton tube (Central line), Acton Central (Overground) and Acton Main Line (Elizabeth line) stations are all within easy reach.

This fantastic property is offered to the market chain free. Must view internally!



- Modern one bedroom apartment in Edwardian building.
- Set in a quiet, secure gated development
- Open plan kitchen living area
- 24 Hour Concierge Service
- Generous sized bedroom
- Communal Garden
- Easy Access to Heathrow and transport links into central London
- Excellent amenities nearby
- Chain free

Bromyard Avenue, London, W3

Approximate Area = 442 sq ft / 41 sq m

For identification only - Not to scale

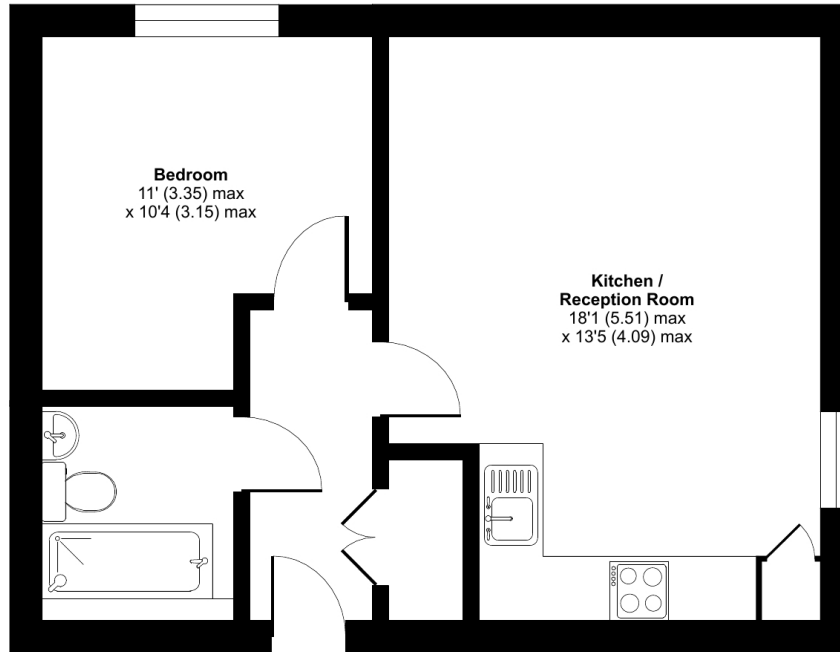

FIRST FLOOR



Floor plan produced in accordance with RICS Property Measurement Standards incorporating International Property Measurement Standards (IPMS2 Residential). © nchecon 2023. Produced for Cow & Co Properties Ltd. REF: 1013919

Tel: 0208 065 0010
Email: thehub@cowandco-london.com
Web: cowandco-london.com

Agents note: All measurements are approximate and whilst every attempt has been made to ensure accuracy they are for general guidance only and must not be relied on. The fixture and fittings referred to have not been tested and therefore no guarantee can be given that they are in working order. Internal photographs are reproduced for general information and it must not be inferred that any item shown is included with the property.

Cow & Co

LONDON