

Approx Gross Internal Area
86 sq m / 931 sq ft

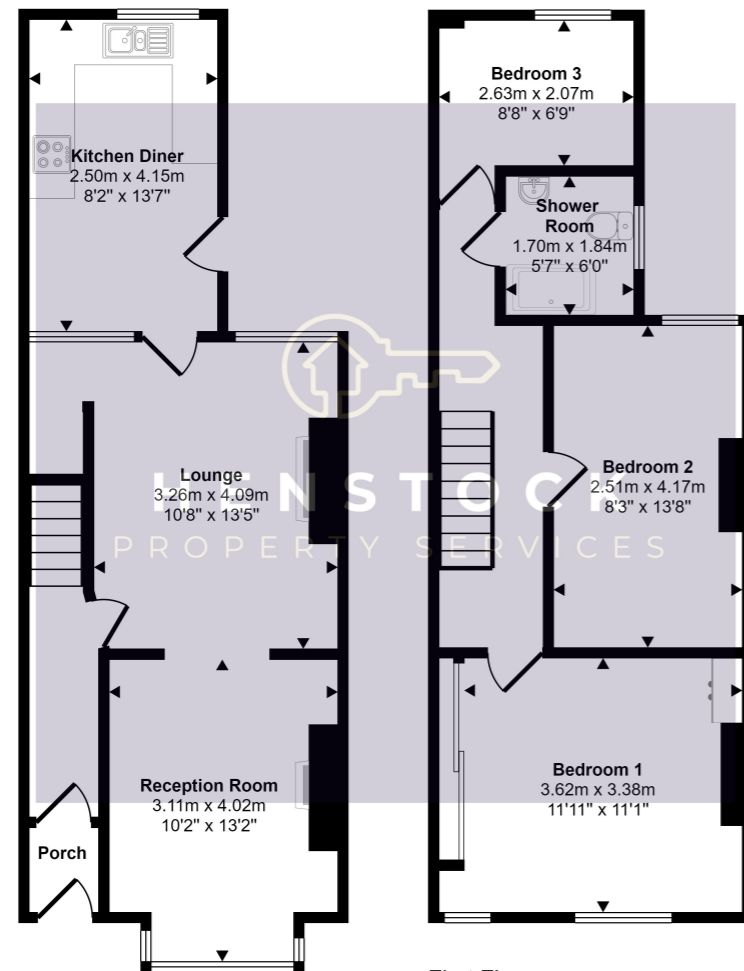

Ground Floor
Approx 44 sq m / 470 sq ft

First Floor
Approx 43 sq m / 461 sq ft

This floorplan is only for illustrative purposes and is not to scale. Measurements of rooms, doors, windows, and any items are approximate and no responsibility is taken for any error, omission or mis-statement. Icons of items such as bathroom suites are representations only and may not look like the real items. Made with Made Snappy 360.



HENSTOCK
PROPERTY SERVICES



18 Russet Road, Blackley, Manchester, Lancashire M9 8BN

- 3 BEDROOMED TERRACED
- NO CHAIN
- FREEHOLD
- COUNCIL TAX BAND A
- GAS CENTRAL HEATING

Offers in Region of £175,000



PROPERTY DESCRIPTION

Henstock Property Services are pleased to market this 3 bedroomed mid terraced home. The living accommodation briefly comprises; entrance hallway, front lounge, dining room, fitted kitchen/diner, 3 bedrooms and a shower room. The property also has the benefit of gas central heating, mostly double glazed windows and a rear garden/yard. Ideally situated within easy reach of schools, shops/supermarkets, leisure/fitness facilities, good public transport services and a short distance from the M60 & M62 motorway links.

PLEASE NOTE: Anything left in the property on completion must be dealt with by the purchaser.

GROUND FLOOR

Entrance

Hallway with oak effect laminate flooring, single radiator.

Front Lounge

Views to front, central feature brick built surround, freestanding gas fire, arch to dining room, double radiator.

Dining Room

Views to rear, slate fire surround, freestanding gas fire, arch to front lounge, under stair storage, single radiator.

Kitchen/Diner

Views to rear, cream units with butchers block worktops, built in single electric oven, 4 ring gas hob, 1 1/2 bowl stainless steel sink with chrome mixer tap, part tiled walls, room for dining suite, door to rear garden, single radiator.

FIRST FLOOR

Bedroom 1

Views to front, built in sliding door with central mirror panelled wardrobe, single radiator.

Bedroom 2

Views to rear, single radiator.

Bedroom 3

Single radiator.

Shower Room

White suite comprising; double walk in shower cubicle, wall mounted electric shower, close coupled w.c, sink, fully tiled walls, oak effect flooring, chrome heated towel rail.

Exterior

Paved rear yard with planted raised beds and brick built store.

