

FOR SALE

£675,000

Kingsmead Way, Meols, Wirral. CH47 0NP



STUNNING SPACIOUS MODERN DETACHED HOME!! Built only two years ago Kingsmead Way is one of Castle Greens' Signature Collection developments, centred on exclusive homes in private, sought-after locations that are built using the very latest technologies and quality materials, finished with high-end fixtures and fittings. This latest addition to the local market was one of the larger style homes on the site. Being positioned on a prime plot this particular example is a real show stopper, with multiple upgrades throughout and immaculate presentation, making it the perfect family home. Located in a sought-after part of Meols in close proximity to many fine cafes, restaurants and bars; within easy access to excellent schools, shops and amenities plus a wealth of strong transport connections into Liverpool and across the North West. We're expecting strong early interest in this beautiful modern home and encourage a viewing so as not to miss out.











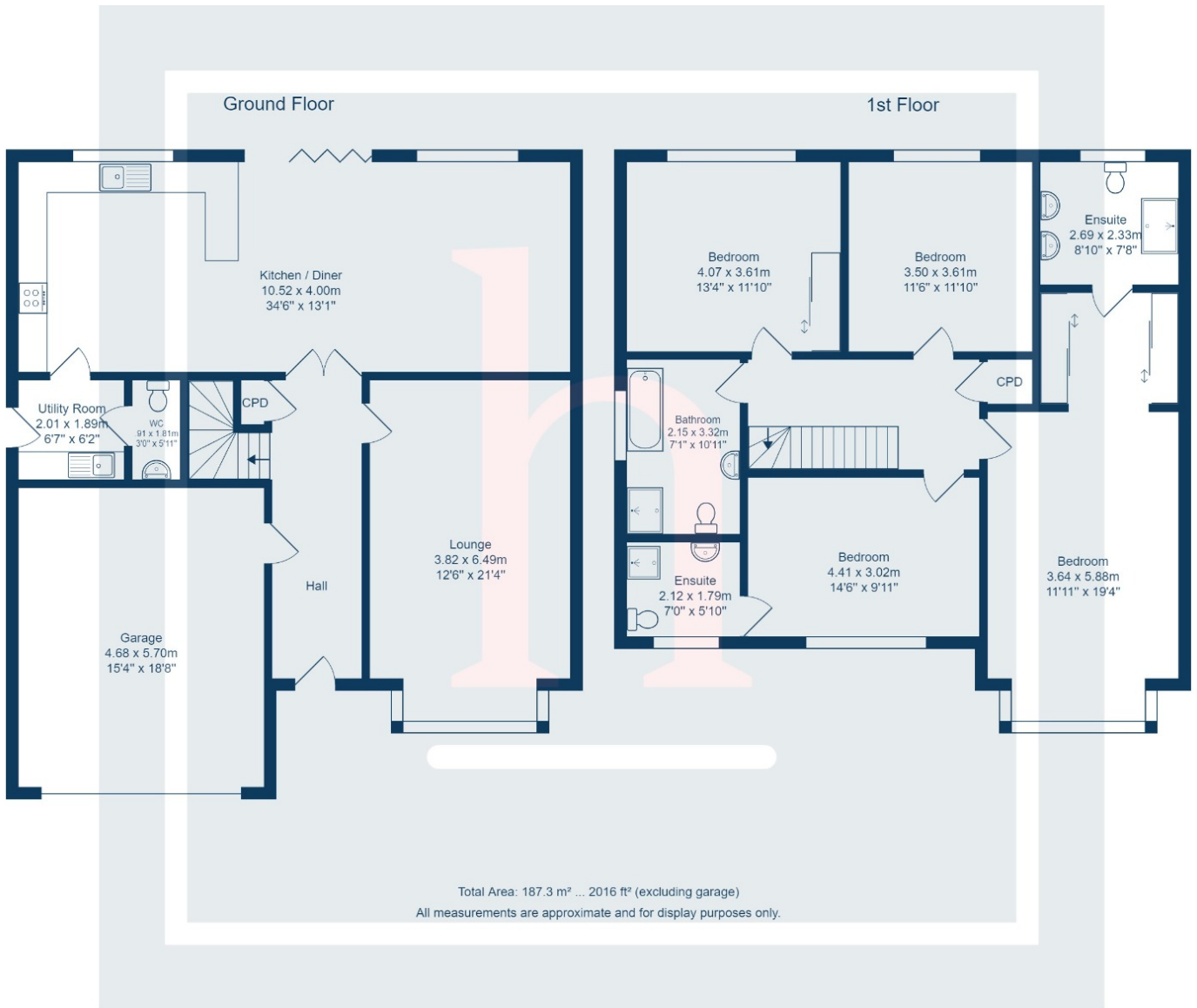

Energy Efficiency Rating		Current	Potential
<i>Very energy efficient - lower running costs</i>			
(92+)	<b>A</b>		92
(81-91)	<b>B</b>	85	
(69-80)	<b>C</b>		
(55-68)	<b>D</b>		
(39-54)	<b>E</b>		
(21-38)	<b>F</b>		
(1-20)	<b>G</b>		
<i>Not energy efficient - higher running costs</i>			
<b>England, Scotland &amp; Wales</b>		EU Directive 2002/91/EC	