



Day & Co
ESTATE AGENTS

28 Cavendish Street
Keighley
BD21 3RG



21 Alma Street, Haworth,
Keighley, West Yorkshire, BD22
8HN

£145,000

T: 01535 664609

W: www.dayandcoestateagents.co.uk

E: keighley@dayandcoestateagents.co.uk

- STONE THROUGH TERRACE
 - ACCOMMODATION OVER 3 FLOORS
 - NO VENDOR CHAIN
- THREE BEDROOMS
 - POPULAR VILLAGE OF HAWORTH
 - EPC RATING D

SUMMARY

** STONE THROUGH TERRACE, THREE BEDROOMS, ACCOMMODATION OVER THREE FLOORS, GAS CENTRAL HEATING, DOUBLE GLAZING, YARD AREAS, POPULAR VILLAGE LOCATION OF HAWORTH, NO VENDOR CHAIN, EPC RATING D **

FULL DESCRIPTION

Offered for sale is this three bedroom through terrace situated in the sought after historic village of Haworth with excellent access to local schools. The three storey accommodation briefly comprises of a spacious lounge with double glazed window and door to the front. The kitchen requires updating however has a range of units with complimenting worktop surfaces, double glazed window and door to the rear. To the first floor the main bedroom has double glazed window to the front, spacious bathroom in need of updating comprising bath, WC, wash hand basin, double glazed window to the rear. To the second floor are two further bedrooms with roof windows. Gas Central Heating & Double Glazing. Externally the property has yard areas to the front and rear. Of interest to a variety of buyers, EPC Rating D.

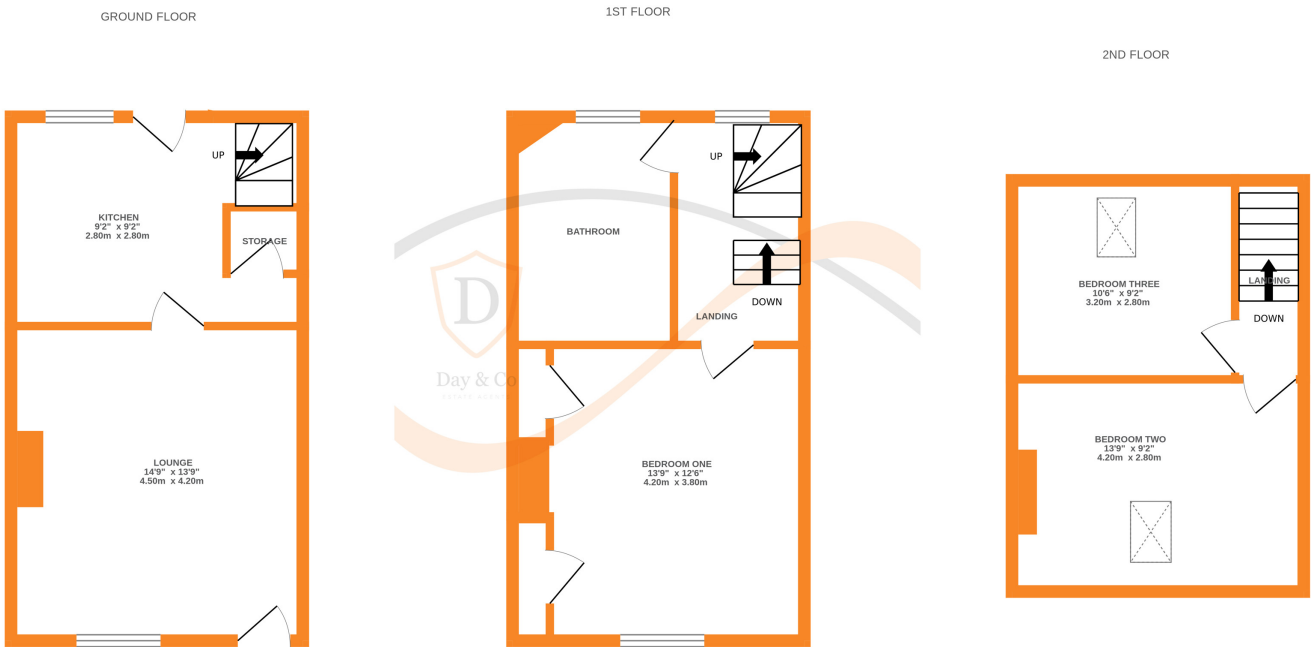

Whilst every attempt has been made to ensure the accuracy of the floorplan contained here, measurements of doors, windows, rooms and any other items are approximate and no responsibility is taken for any error, omission or mis-statement. This plan is for illustrative purposes only and should be used as such by any prospective purchaser. The services, systems and appliances shown have not been tested and no guarantee as to their operability or efficiency can be given.
Made with Metropix ©2025