



3 Mill Close, Stotfold, Hitchin, Bedfordshire, SG5 4AB

£550,000

Sought after four bedroomed detached in private cul-de-sac location within walking distance of the picturesque Stotfold Mill and surrounding open countryside. Well planned accommodation to include lounge with adjoining conservatory, separate dining room, refitted kitchen/Breakfast room with built in appliances and 4 generous bedrooms with en-suite to the master. Off road parking is provided by a double width driveway and garage and the enclosed rear garden has a patio area and useful workshop.



## 3 Mill Close Stotfold SG5 4AB

Approximate Gross Internal Area  
1324 sq ft - 123 sq m

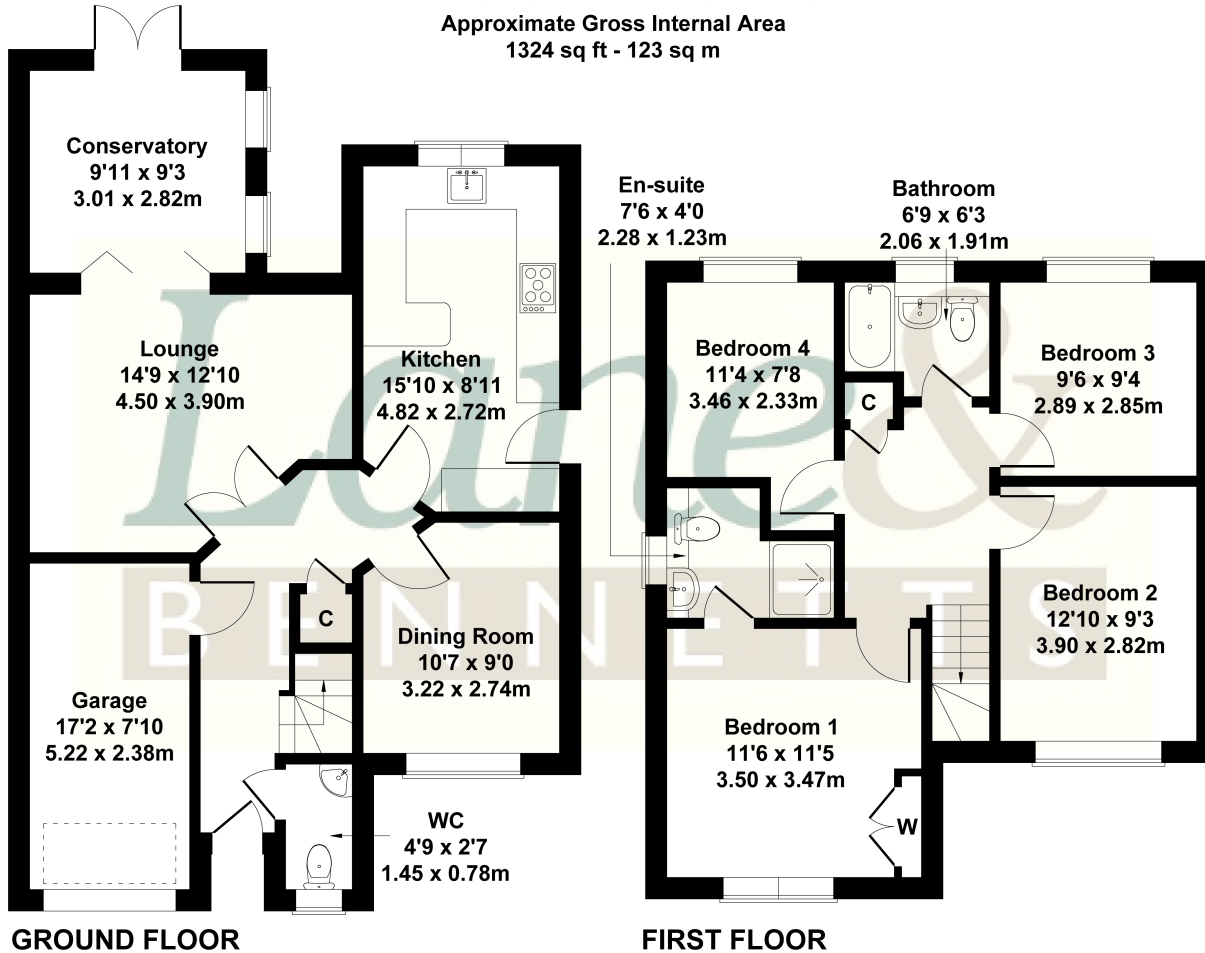

Not to Scale. Produced by The Plan Portal 2026  
For Illustrative Purposes Only.

- FOUR BEDROOM DETACHED FAMILY HOME
- LOUNGE & SEPARATE DINING ROOM
- RE-FITTED KITCHEN/BREAKFAST ROOM WITH BUILT IN APPLIANCES
- CONSERVATORY
- SOUGHT AFTER LOCATION WITHIN WALKING DISTANCE OF THE PICTURESQUE STOTFOLD MILL AND COUNTRYSIDE
- PRIVATE CUL-DE-SAC
- ENCLOSED REAR GARDEN WITH WORKSHOP
- DOUBLE WIDTH DRIVEWAY + GARAGE
- EASY ACCESS TO A1 & ARLESEY TRAIN STATION
- COUNCIL TAX BAND D / EPC

