



13 Stanley Road

Folkestone
CT19 4LQ

£240,000 FREEHOLD

Welcome to your future home on Stanley Road, where opportunity meets charm. This delightful two-bedroom mid-terrace house is brimming with potential and waiting for a new owner to infuse it with fresh ideas and some tender loving care. Perfectly positioned in a sought-after residential area known for its friendly community vibe, this property offers an ideal starting point for first-time buyers. Boasting no onward chain, the transition into your new home could be seamless and swift. The interior provides a blank canvas that promises endless possibilities — let your imagination transform this space into the cosy abode of your dreams. The generous rear garden not only hints at tranquil outdoor living but also presents scope for off-road parking, adding practicality to its list of attributes. This promising project invites you to create something truly special while investing in an area renowned for its robust appreciation potential. Don't miss out on this rare chance to craft a bespoke living experience tailored just for you. Embrace the journey towards homeownership on Stanley Road today!

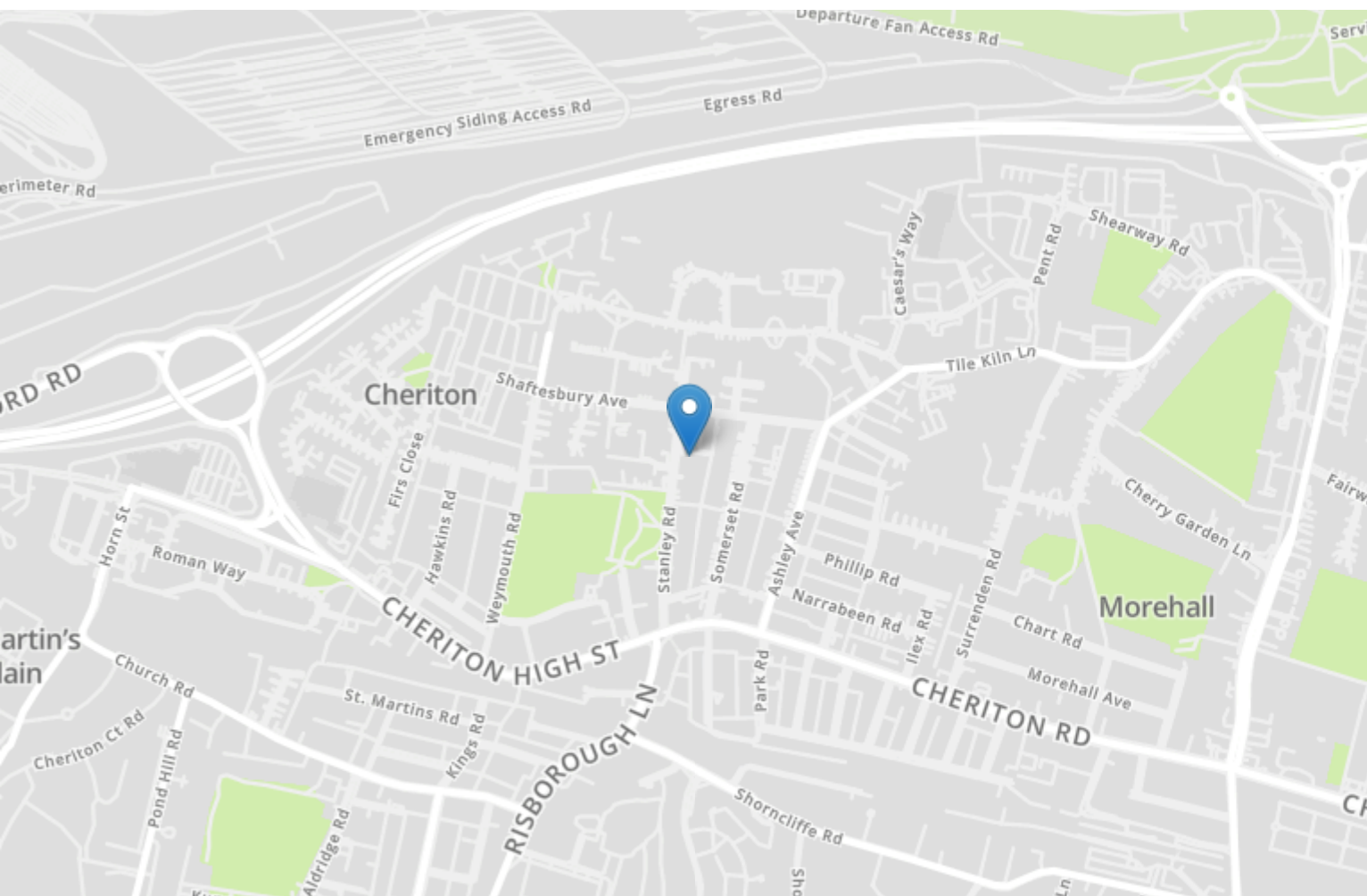

Porch

Lounge

12' 8" x 10' 5" (3.86m x 3.17m)

Dining Room

12' 6" x 10' 3" (3.81m x 3.12m)

Kitchen

11' 11" x 7' 0" (3.63m x 2.13m)

Shower Room

7' 9" x 8' 0" (2.36m x 2.44m)

Bedroom

12' 8" x 10' 3" (3.86m x 3.12m)

Bedroom

12' 8" x 10' 6" (3.86m x 3.20m)

Garden

Ground Floor
Approx. 43.8 sq. metres (471.5 sq. feet)

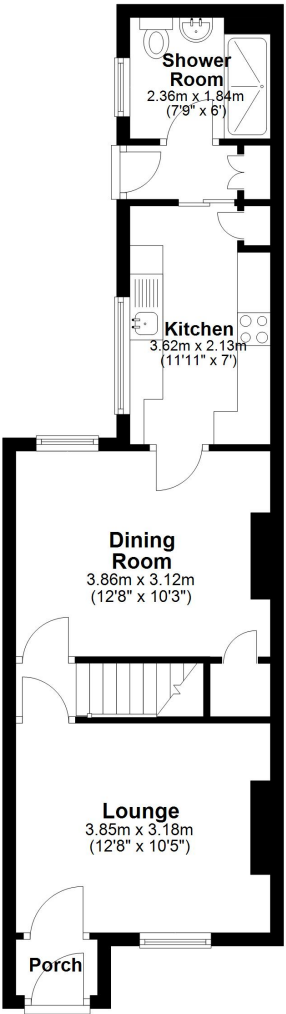

First Floor
Approx. 28.2 sq. metres (303.7 sq. feet)

