



Chestnut Grove, South Croydon, Surrey, CR2 7LL

£650,000 Freehold

- Charming 3-Bedroom Detached Bungalow
- Situated on Chestnut Grove, a quiet, leafy street just off the sought-after Croham Valley Road.
- Access to a great selection of well-regarded local and private schools.
- Quiet- peaceful setting
- Excellent local amenities
- Close proximity to outdoor spaces
- Spacious plot
- Nearby golf clubs
- Potential for expansion
- Chain - free

Southbridge Place, Croydon, Surrey, CR0 4HA

Tel: 0330 043 0002

Email: save@truuli.co.uk Web: www.truuli.co.uk

Chestnut Grove, South Croydon, Surrey, CR2 7LL

£650,000 Freehold

*****Guide Price £650,000- £700,000 ***Vendor comments*** "Our well-loved 3-bedroom detached bungalow has been our cherished home for 8 years, offering comfort, peace and lasting memories.

Our home is located in a quiet, leafy neighbourhood on Chestnut Grove, boasting a spacious plot with great potential for further extension, including a previously approved loft conversion. The integral garage also offers additional flexibility for expansion.

The property is ideally positioned near Little heath Woods and Vanguard Way, perfect for outdoor enthusiasts and has excellent local amenities, including Lidl, Sainsbury's and Waitrose.

The area offers fantastic schools and leisure options, including Croham Hurst Golf Club. Commuters benefit from quick access to South and East Croydon stations, with fast links to London and Gatwick.

This home combines immediate comfort with exciting potential, making it a rare find for someone looking to settle in a peaceful yet convenient location"

Chestnut Grove

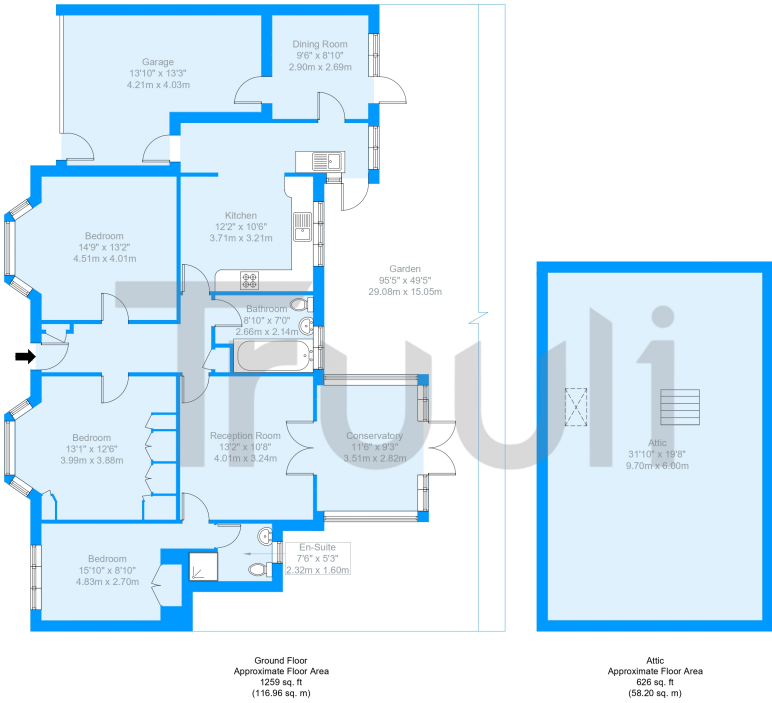

Approximate Gross Internal Area = 190.04 sq m / 2046 sq ft

