

24, Vermont Woods Wokingham RG40 4PF

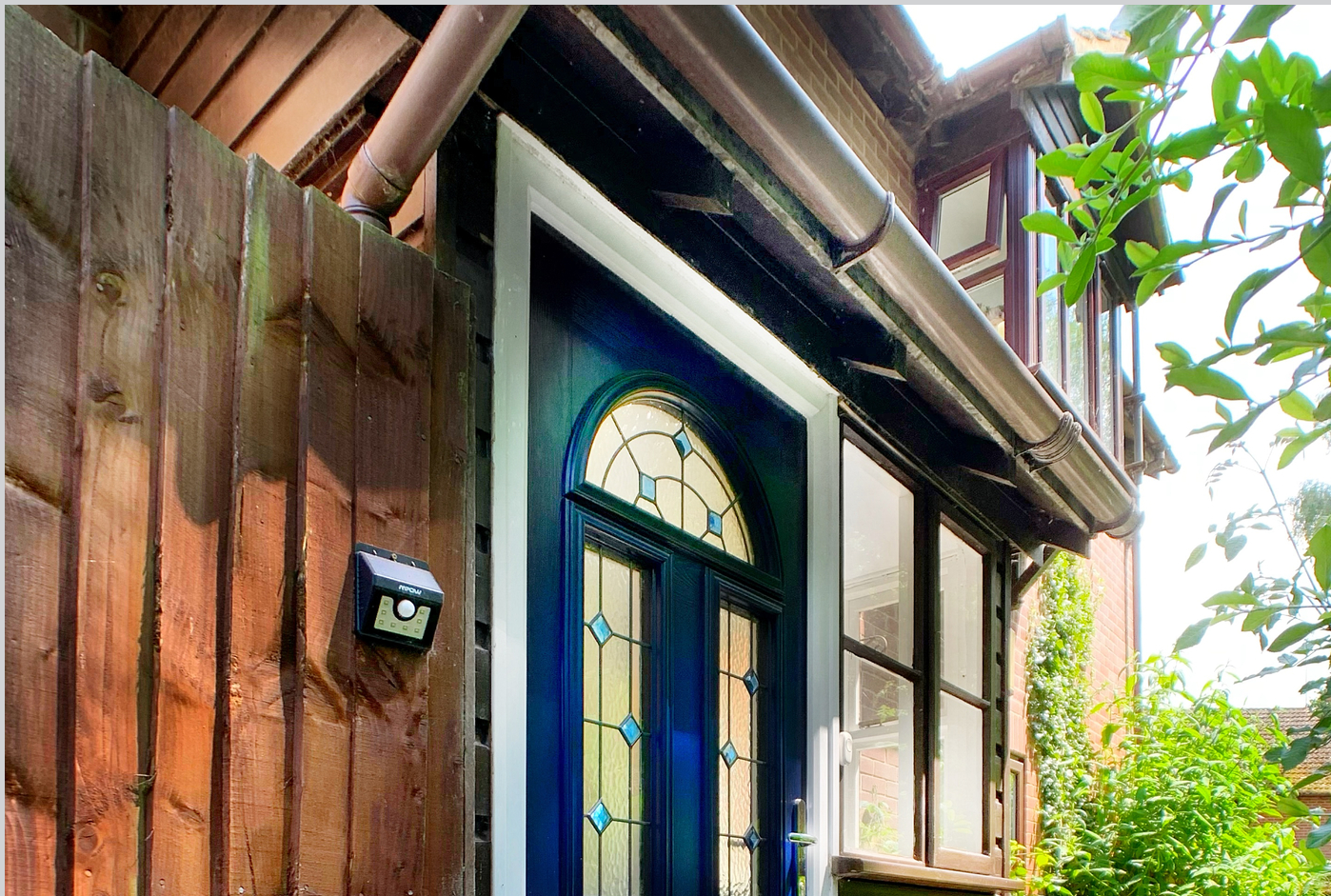

Situated in the popular area of Finchampstead this one bedroom house offers spacious open plan living space featuring a stylish contemporary kitchen and large living room with French doors opening onto its own private rear garden. To the first floor there is a generous sized double bedroom with fitted cupboard and a modern bathroom. The property is located immediately adjacent to the California Country Park with beautiful lake and woodland walks. The property benefits from an allocated parking space.

£230,000 Freehold





Energy Efficiency Rating		
	Current	Potential
Very energy efficient - lower running costs		
(92+) A		92
(81-91) B		
(69-80) C		
(55-68) D	55	
(39-54) E		
(21-38) F		
(1-20) G		
Not energy efficient - higher running costs		
England, Scotland & Wales		EU Directive 2002/91/EC

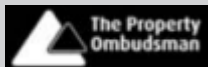
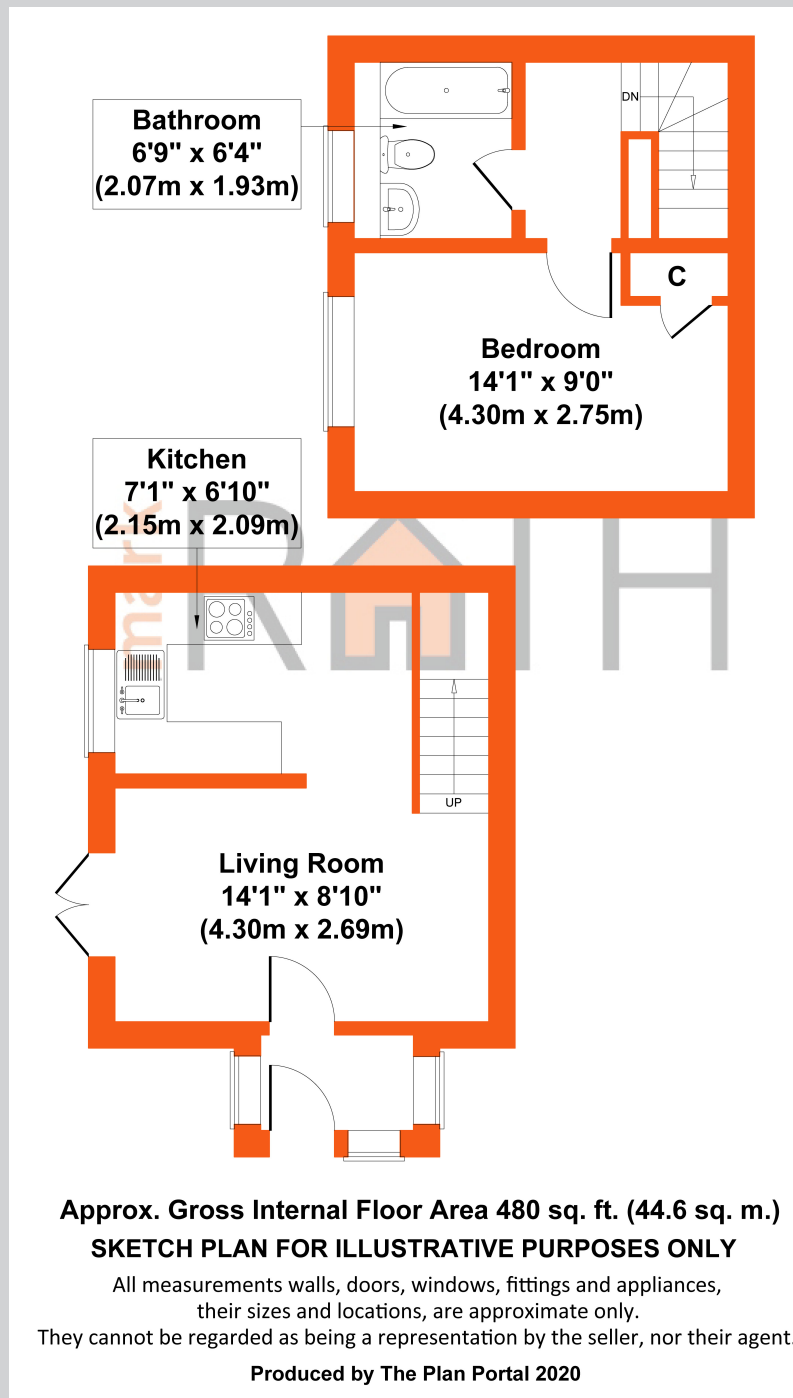

These particulars have been prepared in good faith to give a fair overall view of the property; they do not constitute an offer and will not form part of any contract. We make no representation about the conditions of the property nor that any services or appliances are in good working order; this should be checked by your surveyor. Furthermore, you should not assume that any items or features referred to in these particulars or shown in the photographs are included in the sale price. Your solicitor should check this as part of the normal conveyancing process.