



- Two Bedroom Terraced House
- Kitchen/Breakfast Room
- Presented To An Excellent Standard Throughout
- Two Allocated Parking Spaces
- Popular Marks Farm Development
- High Spec Spec Shower Room
- Ideal For First Time Buyers & Buy To Let Investors
- UPVC Windows & Gas Central Heating

28 Gulls Croft, Braintree, Essex. CM7 3RT.

Michaels Property Consultants are delighted to offer for sale this beautifully decorated and maintained home, located within a popular cul-de-sac location and having the added benefit of nearby local amenities. This highly popular area is often a first choice for prospective buyers due to its close proximity to popular schooling, local supermarkets, railway stations and main routes such as the A120. Internally the property has been decorated to a modern and high standard and comprises of a light and airy living room, kitchen/diner, two good sized bedrooms and a modern bathroom suite. Externally, the property is further enhanced by having an attractive and generous rear garden, as well as allocated parking to the front.



Property Details.

Ground Floor

Entrance Hall

Lounge



14' 8" x 9' 9" (4.47m x 2.97m)

Kitchen/Diner



13' 00" x 9' 2" (3.96m x 2.79m)

First Floor

Landing

Property Details.

Bedroom One



12' 8" x 12' 5" (3.86m x 3.78m)

Bedroom Two



11' 2" x 7' 10" (3.40m x 2.39m)

Shower-Room

Outside

Rear Garden



Two Allocated Parking Spaces

Property Details.

Floorplans

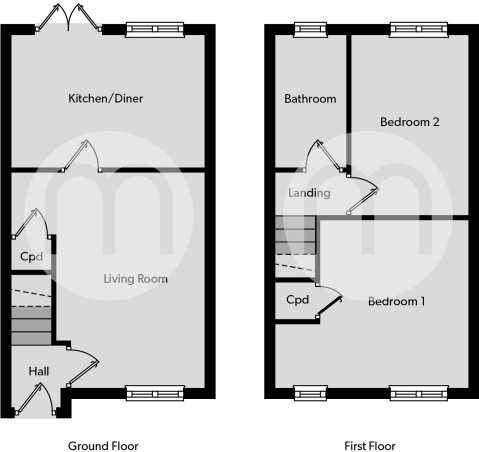

Location

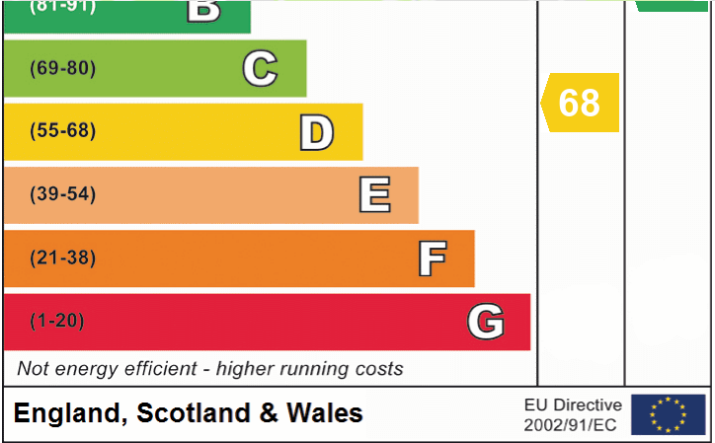

We have not carried out a structural survey and the services, appliances and specific fittings have not been tested. All photographs, measurements, floor plans and distances referred to are given as a guide only and should not be relied upon for the purchase of carpets or any other fixtures or fittings. Gardens, roof terraces, balconies and communal gardens as well as tenure and lease details cannot have their accuracy guaranteed for intending purchasers. Lease details, service ground rent (where applicable) are given as a guide only and should be checked and confirmed by your solicitor prior to exchange of contracts.