



Three Bedroom Terraced House
Conifer Drive, Chatham, Kent, ME5 8UU

Offers Over £300,000
Freehold

Conifer Drive, Chatham, Kent, ME5 8UU

Offers Over £300,000

Freehold

Description

Situated in the popular location of Lordswood and is great for local amenities and local schools. This three bedroom home has been beautifully maintained and presented throughout and is ready to move into. This will make an ideal first time buyers home or for the growing family. When entering this lovely home, you are welcomed to a spacious entrance hallway, with the benefit of downstairs cloakroom/ WC. Continuing through, you are welcomed to the heart of this home with an open plan Kitchen/ Diner which offers a modern fitted kitchen with a variety of fitted wall and base units and ample worksurfaces, offers a host of integrated appliances, to include dishwasher, tumble dryer/ washing machine, double oven and gas hob. The dining area is open plan to the lounge which is great when entertaining family and friends. Double French doors lead out onto the enclosed garden.

Moving upstairs you will not be disappointed with the three good size bedrooms it offers. Also a modern fitted bathroom and plenty of fitted cupboards. Externally, the property offers a low maintenance garden with patio area and artificial lawn. A great garden to chill and relax in.

Key Features

- Three Bedroom Terraced
- Excellent Order Throughout
- An Ideal First Time Buyers Home
- Popular Location in Lordswood
- Modern Fitted Kitchen
- Downstairs WC
- Spacious Living Accommodation
- Garden

Local Area

Lordswood is a suburb of Chatham, located approximately 3 miles outside of Chatham Town Centre. With local amenities including local shops, schools and a sports leisure centre. With frequent bus services in to the main town centres and mainline railway stations. For those who need to commute, the property is close to Kings Ferry commuter coach pick up points and both the M2/M20 motorways servicing the coast and London.

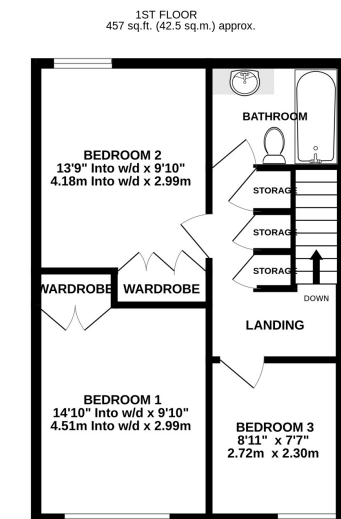
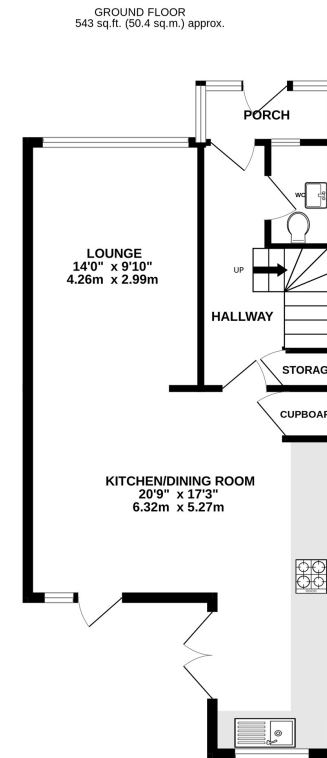

TOTAL FLOOR AREA : 1000 sq.ft. (92.9 sq.m.) approx.

Whilst every attempt has been made to ensure the accuracy of the floorplan contained here, measurements of doors, windows, rooms and any other items are approximate and no responsibility is taken for any error, omission or mis-statement. This plan is for illustrative purposes only and should be used as such by any prospective purchaser. The services, systems and appliances shown have not been tested and no guarantee as to their operability or efficiency can be given.
Made with Metropix ©2024



Property Location

Conifer Drive, Chatham, Kent, ME5 8UU

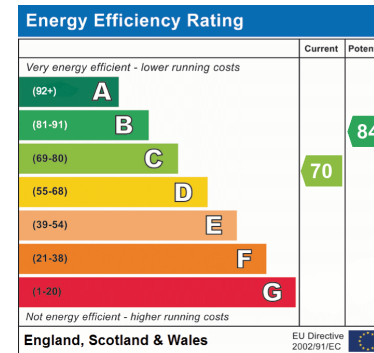
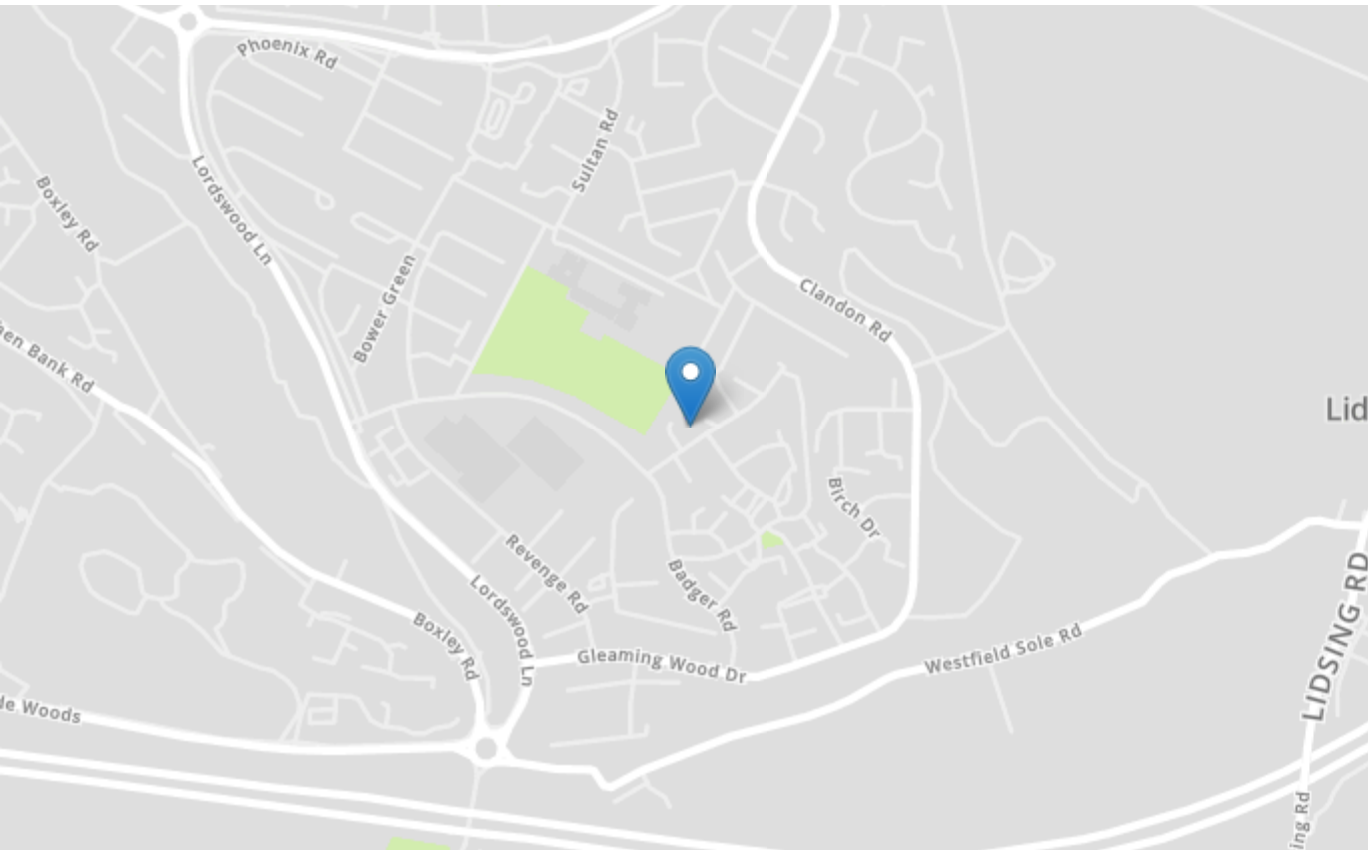

| | |
|------------------------|----------|
| Tenure | Freehold |
| Lease Term | N/A |
| Ground Rent | N/A |
| Service Charge | N/A |
| Local Authority | Medway |
| Council Tax | Band B |

Greyfox Walderslade

Unit 2, Thetford House
Walderslade Village Centre
Walderslade Road
Chatham
Kent
ME5 9LR
Tel: 01634 672227 Email:
walderslade@greyfox.co.uk

Greyfox Rainham

67C High Street
Rainham
Kent
ME8 7HS
Tel: 01634 377737 Email:
rainham@greyfox.co.uk

Agent Notes

These particulars are prepared as a general guide to a broad description of the property and should not be relied upon as a statement or representation of fact and do not constitute part of an offer or contract. The seller does not make or give nor do our employees or Greyfox have authority to make or give any representation or warranty to the property. We have not carried out a structural survey and the services, appliances and specific fittings have not been tested. All photographs, measurements, floorplans and distances referred to are given as a guide only and should not be relied upon for the purchase of carpets or any other fixtures or fittings. Lease details, service charges and ground rent (where applicable) and council tax are given as a guide only and should be checked and confirmed by you on inspection and your solicitor prior to exchange of contracts. If there are any points of particular importance to you we will be pleased to check the information for you and to confirm that the property remains available. This is particularly important should you be travelling some distance to view and where statements have been made by us to the effect that the information has not been verified. The copyright of all details, photographs and floorplans remain exclusive to Greyfox. For details of our privacy policy and referral fee arrangements with any of our selected partner companies please visit <https://www.greyfox.co.uk/legal/privacy> and <https://www.greyfox.co.uk/referral-fees>.