



T: 01909 509001  
E: [info@bartropanddilks.co.uk](mailto:info@bartropanddilks.co.uk)  
W: [www.bartropanddilks.co.uk](http://www.bartropanddilks.co.uk)  
A: 78 Bridge Street, Worksop, S80 1JA

SOLD STC

£230,000

6 Goransson Walk, Rhodesia, Worksop, Nottinghamshire. S80 3F5



Offered for sale with no chain being involved and set on the ever popular Dormer Woods estate is this well presented and decorated two bedroom link semi detached bungalow that has gas central heating and uPVC double glazed windows. Having a high standard of fixtures and fittings with an internal inspection being highly recommended, the property accommodation comprises of; entrance hallway, rear lounge with French doors to the rear garden, excellent fitted kitchen with modern units and integrated appliances, two bedrooms, bedroom one with fitted wardrobes to one wall, white fitted four piece bathroom suite. Outside; gardens to the front and rear, driveway and attached garage. Viewing Advised.

## Accommodation

### Entrance Hallway

With entrance door, central heating radiator, storage cupboard.

### Lounge 4.24m x 3.04m (13' 11" x 10' 0")

With rear facing French doors, central heating radiator.

### Kitchen 3.14m x 3.14m (10' 4" x 10' 4")

With an excellent range of fitted wall and base units, worksurfaces, sink unit with mixer tap, rear facing window, central heating radiator, integrated fridge, freezer, washer dryer, dishwasher, electric hob with extractor and electric oven.

### Bedroom One 3.45m x 2.64m (11' 4" x 8' 8")

With fitted wardrobes to one wall, front facing window, central heating radiator.

### Bedroom Two 3.19m x 2.27m (10' 6" x 7' 5")

With a front facing window, central heating radiator.

### Bathroom

Delightful modern four piece suite that comprises of; shower cubicle and mains shower unit, wash hand basin, panelled bath, low flush w.c, tiled floor, tiling to splashback, heated towel rail, extractor fan.

## Outside

### Gardens

Front and rear lawned gardens. The rear being enclosed with patio.

### Driveway

### Attached Garage





GROUND FLOOR

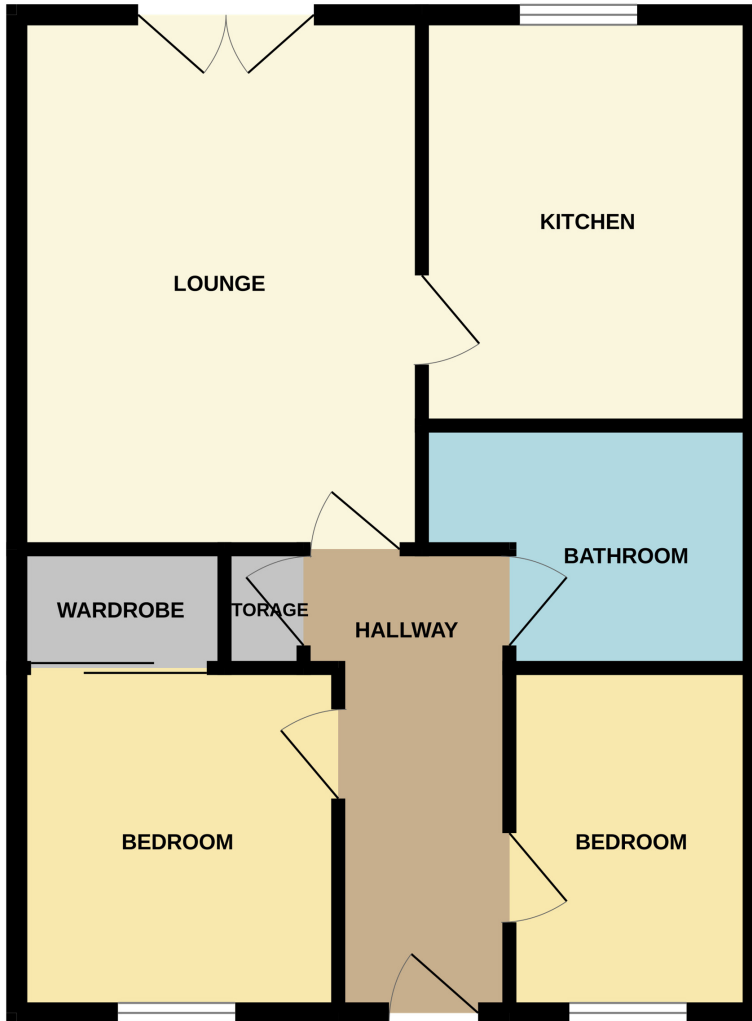

Whilst every attempt has been made to ensure the accuracy of the floorplan contained here, measurements of doors, windows, rooms and any other items are approximate and no responsibility is taken for any error, omission or mis-statement. This plan is for illustrative purposes only and should be used as such by any prospective purchaser. The services, systems and appliances shown have not been tested and no guarantee as to their operability or efficiency can be given.  
Made with Metropix ©2024

