



T: 0151 625 0125
E: info@homewirral.co.uk
W: www.homewirral.co.uk
A: 42 Grange Road, West Kirby, CH48 4EF

FOR SALE

£375,000

Ashdale Park, Greasby, Wirral. CH49 3GT



Detached bungalow with views! Situated on the ever popular Ashdale Park in Greasby is this immaculate, three bedroom detached bungalow. Ticking every box for a buyer looking to downsize, the property boasts spacious living accommodation, a master bedroom en-suite and beautiful views over the fields from the rear. With local amenities nearby, you also benefit from great transport links and reputable schools. This is not one to be missed.





GROUND FLOOR
1307 sq.ft. (121.5 sq.m.) approx.

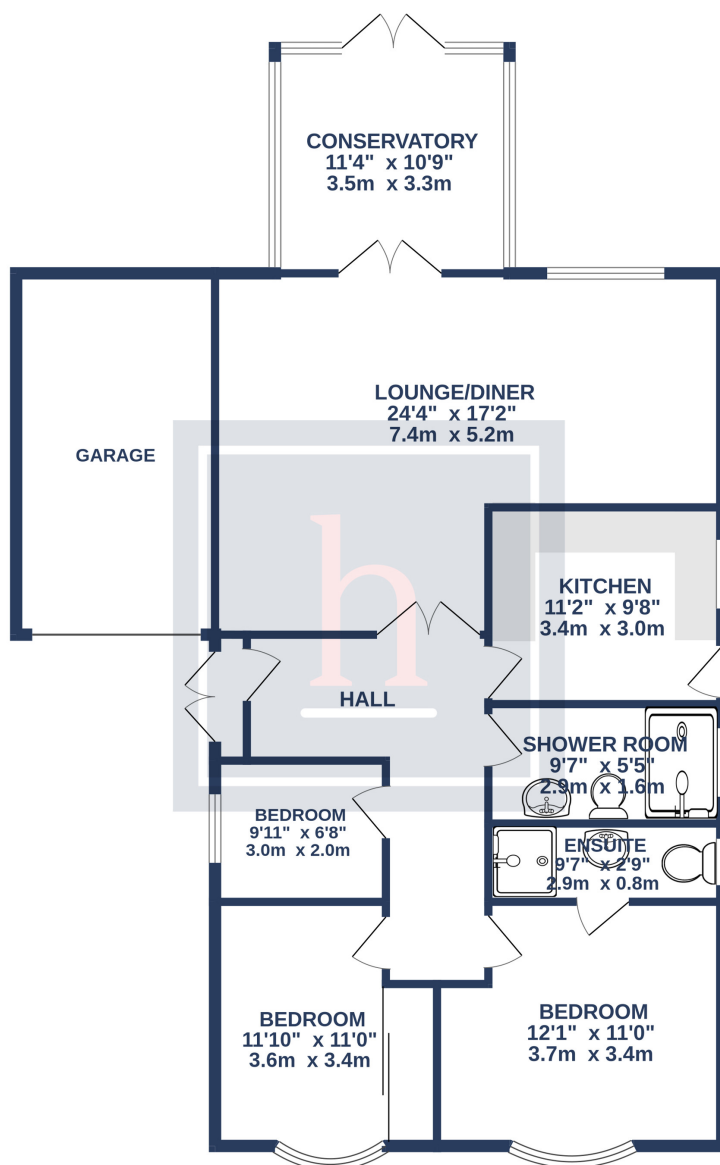

TOTAL FLOOR AREA: 1307 sq.ft. (121.5 sq.m.) approx.

Whilst every attempt has been made to ensure the accuracy of the floorplan contained here, measurements of doors, windows, rooms and any other items are approximate and no responsibility is taken for any error, omission or mis-statement. This plan is for illustrative purposes only and should be used as such by any prospective purchaser. The services, systems and appliances shown have not been tested and no guarantee as to their operability or efficiency can be given.
Made with Metropix ©2025