



## 1 Glamis Avenue, Glenrothes, Fife, KY7 4NU

Beautifully Presented and Exceptionally Spacious, Four-Bedroom, Detached Bungalow

Up to date price and viewing info at [mov8realestate.com/property](https://mov8realestate.com/property)

és pc rightmove<sup>®</sup> find your happy Zoopla



# Property Description

Beautifully presented and exceptionally spacious, four-bedroom detached bungalow, with gardens and a multi-vehicle driveway. Situated in the well-established and popular town of Glenrothes, Fife.

Comprises an entrance hall, lounge/diner, kitchen, utility room, four double bedrooms, an en-suite and a family bathroom.

An exceptional family home, with contemporary decor throughout, updated kitchen and bathroom, and plenty of storage provision.

Additional features include a comprehensive selection of integrated kitchen and utility appliances, double glazing throughout, and efficient gas central heating. In addition, there is a wood-burning stove for the lounge/diner and spotlighting in the master bedroom.

Externally, the spacious rear garden boasts a generous patio and storage shed.

Beautifully presented and exceptionally spacious, four-bedroom detached bungalow, with gardens and a multi-vehicle driveway. A bright and welcoming entrance hall provides access to all rooms throughout this beautifully presented property. The generously sized principal bedroom features attractive wood-effect flooring, modern spotlighting, and offers a peaceful retreat. This room is further enhanced by a stylish, contemporary en-suite shower room with high-quality fittings. To the rear of the property, a convenient utility room adds to the home's practical appeal. The modern, open-plan kitchen is designed for both style and functionality, boasting tiled-effect flooring, solid wood worktops, sleek spotlighting, and a black composite sink with a drainer. Integrated appliances include an oven, microwave, and gas hob, ideal for everyday cooking and entertaining. The spacious lounge/diner is bathed in natural light from multiple windows and striking French patio doors, which lead out to the rear garden. This inviting living area also features wood-effect flooring, a wall-mounted TV point, and a charming log burner, adding warmth and character to the space.

Down the hallway and set to the front of the property, three further well-proportioned bedrooms are included, each benefiting from attractive hardwood flooring and light, neutral décor. These rooms offer excellent flexibility for use as guest bedrooms, home offices, or family accommodation. Completing the home, a modern three-piece bathroom includes tiled-effect flooring, a tiled splashback surround, stylish spotlighting, and a ladder-style heated towel rail.



**1 Glamis Avenue, Glenrothes, KY7 4NU**

Approximate Gross Internal Area: (1550 sq ft - 144 sq m.)

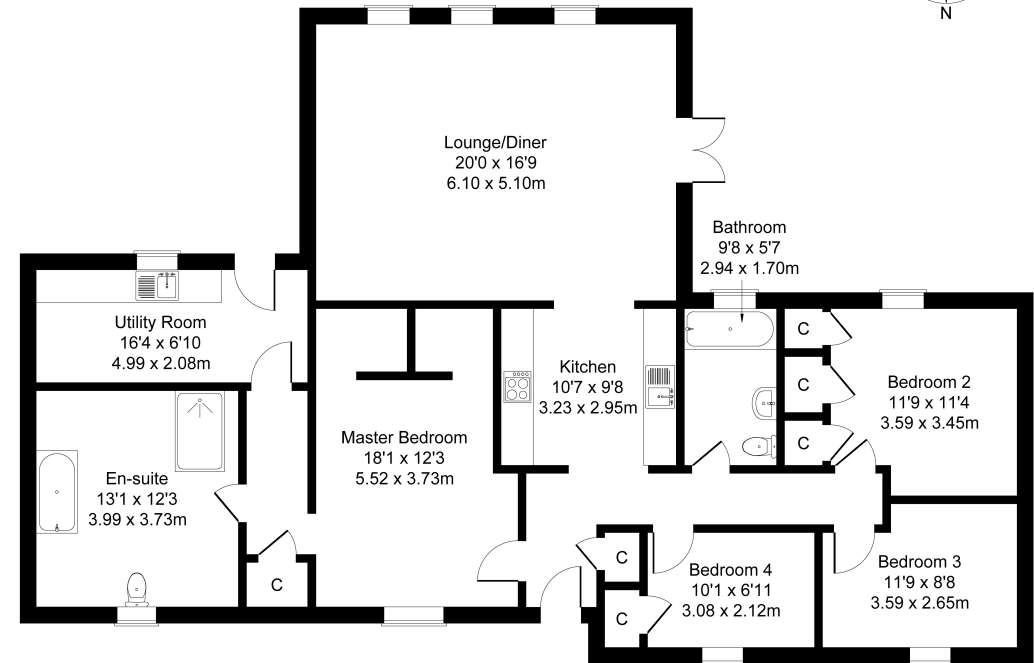
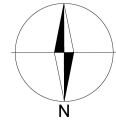

Legal Disclaimer : Floor-plan and measurements are for illustrative guidance only, and not intended to form part of any contract.

## Area Description

Glenrothes is Fife's third largest town offering a wide range of residential properties throughout. Shopping options include the Kingdom Shopping Centre with many popular high-street retailers and supermarkets such as Asda, Aldi, Lidl and Marks and Spencer. The Michael Woods Centre provides extensive modern sports and leisure facilities, and Glenrothes is also home to an eighteen hole golf course, a





cinema and a theatre within the Rothes Halls. The town has well established primary and secondary schools, with further education available at The Adam Smith College located on the Stenton campus of Fife College. For commuters, the A92 provides quick access to Edinburgh and the central belt, and railway stations are available at both Thornton and Markinch.







## Our Services

-  Free pre-sale property valuations
-  Great value fixed estate agency fees
-  Extensive buyer matching database
-  Purchase and sale conveyancing

## Contact Us

0345 646 0208

[sales@mov8realestate.com](mailto:sales@mov8realestate.com)

[www.mov8.com](http://www.mov8.com)

## Head Office

6 Redheughs Rigg, Edinburgh, EH12 9DQ

## Glasgow Office

77 Renfrew Street, Glasgow, G2 3BZ



Estate Agents and Solicitors



These particulars do not form part of any contract and the statements or plans contained herein are not warranted nor are they to scale. All descriptions, dimensions, areas, reference to condition and necessary permissions for use and occupation and other details are given in good faith, and are believed to be correct, but any prospective purchaser should not rely on them as statements or representations of fact, and any prospective purchaser must satisfy themselves by inspection or otherwise as to the correctness of each of them. The Seller shall not be bound to accept the highest or any offer nor to accept a full offer of the Fixed Price where this is applicable. Approximate measurements have been taken by sonic device and measurements are most often taken to the widest point of any room or space. Services and appliances have not been tested for efficiency or safety and no warranty is given as to their compliance with any Regulations. Offers should be made using the Combined Standard Clauses.