

**Flat 8 Summerfield House, La Route de la Baie, St Brelade,
Jersey, Channel Islands. JE3 8EF**

£850,000 Flying Freehold

FOR SALE



PROPERTY DESCRIPTION

Situated in the highly sought-after Summerfield House complex in the heart of St Brelade's Bay, this beautiful ground-floor apartment offers an enviable lifestyle with the beach, an array of restaurants, and premier leisure and spa facilities right at your doorstep. Spanning 1,096 sq. ft., the apartment is elegantly designed, featuring a spacious living and dining area with double doors that open onto a private patio, overlooking tranquil communal gardens. It comprises two double bedrooms, with the master enjoying an en-suite bathroom and bespoke fitted wardrobes, as well as an additional house bathroom. Complete with two secure underground parking spaces and a private storage room, this apartment is ideal for downsizers or anyone looking to embrace refined seaside living in one of the island's most prestigious areas.

FEATURES

- St Brelade's Bay 2bed 2bath ground floor patio apartment
- Just steps from Jersey's No1 beach
- 2 undercover parking spaces & storeroom
- Double doors to patio & communal garden
- Restaurants, leisure & spa facilities on doorstep
- Sole agency, no onward chain



ROOM DESCRIPTIONS

Service Charge

£330pcm to include lift service, water, gardening etc.

Services

All main services (except Gas).

Wet electric central heating.

Lift access.







FLOORPLAN

GROUND FLOOR
1096 sq.ft. (101.8 sq.m.) approx.

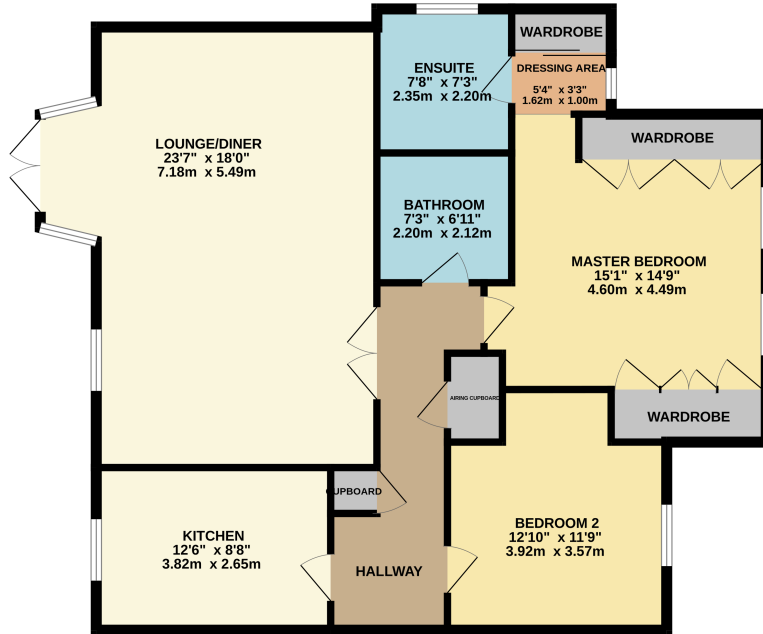

TOTAL FLOOR AREA - 1096 sq.ft. (101.8 sq.m.) approx.

Whilst every attempt has been made to ensure the accuracy of the floorplan contained here, measurements of floors, windows, rooms and any other items are approximate and no responsibility is taken for any error, omission or mis-statement. This plan is for illustrative purposes only and should be used as such by any prospective purchaser. The services, systems and appliances shown have not been tested and no guarantee as to their operability or efficiency can be given.
Made with Metropix 10/04