



25 Meadow Walk, Henlow, Bedfordshire, SG16 6HJ

Offers Over £350,000

Modern three-bedroom terraced home situated in a popular development overlooking a small green. The accommodation includes a spacious lounge, fitted kitchen/diner with bay window, downstairs cloakroom, master bedroom with en-suite, two further bedrooms and a family bathroom. Outside there is an enclosed rear garden with off road parking provided via a garage and two allocated parking spaces located behind the property. The property is also within walking distance of Arlesey station, Henlow schools, pubs, shops and other local amenities.

*Lane &*  
BENNETTS



- MODERN THREE BEDROOM TERRACED HOME
- SITUATED IN A POPULAR DEVELOPMENT
- OVERLOOKING A SMALL GREEN
- FITTED KITCHEN/DINER WITH BAY WINDOW
- SPACIOUS LOUNGE
- MASTER BEDROOM WITH EN-SUITE
- FAMILY BATHROOM & CLOAKROOM
- GARAGE & 2 ALLOCATED PARKING SPACES
- WALKING DISTANCE TO STATION, SCHOOLS & SHOPS
- COUNCIL TAX D / EPC C

Approximate Gross Internal Area  
 Ground Floor = 39.3 sq m / 423 sq ft  
 First Floor = 37.5 sq m / 404 sq ft  
 Garage = 17.4 sq m / 187 sq ft  
 Total = 94.2 sq m / 1,014 sq ft



**Ground Floor**

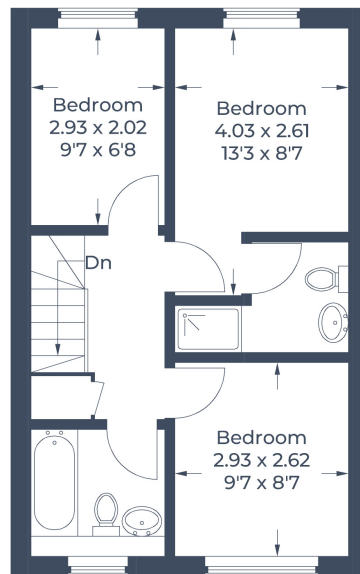

**First Floor**

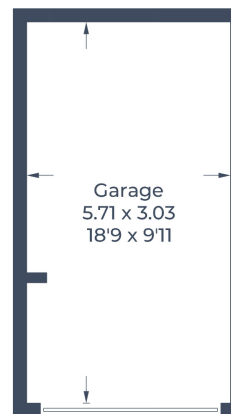

(Not Shown In Actual  
Location / Orientation)

Illustration for identification purposes only,  
 measurements are approximate, not to scale.  
 © CJ Property Marketing Produced for Lane & Bennetts

