



## *Norlands Park, Widnes. WA8. Offers in Excess of £600,000*

Executive 5 Bed Detached Home | Double garage | Open plan kitchen and family room | Popular location |



GROUND FLOOR  
1526 sq.ft. (141.8 sq.m.) approx.

1ST FLOOR  
932 sq.ft. (86.6 sq.m.) approx.

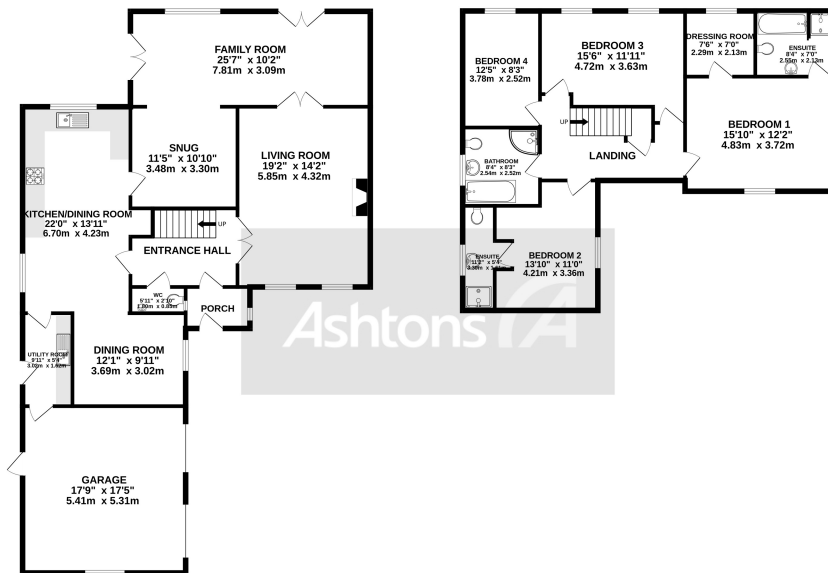

TOTAL FLOOR AREA: 2458 sq.ft. (228.4 sq.m.) approx.  
 Whilst every attempt has been made to ensure the accuracy of the floorplan contained herein, measurements of doors, windows, rooms and any other items are approximate and no responsibility is taken for any error, omission or mis-statement. This plan is for illustrative purposes only and should be used as such by any prospective purchaser. The services, systems and appliances shown have not been tested and no guarantee as to their operability or efficiency can be given.  
 Made with Metropix ©2023

Welcome to this stunning 5 bedroom executive detached family home situated in one of the area's most popular locations. The elegant property boasts modern amenities, stylish features and a beautiful landscaped garden.

The open plan kitchen is designed to impress, featuring modern appliances and a breakfast bar. It is perfect for entertaining friends and family, or simply enjoying a cup of coffee or delicious meal and is the hub of the home and benefits further from a separate utility room which is conveniently located making it easy to keep the house organized and clean.



Contact your local office to arrange a viewing:

- Padgate: 01925 479334
- Great Sankey: 01925 454300
- Winwick: 01925 232146
- Stockton Heath: 01925 453400
- St.Helens: 01744 754120
- Wigan: 01942 498862
- Culcheth: 01925 764744
- Ashton-In-Makerfield: 01942 364446
- Newton-Le-Willows: 01925 907770
- Commercial Office: 01925 907709
- Lettings Head Office: 01925 873533
- Financial Services: 01925 221234

**Viewing Arrangements**

Viewing is strictly by appointment only through Ashtons Estate Agency.

**Disclaimer Property Details**

These particulars, whilst being believed to be accurate are set out as a general outline only for guidance and do not constitute any part of an offer or contract. Intending purchasers should not rely on them as statements of representation of fact, but must satisfy themselves by inspection or otherwise as to their accuracy. We have not carried out a detailed survey nor tested the services, appliances and specific furnishings. The measurements given are approximate. No person in this firm's employment has the authority to make or give any representation or warranty in respect of the property.

All details, photographs and floorplans are the copyright of Ashtons Estate Agency.



How much you can borrow?  
 Speak to a mortgage expert in your local office.

Ashtons Financial Services

Ashtons.net rightmove

PrimeLocation.com Zoopla.co.uk

