



10 Woodland Rise, Bexhill-on-Sea, East Sussex
, TN40 1TD

£399,950



- Extended Four Bed Detached Bungalow
- Large Extended Lounge-Diner
- Modern Fitted Kitchen & Bathroom
- Master Bedroom With En-Suite
- Four Good Size Bedrooms
- Separate Modern Family Bathroom
- Open Plan Kitchen Area
- Well Presented Decor Throughout
- Sth Facing Garden Additional Side Plot
- Central Heated & Double Glazed
- Ample Off Road Parking
- Sought After Penland Wood Location
- Close To Ravenside Retail Shops
- Quiet & Convenient Location
- Additional Side Plot With Great Potential
- Viewing Highly Recommended
- Call Our Bexhill Team On 01424 224488



GROUND FLOOR
1161 sq.ft. (107.8 sq.m.) approx.

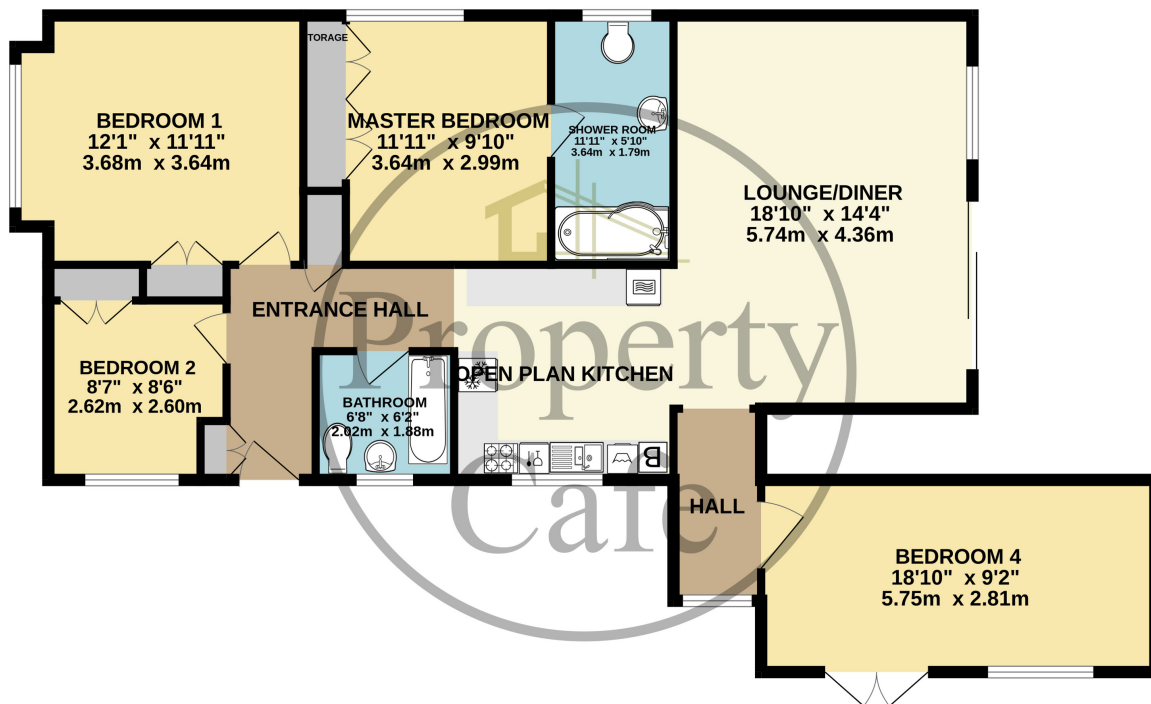

TOTAL FLOOR AREA : 1161 sq.ft. (107.8 sq.m.) approx.

Whilst every attempt has been made to ensure the accuracy of the floorplan contained here, measurements of doors, windows, rooms and any other items are approximate and no responsibility is taken for any error, omission or mis-statement. This plan is for illustrative purposes only and should be used as such by any prospective purchaser. The services, systems and appliances shown have not been tested and no guarantee as to their operability or efficiency can be given.
 Made with Metroplex ©2023

