

Hautmont Close 1 The Mews, Mont Millais, St Helier. JE2 4XT

£595,000 Flying Freehold

SOLD STC



PROPERTY DESCRIPTION

Presenting a rare opportunity for younger house buyers and first-time buyers to secure an immaculate town house in the sought-after location of Mont Millas. This spacious end of terrace mews house, constructed in 2003, exudes modernity and convenience. Situated on the outskirts of town, this property boasts stunning views over St

Helier, offering a tranquil and peaceful setting. With 2 double bedrooms spread over 4 floors, this recently modernised property is presented in excellent condition, allowing you to move in straight away. Ideal for those prioritising education, this townhouse is conveniently located near Jersey College for girls, Victoria College for boys, Beaulieu, and De La Salle. Local shops are just a short 10-minute walk away, with the vibrant centre of St Helier within 15 minutes on foot. Featuring a separate utility room, two parking spaces, and a single integral garage, this property offers ample space for young families or professionals looking for a stylish and comfortable living space. The property also benefits from driveway parking for 2 cars plus an integral garage. Don't miss the opportunity to view this exceptional property, showcasing modern amenities and stylish finishes. Contact us today to schedule a viewing and make this townhouse your dream home. A perfect opportunity for young buyers to step onto the property ladder.

FEATURES

- Modernised 2 bedroom 2 bathroom town house
- Quiet residential area yet close to town
- Integral garage and 2 designated parking spaces
- 1265ft2 over 4 floors
- Light and bright interior, great views over town
- Separate utility, plentiful storage



ROOM DESCRIPTIONS

Service charges

Service charges are £190 per month.

New fuse board, new Comfort electric storage heating.

Mains drains and water.

Directions

Heading up Mont Millais pass Victoria College and Langford Sports Centre, immediately opposite JCG turn left into Hautmont, pass the Hautmont House, No1 The Mews is the 1st property on the RHS park on the opposite side.

What3Words: <https://w3w.co/photo.object.embarks>







FLOORPLAN

GROUND FLOOR
329 sq.ft. (30.5 sq.m.) approx.

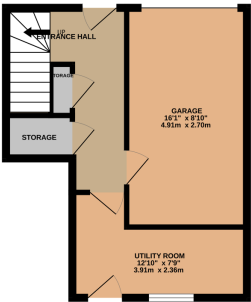

1ST FLOOR
336 sq.ft. (31.3 sq.m.) approx.

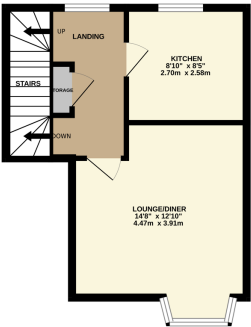

2ND FLOOR
336 sq.ft. (31.3 sq.m.) approx.

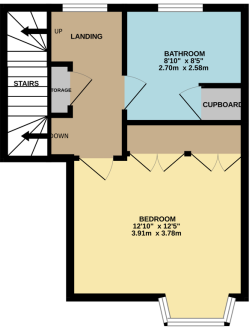

3RD FLOOR
264 sq.ft. (24.5 sq.m.) approx.

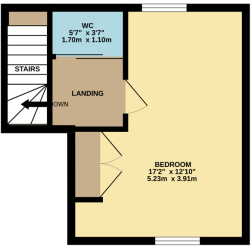

TOTAL FLOOR AREA : 1265 sq.ft. (117.5 sq.m.) approx.

Whilst every attempt has been made to ensure the accuracy of the floorplan contained here, measurements of doors, windows, rooms and any other items are approximate and no responsibility is taken for any error, omission or mis-statement. This plan is for illustrative purposes only and should be used as such by any prospective purchaser. The services, systems and appliances shown have not been tested and no guarantee as to their operability or efficiency can be given.
Made with Metropix ©2025